

1 2 3 4 5 6 7 8

REV	LOCATIONS	DESCRIPTION	DATE	REVISER	APPD

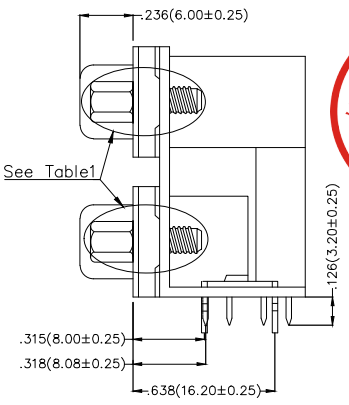
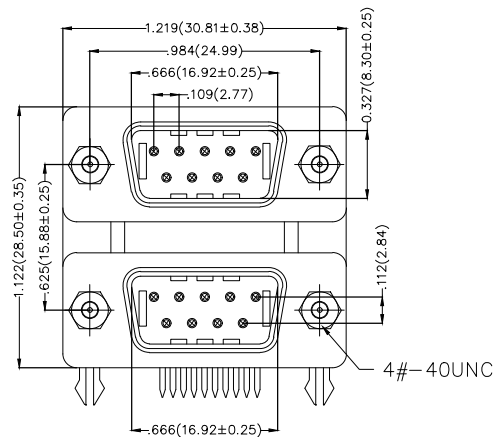
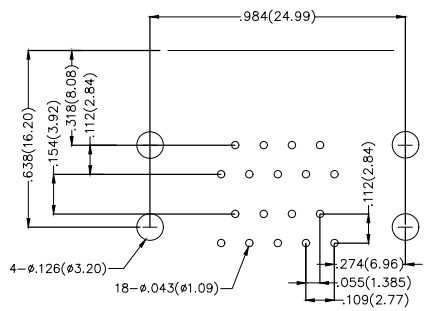
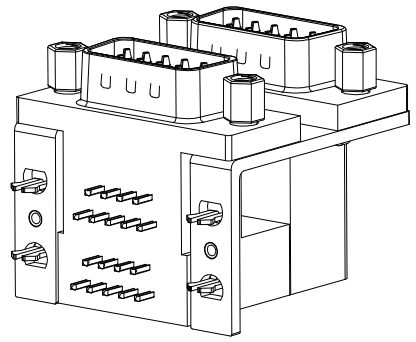
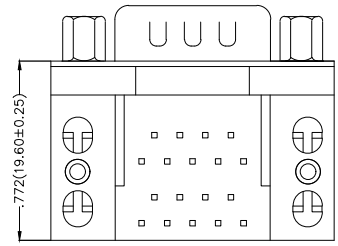

Table 1

Part No.:FDB1805-MMDB3XXXXXA A Type	Part No.:FDB1805-MMDB3XXXXXB B Type
Part No.:FDB1805-MMDB3XXXXXC C Type	Screws 187(4.75) .465(11.80) .189(4.80)



Recommended P.C.Board Layout

Ordering Information

FDB 18 05 - MM D B 3 XX XX K X
1 2 3 4 5 6 7 8 9 10 11

SPECIFICATIONS

- Electrical
- Current Rating: 3A AC(rms)/DC
 - Voltage Rating: 250V AC(rms)/DC
 - Contact Resistance: 25 mΩ Max
 - Insulation Resistance: 1000 MΩ MIN
 - Withstanding Voltage: 500V AC r.m.s
 - Temperature Range-Operating: -55°C~+105°C



- Material and Finish
- Housing: PBT UL 94V-0
 - Contact: Copper Alloy/Gold Flash Plated On Contact Area Tin Plated On Solderails, Nickel Under Plated Over All/Gold Plated Options
 - Shell: Spcc/Nickel Plated Over All
 - Board Lock: Copper Alloy/Tin Plated Over All
 - Screws: Copper Alloy/Nickel Plated Over All

1 Category FDB- D-SUB	2 Circuits 18	3 Distinction No. 05	4 Type MM- Male+Male	5 Assembly Layout D-DIP	6 Entry Angle B-90° Angle
7 Plating 3-Half Gold/Tin	8 Thickness of Gold Plating 00-Gold Flash 03-3u" Custom Plate Available	9 Color-Resin K6-Black U1-Blue	10 Packaging K-Tray	11 Products Categories A-A Type B-B Type C-C Type	

THIRD ANGLE PROJECTION	GENERAL TOLERANCES (UNLESS SPECIFIED)		APPROVE BY FRANK	DATE 28/JUN/13	PART NO. FDB1805-MMDB3XXXXKX	ITEM NO. FDB1805	 3K-KAMING REV 0 SHEET NO. 1/1
	DESIGN UNITS Inch (metric)	X.±.012(0.30) X.X±.008(0.20) X.XX±.006(0.15) X.XXX±.004(0.10)	X.±5' .X'±2' .XX'±1' .XXX'±0.5'	CHECKED BY JACOB	DATE 28/JUN/13	TITLE D-SUB 9PIN MALE+9PIN MALE CONN	
SCALE 5:1	SIZE A4		DRAWN BY CHERRY	DATE 28/JUN/13	THIS DRAWING CONTAINS INFORMATION THAT IS PROPRIETARY TO DONG GUAN LANG LUN(3K-KAMING) ELECTRONIC PRODUCTS CO., LTD. AND SHOULD NOT BE USED WITHOUT WRITTEN PERMISSION		

1 2 3 4 5 6 7 8