

REV	LOCATIONS	DESCRIPTION	DATE	REVISER	APPD
1	△	Size changes	29/MAY/20	KATE	CHERRY



SPECIFICATIONS

Electrical

Current Rating: 3A AC(rms)/DC
Voltage Rating: 250V AC(rms)/DC
Contact Resistance: 20 mΩ Max
Insulation Resistance: 1000 MΩ MIN
Withstanding Voltage: 500V AC r.m.s
Temperature Range-Operating: -40°C~+105°C

Material and Plating

Housing: PA6T (UL 94V-0)
Contact Pin: Brass
Plating: Gold Plated/Selective gold in contact area, tin on tail

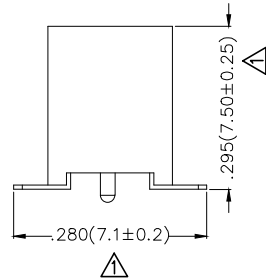
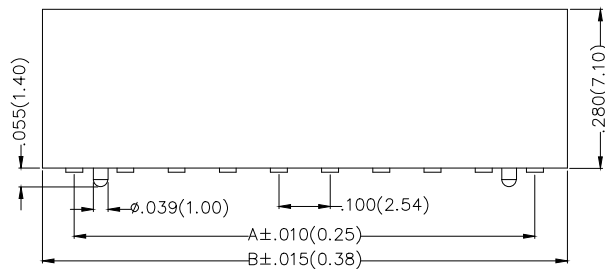
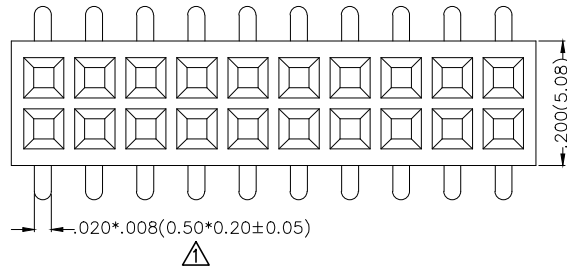

Packing: M-Reel(With Cap)

Packing: M1-Reel(With Mylar)

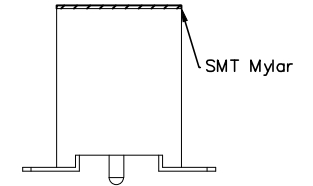
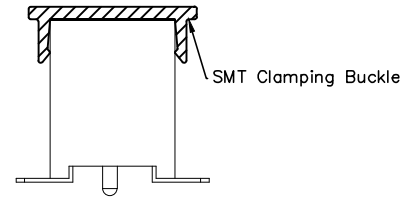

Ordering Information

FFH 254 19 - D XX S X XX 4 K6 XX
1 2 3 4 5 6 7 8 9 10 11

1	Category FFH-Female Header	2	Series Number 254-Pitch2.54mm	3	Distinction No. 19	4	Row Option D-Double Row	5	Circuits XX	6	Entry Angle S-180° Vertical
7	Plating 1-Gold Plated 3-Selective gold in contact area, tin on tail	8	Thickness of Plating 00-Gold Plated 01-1μ" 05-5μ" Custom plate available	9	Material-Resin 4-PA6T	10	Color-Resin K6-Black	11	Packaging M-Reel(With Cap) M1-Reel(With Mylar)		

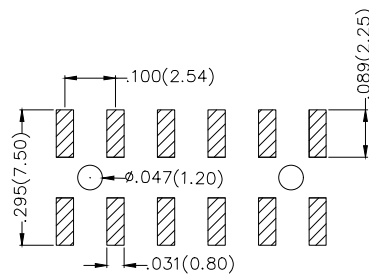

Recommended P.C.Board Layout

THIRD ANGLE PROJECTION		GENERAL TOLERANCES (UNLESS SPECIFIED)		APPROVE BY	DATE	PART NO.	ITEM NO.	3K-KAMI NG	
DESIGN UNITS Inch (metric)	X.±.012(0.30)	X'.±5'	CHECKED BY	FRANK	12/AUG/13	FFH25419-DXXSXXX4K6XX	FFH25419	REV 1	SHEET NO. 1/2
	X.X±.008(0.20)	.X'±2'	CHECKED BY	CHERRY	12/AUG/13	TITLE Board to Board (Female Header) Pitch 2.54mm 180° Vertical (SMT)			
SCALE	X.XX±.006(0.15)	.XX'±1'	DRAWN BY	JACOB	DATE	THIS DRAWING CONTAINS INFORMATION THAT IS PROPRIETARY TO DONG GUAN LANG LUN(3K-KAMI NG) ELECTRONIC PRODUCTS CO.,LTD. AND SHOULD NOT BE USED WITHOUT WRITTEN PERMISSION			
5:1	X.XXX±.004(0.10)	.XXX'±0.5'							



REV	LOCATIONS	DESCRIPTION	DATE	REVISER	APPD

Circuits (n)	Part No.	Dimensions(in/mm)		Circuits (n)	Part No.	Dimensions(in/mm)	
		A	B			A	B
4	FFH25419-D04SXXX4K6XX	.100(2.54)	.220(5.58)	44	FFH25419-D44SXXX4K6XX	2.100(53.34)	2.220(56.38)
6	FFH25419-D06SXXX4K6XX	.200(5.08)	.320(8.12)	46	FFH25419-D46SXXX4K6XX	2.200(55.88)	2.320(58.92)
8	FFH25419-D08SXXX4K6XX	.300(7.62)	.420(10.66)	48	FFH25419-D48SXXX4K6XX	2.300(58.42)	2.420(61.46)
10	FFH25419-D10SXXX4K6XX	.400(10.16)	.520(13.20)	50	FFH25419-D50SXXX4K6XX	2.400(60.96)	2.520(64.00)
12	FFH25419-D12SXXX4K6XX	.500(12.70)	.620(15.74)	52	FFH25419-D52SXXX4K6XX	2.500(63.50)	2.620(66.54)
14	FFH25419-D14SXXX4K6XX	.600(15.24)	.720(18.28)	54	FFH25419-D54SXXX4K6XX	2.600(66.04)	2.720(69.08)
16	FFH25419-D16SXXX4K6XX	.700(17.78)	.820(20.82)	56	FFH25419-D56SXXX4K6XX	2.700(68.58)	2.820(71.62)
18	FFH25419-D18SXXX4K6XX	.800(20.32)	.920(23.36)	58	FFH25419-D58SXXX4K6XX	2.800(71.12)	2.920(74.16)
20	FFH25419-D20SXXX4K6XX	.900(22.86)	1.020(25.90)	60	FFH25419-D60SXXX4K6XX	2.900(73.66)	3.020(76.70)
22	FFH25419-D22SXXX4K6XX	1.000(25.40)	1.120(28.44)	62	FFH25419-D62SXXX4K6XX	3.000(76.20)	3.120(79.24)
24	FFH25419-D24SXXX4K6XX	1.100(27.94)	1.220(30.98)	64	FFH25419-D64SXXX4K6XX	3.100(78.74)	3.220(81.78)
26	FFH25419-D26SXXX4K6XX	1.200(30.48)	1.320(33.52)	66	FFH25419-D66SXXX4K6XX	3.200(81.28)	3.320(84.32)
28	FFH25419-D28SXXX4K6XX	1.300(33.02)	1.420(36.06)	68	FFH25419-D68SXXX4K6XX	3.300(83.82)	3.420(86.86)
30	FFH25419-D30SXXX4K6XX	1.400(35.56)	1.520(38.60)	70	FFH25419-D70SXXX4K6XX	3.400(86.36)	3.520(89.40)
32	FFH25419-D32SXXX4K6XX	1.500(38.10)	1.620(41.14)	72	FFH25419-D72SXXX4K6XX	3.500(88.90)	3.620(91.94)
34	FFH25419-D34SXXX4K6XX	1.600(40.64)	1.720(43.68)	74	FFH25419-D74SXXX4K6XX	3.600(91.44)	3.720(94.48)
36	FFH25419-D36SXXX4K6XX	1.700(43.18)	1.820(46.22)	76	FFH25419-D76SXXX4K6XX	3.700(93.98)	3.820(97.02)
38	FFH25419-D38SXXX4K6XX	1.800(45.72)	1.920(48.76)	78	FFH25419-D78SXXX4K6XX	3.800(96.52)	3.920(99.56)
40	FFH25419-D40SXXX4K6XX	1.900(48.26)	2.020(51.30)	80	FFH25419-D80SXXX4K6XX	3.900(99.06)	4.020(102.10)
42	FFH25419-D42SXXX4K6XX	2.000(50.80)	2.120(53.84)				



 THIRD ANGLE PROJECTION	GENERAL TOLERANCES (UNLESS SPECIFIED)		APPROVE BY FRANK	DATE 12/AUG/13	PART NO. FFH25419-DXXSXXX4K6XX	ITEM NO. FFH25419	 3K-KAMING		
	DESIGN UNITS Inch (metric)	X.X±.012(0.30)	.X'±5'	CHECKED BY CHERRY	DATE 12/AUG/13	TITLE Board to Board (Female Header) Pitch 2.54mm 180° Vertical (SMT)		REV 1	SHEET NO. 2/2
	SCALE 5:1	SIZE A4	X.XX±.008(0.20)	.X'±2'	DRAWN BY JACOB	DATE 12/AUG/13		THIS DRAWING CONTAINS INFORMATION THAT IS PROPRIETARY TO DONG GUAN LANG LUN(3K-KAMING) ELECTRONIC PRODUCTS CO.,LTD. AND SHOULD NOT BE USED WITHOUT WRITTEN PERMISSON	

REV	LOCATIONS	DESCRIPTION	DATE	REVISER	APPD
1	△	Size changes	29/MAY/20	KATE	CHERRY



SPECIFICATIONS

Electrical

Current Rating: 3A AC(rms)/DC
Voltage Rating: 250V AC(rms)/DC
Contact Resistance: 20 mΩ Max
Insulation Resistance: 1000 MΩ MIN
Withstanding Voltage: 500V AC r.m.s
Temperature Range-Operating: -40°C~+105°C

Material and Plating

Housing: PA6T (UL 94V-0)
Contact Pin: Brass
Plating: Gold Plated/Selective gold in contact area, tin on tail

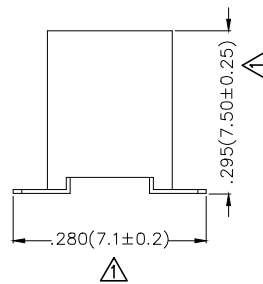
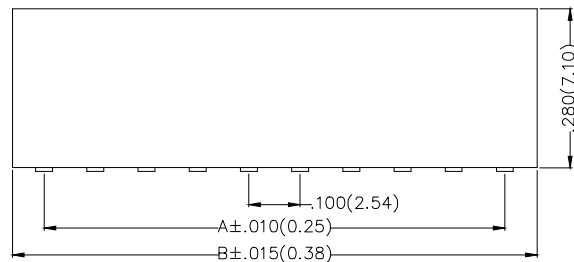
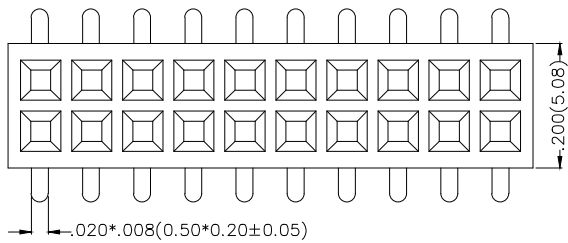

Packing: M-Reel(With Cap)

Packing: M1-Reel(With Mylar)

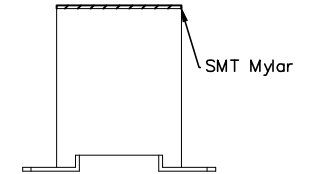
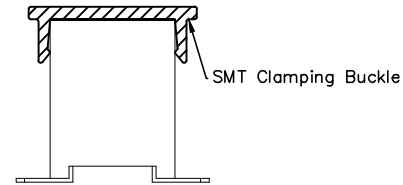

Ordering Information

FFH 254 19 - D XX S X XX 4 K6 XX A
1 2 3 4 5 6 7 8 9 10 11 12

1	Category FFH-Female Header	2	Series Number 254-Pitch2.54mm	3	Distinction No. 19	4	Row Option D-Double Row	5	Circuits XX	6	Entry Angle S-180° Vertical
7	Plating 1-Gold Plated 3-Selective gold in contact area, tin on tail	8	Thickness of Plating 00-Gold Plated 01-1μ" 05-5μ" Custom plate available	9	Material-Resin 4-PA6T	10	Color-Resin K6-Black	11	Packaging M-Reel(With Cap) M1-Reel(With Mylar)	12	Type A-W/O Position

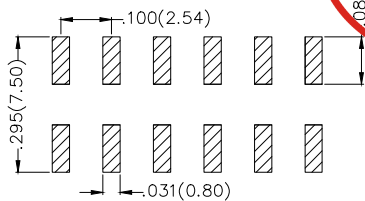

Recommended P.C.Board Layout

THIRD ANGLE PROJECTION	GENERAL TOLERANCES (UNLESS SPECIFIED)		APPROVE BY FRANK	DATE 12/AUG/13	PART NO. FFH25419-DXXSXXX4K6XXA	ITEM NO. FFH25419A	
	DESIGN UNITS Inch (metric)	X.±0.12(0.30) X.X±.008(0.20) X.XX±.006(0.15) X.XXX±.004(0.10)	X.'±5' X.'±2' .XX'±1" .XXX'±0.5'	CHECKED BY CHERRY	DATE 12/AUG/13	TITLE Board to Board (Female Header) Pitch 2.54mm 180° Vertical (SMT)	
SCALE 5:1	SIZE A4	DRAWN BY JACOB		DATE 12/AUG/13	THIS DRAWING CONTAINS INFORMATION THAT IS PROPRIETARY TO DONG GUAN LANG LUN(3K-KAMING) ELECTRONIC PRODUCTS CO.,LTD. AND SHOULD NOT BE USED WITHOUT WRITTEN PERMISSION		



REV	LOCATIONS	DESCRIPTION	DATE	REVISER	APPD

Circuits (n)	Part No.	Dimensions(in/mm)		Circuits (n)	Part No.	Dimensions(in/mm)	
		A	B			A	B
4	FFH25419-D04SXXX4K6XXA	.100(2.54)	.220(5.58)	44	FFH25419-D44SXXX4K6XXA	2.100(53.34)	2.220(56.38)
6	FFH25419-D06SXXX4K6XXA	.200(5.08)	.320(8.12)	46	FFH25419-D46SXXX4K6XXA	2.200(55.88)	2.320(58.92)
8	FFH25419-D08SXXX4K6XXA	.300(7.62)	.420(10.66)	48	FFH25419-D48SXXX4K6XXA	2.300(58.42)	2.420(61.46)
10	FFH25419-D10SXXX4K6XXA	.400(10.16)	.520(13.20)	50	FFH25419-D50SXXX4K6XXA	2.400(60.96)	2.520(64.00)
12	FFH25419-D12SXXX4K6XXA	.500(12.70)	.620(15.74)	52	FFH25419-D52SXXX4K6XXA	2.500(63.50)	2.620(66.54)
14	FFH25419-D14SXXX4K6XXA	.600(15.24)	.720(18.28)	54	FFH25419-D54SXXX4K6XXA	2.600(66.04)	2.720(69.08)
16	FFH25419-D16SXXX4K6XXA	.700(17.78)	.820(20.82)	56	FFH25419-D56SXXX4K6XXA	2.700(68.58)	2.820(71.62)
18	FFH25419-D18SXXX4K6XXA	.800(20.32)	.920(23.36)	58	FFH25419-D58SXXX4K6XXA	2.800(71.12)	2.920(74.16)
20	FFH25419-D20SXXX4K6XXA	.900(22.86)	1.020(25.90)	60	FFH25419-D60SXXX4K6XXA	2.900(73.66)	3.020(76.70)
22	FFH25419-D22SXXX4K6XXA	1.000(25.40)	1.120(28.44)	62	FFH25419-D62SXXX4K6XXA	3.000(76.20)	3.120(79.24)
24	FFH25419-D24SXXX4K6XXA	1.100(27.94)	1.220(30.98)	64	FFH25419-D64SXXX4K6XXA	3.100(78.74)	3.220(81.78)
26	FFH25419-D26SXXX4K6XXA	1.200(30.48)	1.320(33.52)	66	FFH25419-D66SXXX4K6XXA	3.200(81.28)	3.320(84.32)
28	FFH25419-D28SXXX4K6XXA	1.300(33.02)	1.420(36.06)	68	FFH25419-D68SXXX4K6XXA	3.300(83.82)	3.420(86.86)
30	FFH25419-D30SXXX4K6XXA	1.400(35.56)	1.520(38.60)	70	FFH25419-D70SXXX4K6XXA	3.400(86.36)	3.520(89.40)
32	FFH25419-D32SXXX4K6XXA	1.500(38.10)	1.620(41.14)	72	FFH25419-D72SXXX4K6XXA	3.500(88.90)	3.620(91.94)
34	FFH25419-D34SXXX4K6XXA	1.600(40.64)	1.720(43.68)	74	FFH25419-D74SXXX4K6XXA	3.600(91.44)	3.720(94.48)
36	FFH25419-D36SXXX4K6XXA	1.700(43.18)	1.820(46.22)	76	FFH25419-D76SXXX4K6XXA	3.700(93.98)	3.820(97.02)
38	FFH25419-D38SXXX4K6XXA	1.800(45.72)	1.920(48.76)	78	FFH25419-D78SXXX4K6XXA	3.800(96.52)	3.920(99.56)
40	FFH25419-D40SXXX4K6XXA	1.900(48.26)	2.020(51.30)	80	FFH25419-D80SXXX4K6XXA	3.900(99.06)	4.020(102.10)
42	FFH25419-D42SXXX4K6XXA	2.000(50.80)	2.120(53.84)				



 THIRD ANGLE PROJECTION	GENERAL TOLERANCES (UNLESS SPECIFIED)		APPROVE BY FRANK	DATE 12/AUG/13	PART NO. FFH25419-DXXXSXXX4K6XXA	ITEM NO. FFH25419A	 3K-KAMING		
	DESIGN UNITS Inch (metric)	X.±.012(0.30)	.X.±5'	CHECKED BY CHERRY	DATE 12/AUG/13	TITLE Board to Board (Female Header) Pitch 2.54mm 180° Vertical (SMT)		REV 1	SHEET NO. 2/2
	SCALE 5:1	SIZE A4	X.XX±.006(0.15)	.XX±1'	DRAWN BY JACOB	DATE 12/AUG/13		THIS DRAWING CONTAINS INFORMATION THAT IS PROPRIETARY TO DONG GUAN LANG LUN(3K-KAMING) ELECTRONIC PRODUCTS CO.,LTD. AND SHOULD NOT BE USED WITHOUT WRITTEN PERMISSION	