

K16带灯选择钮系列 / K16 Selector button

通过旋转独特的锁定结构型法兰盘即可改变选择位。且，法兰盘具备每旋转45°即可固定的锁定功能，所以法兰盘无旋转偏移，面板安装容易。

选择角的位置变更方法

【3位选择形状例】

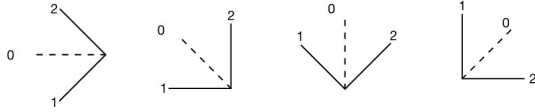



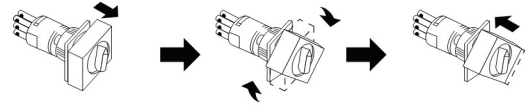





出厂时的选择位位置

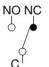
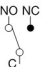
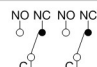
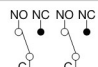

首先将法兰盘用力拉出解除锁定，即可旋转法兰盘。选择角的位置在任意45°的位置上按下即可进行锁定。

名称/外观 Product appearance	操作位规格 Operation	触点 Contact	产品型号 Model	灯罩颜色 Top Color	额定电压 Rated Voltage		
圆形 / Round  	90° 2位 2 Postion	L  自锁/Maintained	单刀/SPDT	<b>K16-4712</b> □ ●	请用下列颜色编码 替换型号中的"□" <b>R</b> 红色/Red <b>G</b> 绿色/Green <b>Y</b> 黄色/Yellow <b>W</b> 白色/White <b>B</b> 蓝色/Blue 请用下列颜色编码 替换型号中的"●" D:24VDC E:12VDC F:6.3VDC A1:110VAC A2:220VAC		
		L  R 自复/Momentary	单刀/SPDT	<b>K16-4710</b> □ ●			
		L  R 自锁/Maintained	双刀/DPDT	<b>K16-4722</b> □ ●			
		L  R 自复/Momentary	双刀/DPDT	<b>K16-4720</b> □ ●			
	90° 3位 3 Postion	L  C  R 自锁/Maintained	双刀/DPDT	<b>K16-5723</b> □ ●			
		L  C  R 左锁右复 Left lock Right reset	双刀/DPDT	<b>K16-5727</b> □ ●			
		L  C  R 左复右锁 Left reset Right lock	双刀/DPDT	<b>K16-5726</b> □ ●			
		L  C  R 自复/Momentary	双刀/DPDT	<b>K16-5721</b> □ ●			
		方形 / Square  	90° 2位 2 Postion	L  自锁/Maintained		单刀/SPDT	<b>K16-4812</b> □ ●
				L  R 自复/Momentary		单刀/SPDT	<b>K16-4810</b> □ ●
L  R 自锁/Maintained	双刀/DPDT			<b>K16-4822</b> □ ●			
L  R 自复/Momentary	双刀/DPDT			<b>K16-4820</b> □ ●			
90° 3位 3 Postion	L  C  R 自锁/Maintained		双刀/DPDT	<b>K16-5823</b> □ ●			
	L  C  R 左锁右复 Left lock Right reset		双刀/DPDT	<b>K16-5827</b> □ ●			
长方形 / Rectangle  	90° 2位 2 Postion	L  自锁/Maintained	单刀/SPDT	<b>K16-4912</b> □ ●			
		L  R 自复/Momentary	单刀/SPDT	<b>K16-4910</b> □ ●			
		L  R 自锁/Maintained	双刀/DPDT	<b>K16-4922</b> □ ●			
		L  R 自复/Momentary	双刀/DPDT	<b>K16-4920</b> □ ●			
	90° 3位 3 Postion	L  C  R 自锁/Maintained	双刀/DPDT	<b>K16-5923</b> □ ●			
		L  C  R 左锁右复 Left lock Right reset	双刀/DPDT	<b>K16-5927</b> □ ●			
		L  C  R 左复右锁 Left reset Right lock	双刀/DPDT	<b>K16-5926</b> □ ●			
		L  C  R 自复/Momentary	双刀/DPDT	<b>K16-5921</b> □ ●			

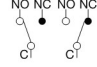
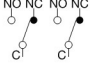
选择钮, 钥匙钮手柄位置/Selector and Key Switch Handle Position

操作位规格 Operation				触点 Contact	↙	↑	↗	
90° 2位 2 Position	 自锁 Maintained		 自复 Momentary		单刀 SPDT			
					双刀 DPDT			
90° 3位 3 Position	 自锁 Maintained	 左锁右复 Left lock Right reset	 左复右锁 Left reset Right lock	 自复 Momentary	三刀 TPDT			

圆形选择钮

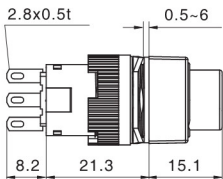
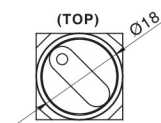

方形选择钮

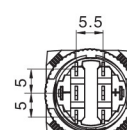
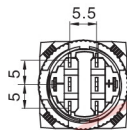
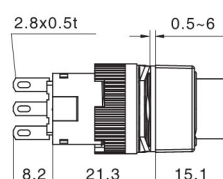
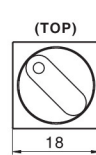

长方形选择钮

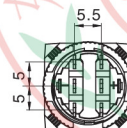
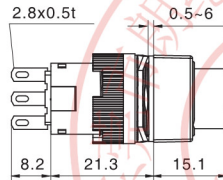
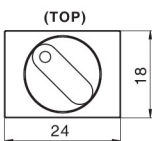

□ 安装尺寸图 / Installation size

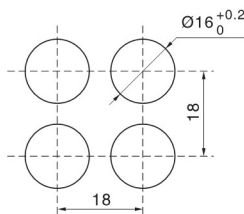

圆形Round

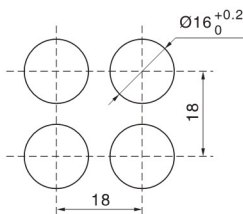

方形Square

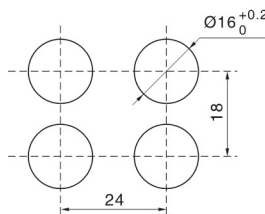

矩形Rectangle

□ 端子排列图 / Terminal style

按钮开关/Push Button

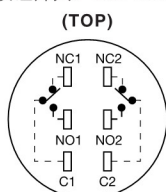

□ 灯珠电路图/LED Circuit

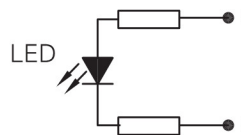

适用于交直流12VDC, 24VDC, 110VAC, 220VAC系列  
for 12VDC, 24VDC, 110VAC, 220VAC