





K16指示灯系列 / K16 Indicator Series

名称/外观 Product appearance			灯罩颜色 Top Color	额定电压 Rated Voltage
圆形 / Round K16-170 	方形 / Square K16-180 	长方形 / Rectangle K16-190 	请用下列颜色编码 替换型号中的"□" R 红色/Red G 绿色/Green Y 黄色/Yellow W 白色/White B 蓝色/Blue A 橙色/Orange	请用下列颜色编码 替换型号中的"●" D:24VDC E:12VDC F:6.3VDC A1:110VAC A2:220VAC
				

K16-G按钮系列 / K16-G Push Button

名称/外观 Product appearance	操作类别 Operation	带灯形式 Illuminated type	触点 Contact	产品型号 Model	灯罩颜色 Top Color	额定电压 Rated Voltage
圆形 / Round  	自复 Momentary	不带灯 Without LED	单刀/SPDT	K16-211 	请用下列颜色编码 替换型号中的"□" R 红色/Red G 绿色/Green Y 黄色/Yellow W 白色/White B 蓝色/Blue A 橙色/Orange	请用下列颜色编码 替换型号中的"●" D:24VDC E:12VDC F:6.3VDC A1:110VAC A2:220VAC
		带灯 With LED	单刀/SPDT	K16-271 		
		双刀/DPDT	K16-272 			
	自锁 Maintained	不带灯 Without LED	单刀/SPDT	K16-311 		
		带灯 With LED	单刀/SPDT	K16-371 		
		双刀/DPDT	K16-372 			
方形 / Square  	自复 Momentary	不带灯 Without LED	单刀/SPDT	K16-221 	请用下列颜色编码 替换型号中的"□" R 红色/Red G 绿色/Green Y 黄色/Yellow W 白色/White B 蓝色/Blue A 橙色/Orange	请用下列颜色编码 替换型号中的"●" D:24VDC E:12VDC F:6.3VDC A1:110VAC A2:220VAC
		带灯 With LED	单刀/SPDT	K16-281 		
		双刀/DPDT	K16-282 			
	自锁 Maintained	不带灯 Without LED	单刀/SPDT	K16-321 		
		带灯 With LED	单刀/SPDT	K16-381 		
		双刀/DPDT	K16-382 			
长方形 / Rectangle  	自复 Momentary	不带灯 Without LED	单刀/SPDT	K16-231 	请用下列颜色编码 替换型号中的"□" R 红色/Red G 绿色/Green Y 黄色/Yellow W 白色/White B 蓝色/Blue A 橙色/Orange	请用下列颜色编码 替换型号中的"●" D:24VDC E:12VDC F:6.3VDC A1:110VAC A2:220VAC
		带灯 With LED	单刀/SPDT	K16-291 		
		双刀/DPDT	K16-292 			
	自锁 Maintained	不带灯 Without LED	单刀/SPDT	K16-331 		
		带灯 With LED	单刀/SPDT	K16-391 		
		双刀/DPDT	K16-392 			

圆形指示灯

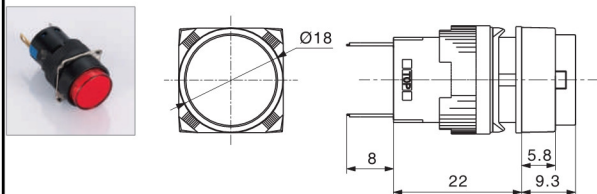

方形指示灯

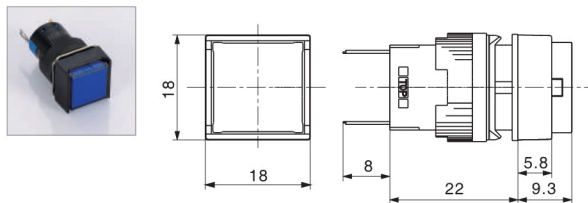

长方形指示灯

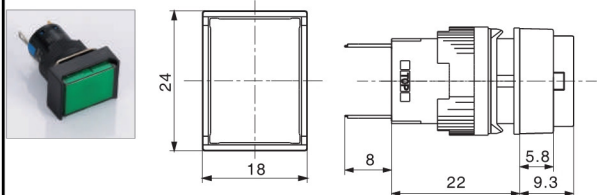

圆形按钮

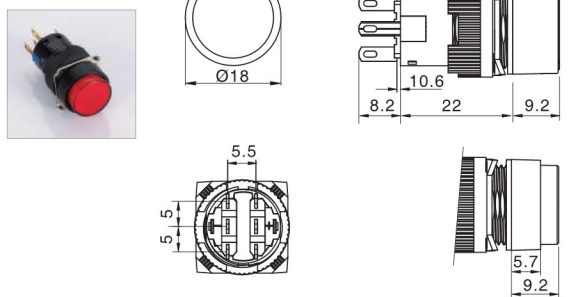

方形按钮

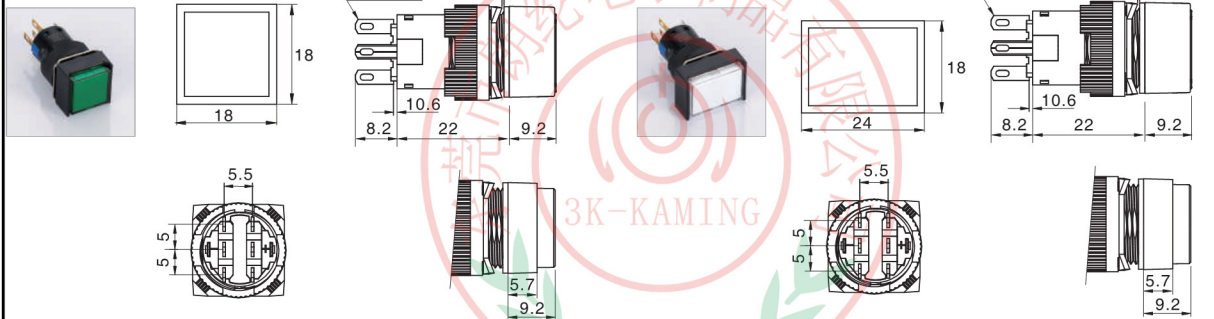

□ 安装尺寸图 / Installation size

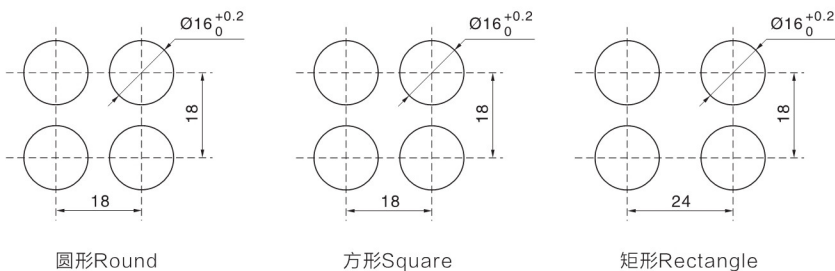

□ 端子排列图 / Terminal style

按钮开关/ Push Button

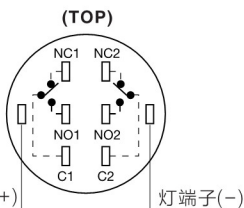

指示灯/Indicator

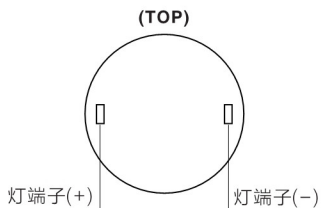

□ 灯珠电路图/LED Circuit

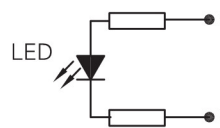

适用于交直流12VDC, 24VDC, 110VAC, 220VAC系列
for 12VDC, 24VDC, 110VAC, 220VAC