

K16带灯选择钮系列 / K16 Selector button

通过旋转独特的锁定结构型法兰盘即可改变选择位。且，法兰盘具备每旋转45°即可固定的锁定功能，所以法兰盘无旋转偏移，面板安装容易。

选择角的位置变更方法

【3位选择形状例】

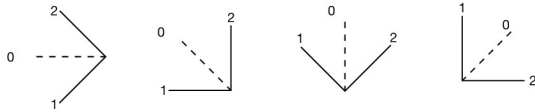

出厂时的选择位位置

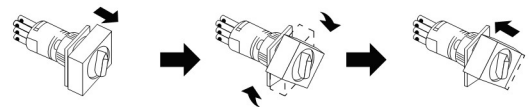

首先将法兰盘用力拉出解除锁定，即可旋转法兰盘。选择角的位置在任意45°的位置上按下即可进行锁定。

名称/外观 Product appearance	操作位规格 Operation	触点 Contact	产品型号 Model	灯罩颜色 Top Color	额定电压 Rated Voltage	
圆形 / Round  	90° 2位 2 Postion	L  自锁/Maintained	单刀/SPDT	<b>K16-4712</b> □ ●	请用下列颜色编码 替换型号中的"□" R 红色/Red G 绿色/Green Y 黄色/Yellow W 白色/White B 蓝色/Blue	请用下列颜色编码 替换型号中的"●" D:24VDC E:12VDC F:6.3VDC A1:110VAC A2:220VAC
		L  R 自复/Momentary	单刀/SPDT	<b>K16-4710</b> □ ●		
		L  R 自锁/Maintained	双刀/DPDT	<b>K16-4722</b> □ ●		
		L  R 自复/Momentary	双刀/DPDT	<b>K16-4720</b> □ ●		
	90° 3位 3 Postion	L  C  R 自锁/Maintained	双刀/DPDT	<b>K16-5723</b> □ ●		
		L  C  R 左锁右复 Left lock Right reset	双刀/DPDT	<b>K16-5727</b> □ ●		
		L  C  R 左复右锁 Left reset Right lock	双刀/DPDT	<b>K16-5726</b> □ ●		
		L  C  R 自复/Momentary	双刀/DPDT	<b>K16-5721</b> □ ●		
		方形 / Square  	90° 2位 2 Postion	L  自锁/Maintained		
L  R 自复/Momentary	单刀/SPDT			<b>K16-4810</b> □ ●		
L  R 自锁/Maintained	双刀/DPDT			<b>K16-4822</b> □ ●		
L  R 自复/Momentary	双刀/DPDT			<b>K16-4820</b> □ ●		
90° 3位 3 Postion	L  C  R 自锁/Maintained		双刀/DPDT	<b>K16-5823</b> □ ●		
	L  C  R 左锁右复 Left lock Right reset		双刀/DPDT	<b>K16-5827</b> □ ●		
	L  C  R 左复右锁 Left reset Right lock		双刀/DPDT	<b>K16-5826</b> □ ●		
	L  C  R 自复/Momentary		双刀/DPDT	<b>K16-5821</b> □ ●		
	长方形 / Rectangle  		90° 2位 2 Postion	L  自锁/Maintained	单刀/SPDT	<b>K16-4912</b> □ ●
L  R 自复/Momentary		单刀/SPDT		<b>K16-4910</b> □ ●		
L  R 自锁/Maintained		双刀/DPDT		<b>K16-4922</b> □ ●		
L  R 自复/Momentary		双刀/DPDT		<b>K16-4920</b> □ ●		
90° 3位 3 Postion		L  C  R 自锁/Maintained	双刀/DPDT	<b>K16-5923</b> □ ●		
		L  C  R 左锁右复 Left lock Right reset	双刀/DPDT	<b>K16-5927</b> □ ●		
		L  C  R 左复右锁 Left reset Right lock	双刀/DPDT	<b>K16-5926</b> □ ●		
		L  C  R 自复/Momentary	双刀/DPDT	<b>K16-5921</b> □ ●		

选择钮, 钥匙钮手柄位置/Selector and Key Switch Handle Position

操作位规格 Operation		触点 Contact	
		↙	↑
90° 2位 2 Position	 自锁 Maintained	 单刀 SPDT	 NO NC C1
	 自复 Momentary	 双刀 DPDT	 NO NC NO NC C1 C2
90° 3位 3 Position	 自锁 Maintained	 三刀 TPDT	 NO NC NO NC C1 C2
	 左锁右复 Left lock Right reset		 NO NC NO NC C1 C2
	 左复右锁 Left reset Right lock		 NO NC NO NC C1 C2
	 自复 Momentary		 NO NC NO NC C1 C2

圆形选择钮

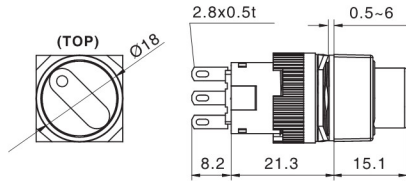

方形选择钮

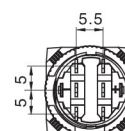
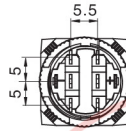
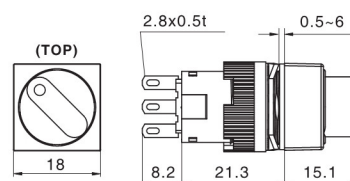

长方形选择钮

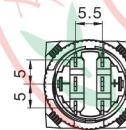
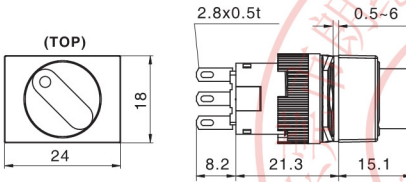

安装尺寸图 / Installation size

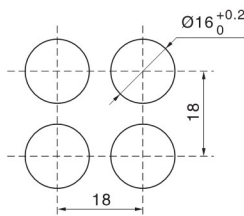

圆形Round

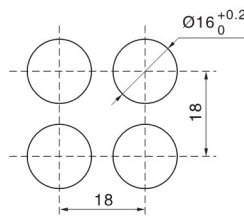

方形Square

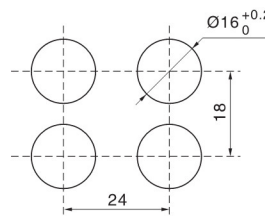

矩形Rectangle

端子排列图 / Terminal style

按钮开关/Push Button

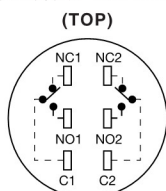

灯珠电路图/LED Circuit

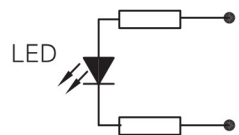

适用于交直流12VDC, 24VDC, 110VAC, 220VAC系列  
for 12VDC, 24VDC, 110VAC, 220VAC