



K16选择钮系列 / K16 Selector button

通过旋转独特的锁定结构型法兰盘即可改变选择位。且，法兰盘具备每旋转45°即可固定的锁定功能，所以法兰盘无旋转偏移，面板安装容易。

选择角的位置变更方法

【3位选择形状例】

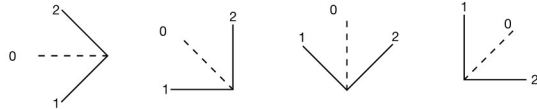

出厂时的选择位位置

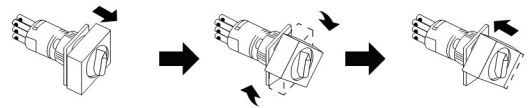

首先将法兰盘用力拉出解除锁定，即可旋转法兰盘。选择角的位置在任意45°的位置上按下即可进行锁定。

名称/外观 Product appearance	操作位规格 Operation	触点 Contact	产品型号 Model			
圆形 / Round  	90° 2位 2 Postion	L 	自锁/Maintained	单刀/SPDT	K16-4112	
		L  R	自复/Momentary	单刀/SPDT	K16-4110	
		L  R	自锁/Maintained	双刀/DPDT	K16-4122	
		L  R	自复/Momentary	双刀/DPDT	K16-4120	
	90° 3位 3 Postion	L  C  R	自锁/Maintained	双刀/DPDT	K16-5123	
		L  C  R	左锁右复/Left lock Right reset	双刀/DPDT	K16-5127	
		L  C  R	左复右锁/Left reset Right lock	双刀/DPDT	K16-5126	
		L  C  R	自复/Momentary	双刀/DPDT	K16-5121	
	方形 / Square  	90° 2位 2 Postion	L 	自锁/Maintained	单刀/SPDT	K16-4212
			L  R	自复/Momentary	单刀/SPDT	K16-4210
L  R			自锁/Maintained	双刀/DPDT	K16-4222	
L  R			自复/Momentary	双刀/DPDT	K16-4220	
90° 3位 3 Postion		L  C  R	自锁/Maintained	双刀/DPDT	K16-5223	
		L  C  R	左锁右复/Left lock Right reset	双刀/DPDT	K16-5227	
		L  C  R	左复右锁/Left reset Right lock	双刀/DPDT	K16-5226	
		L  C  R	自复/Momentary	双刀/DPDT	K16-5221	
长方形 / Rectangle  		90° 2位 2 Postion	L 	自锁/Maintained	单刀/SPDT	K16-4312
			L  R	自复/Momentary	单刀/SPDT	K16-4310
	L  R		自锁/Maintained	双刀/DPDT	K16-4322	
	L  R		自复/Momentary	双刀/DPDT	K16-4320	
	90° 3位 3 Postion	L  C  R	自锁/Maintained	双刀/DPDT	K16-5323	
		L  C  R	左锁右复/Left lock Right reset	双刀/DPDT	K16-5327	
		L  C  R	左复右锁/Left reset Right lock	双刀/DPDT	K16-5326	
		L  C  R	自复/Momentary	双刀/DPDT	K16-5321	

选择钮, 钥匙钮手柄位置/Selector and Key Switch Handle Positon

操作位规格 Operation		触点 Contact					
		↙	↑	↗			
90° 2位 2 Positon	 自锁 Maintained	 自复 Momentary	单刀 SPDT 				
			双刀 DPDT 				
90° 3位 3 Positon	 自锁 Maintained	 左锁右复 Left lock Right reset	 左复右锁 Left reset Right lock	 自复 Momentary	三刀 TPDT 		

圆形选择钮

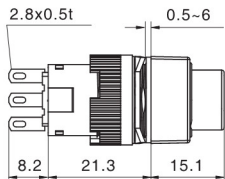
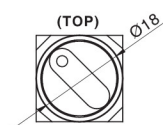

方形选择钮

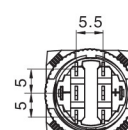
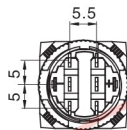
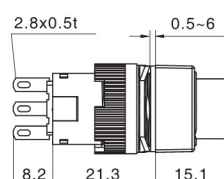

长方形选择钮

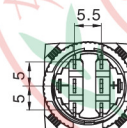
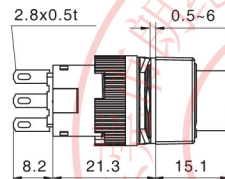
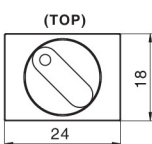

□ 安装尺寸图 / Installation size

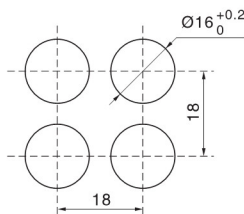

圆形Round

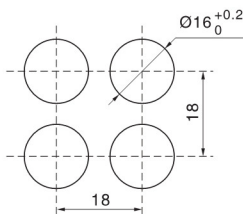

方形Square

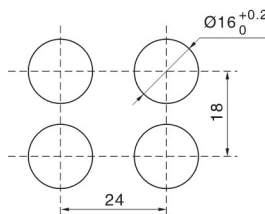

矩形Rectangle

□ 端子排列图 / Terminal style

按钮开关/ Push Button

(TOP)

