

1 2 3 4 5 6 7 8

REV	LOCATIONS	DESCRIPTION	DATE	REVISER	APPD

A

B

C

D

E

F

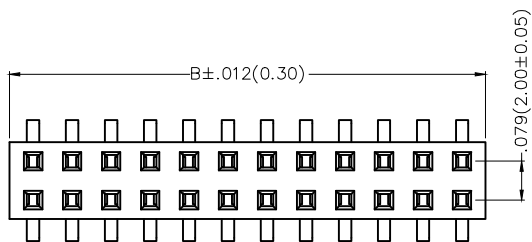

SPECIFICATIONS

Electrical

Current Rating: 2A AC(rms)/DC
 Voltage Rating: 250V AC(rms)/DC
 Contact Resistance: 20 mΩ Max
 Insulation Resistance: 1000 MΩ Min
 Withstanding Voltage: 500V AC r.m.s
 Temperature Range—Operating: -40°C~+85°C

Material and Plating

Housing: Glass Filled Polyester (UL 94V-0)
 Contact Pin: Phosphor bronze
 Plating: Gold Plated/Selective gold in contact area, tin on tail

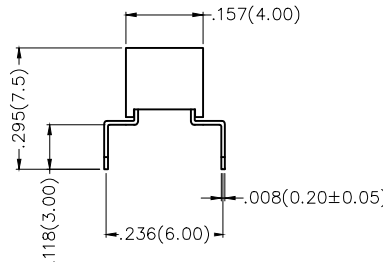
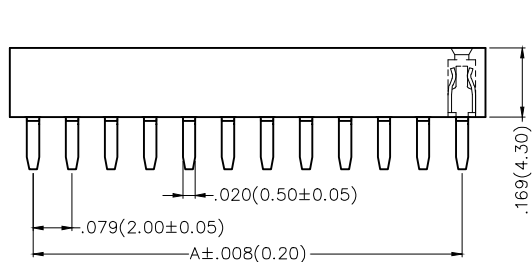

Ordering Information

FFH 200 39 — D XX S X XX X K6 K
 1 2 3 4 5 6 7 8 9 10 11

1 Category FFH—Female Header	2 Series Number 200—Pitch2.00mm	3 Distinction No. 39	4 Row Option D—Double Row	5 Circuits XX	6 Entry Angle S—180° Vertical
7 Plating 1—Gold Plated 3—Selective gold in contact area, tin on tail	8 Thickness of Plating 00—Gold Flash 05—5μ" Custom plate available	9 Material—Resin 1—PBT 4—PA6T	10 Color—Resin K6—Black	11 Packaging K—Tray	

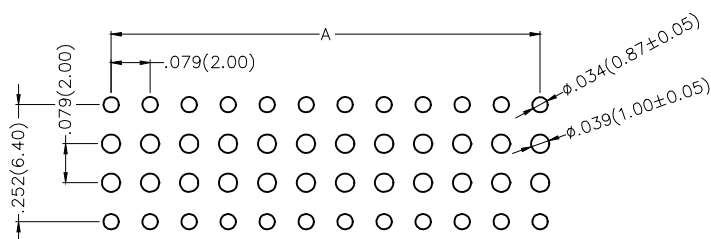

Recommended P.C.Board Layout

THIRD ANGLE PROJECTION	GENERAL TOLERANCES (UNLESS SPECIFIED)		APPROVE BY FRANK	DATE 04/JAN/17	PART NO. FFH20039-DXXSXXXXK6K	ITEM NO. FFH20039	
	X.±.012(0.30)	X.±5'	CHECKED BY CHERRY	DATE 04/JAN/17	TITLE Board to Board (Female Header) Pitch 2mm 180° Vertical (DIP)		
DESIGN UNITS Inch (metric)	X.X±.008(0.20)	.X'±2'	DRAWN BY KATE	DATE 04/JAN/17	THIS DRAWING CONTAINS INFORMATION THAT IS PROPRIETARY TO DONG GUAN LANG LUN(3K-KAMING) ELECTRONIC PRODUCTS CO., LTD. AND SHOULD NOT BE USED WITHOUT WRITTEN PERMISSION		
SCALE 5:1	X.XX±.006(0.15)	.XX'±1'					
	X.XXX±.004(0.10)	.XXX'±0.5'					

1 2 3 4 5 6 7 8

1 2 3 4 5 6 7 8

REV	LOCATIONS	DESCRIPTION	DATE	REVISER	APPD



Circuits (n)	Part No.	Dimensions(in/mm)		Circuits (n)	Part No.	Dimensions(in/mm)	
		A	B			A	B
2	FFH20039-D02SXXXXK6K	-	.091(2.30)	42	FFH20039-D42SXXXXK6K	1.575(40.00)	1.665(42.30)
4	FFH20039-D04SXXXXK6K	.079(2.00)	.169(4.30)	44	FFH20039-D44SXXXXK6K	1.654(42.00)	1.744(44.30)
6	FFH20039-D06SXXXXK6K	.157(4.00)	.248(6.30)	46	FFH20039-D46SXXXXK6K	1.732(44.00)	1.823(46.30)
8	FFH20039-D08SXXXXK6K	.236(6.00)	.327(8.30)	48	FFH20039-D48SXXXXK6K	1.811(46.00)	1.902(48.30)
10	FFH20039-D10SXXXXK6K	.315(8.00)	.406(10.30)	50	FFH20039-D50SXXXXK6K	1.890(48.00)	1.980(50.30)
12	FFH20039-D12SXXXXK6K	.394(10.00)	.484(12.30)	52	FFH20039-D52SXXXXK6K	1.969(50.00)	2.059(52.30)
14	FFH20039-D14SXXXXK6K	.472(12.00)	.563(14.30)	54	FFH20039-D54SXXXXK6K	2.047(52.00)	2.138(54.30)
16	FFH20039-D16SXXXXK6K	.551(14.00)	.642(16.30)	56	FFH20039-D56SXXXXK6K	2.126(54.00)	2.217(56.30)
18	FFH20039-D18SXXXXK6K	.630(16.00)	.720(18.30)	58	FFH20039-D58SXXXXK6K	2.205(56.00)	2.295(58.30)
20	FFH20039-D20SXXXXK6K	.709(18.00)	.799(20.30)	60	FFH20039-D60SXXXXK6K	2.283(58.00)	2.374(60.30)
22	FFH20039-D22SXXXXK6K	.787(20.00)	.878(22.30)	62	FFH20039-D62SXXXXK6K	2.362(60.00)	2.453(62.30)
24	FFH20039-D24SXXXXK6K	.866(22.00)	.957(24.30)	64	FFH20039-D64SXXXXK6K	2.441(62.00)	2.531(64.30)
26	FFH20039-D26SXXXXK6K	.945(24.00)	1.035(26.30)	66	FFH20039-D66SXXXXK6K	2.520(64.00)	2.610(66.30)
28	FFH20039-D28SXXXXK6K	1.024(26.00)	1.114(28.30)	68	FFH20039-D68SXXXXK6K	2.598(66.00)	2.689(68.30)
30	FFH20039-D30SXXXXK6K	1.102(28.00)	1.193(30.30)	70	FFH20039-D70SXXXXK6K	2.677(68.00)	2.768(70.30)
32	FFH20039-D32SXXXXK6K	1.181(30.00)	1.272(32.30)	72	FFH20039-D72SXXXXK6K	2.756(70.00)	2.846(72.30)
34	FFH20039-D34SXXXXK6K	1.260(32.00)	1.350(34.30)	74	FFH20039-D74SXXXXK6K	2.835(72.00)	2.925(74.30)
36	FFH20039-D36SXXXXK6K	1.339(34.00)	1.429(36.30)	76	FFH20039-D76SXXXXK6K	2.913(74.00)	3.004(76.30)
38	FFH20039-D38SXXXXK6K	1.417(36.00)	1.508(38.30)	78	FFH20039-D78SXXXXK6K	2.992(76.00)	3.083(78.30)
40	FFH20039-D40SXXXXK6K	1.496(38.00)	1.587(40.30)	80	FFH20039-D80SXXXXK6K	3.071(78.00)	3.161(80.30)



<p>THIRD ANGLE PROJECTION</p>	GENERAL TOLERANCES (UNLESS SPECIFIED)		APPROVE BY FRANK	DATE 04/JAN/17	PART NO. FFH20039-DXXSXXXXK6K	ITEM NO. FFH20039	<p>3K-KAMING</p>	
	X.±.012(0.30)	X'±5'	CHECKED BY CHERRY	DATE 04/JAN/17	TITLE Board to Board (Female Header) Pitch 2mm 180° Vertical (DIP)			REV 0
	DESIGN UNITS Inch (metric)	X.X±.008(0.20)	X'±2'	DRAWN BY KATE	DATE 04/JAN/17	THIS DRAWING CONTAINS INFORMATION THAT IS PROPRIETARY TO DONG GUAN LANG LUN(3K-KAMING) ELECTRONIC PRODUCTS CO., LTD. AND SHOULD NOT BE USED WITHOUT WRITTEN PERMISSION		
	SCALE 5:1	SIZE A4	X.XX±.006(0.15)	X.XX'±1'	X.XXX±.004(0.10)	X.XX'±0.5'		

1 2 3 4 5 6 7 8