

REV	LOCATIONS	DESCRIPTION	DATE	REVISER	APPD

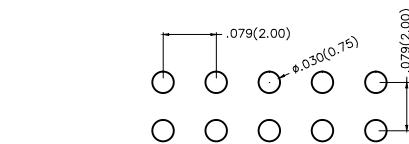

Electrical
 Current Rating: 2A AC(rms)/DC
 Voltage Rating: 250V AC(rms)/DC
 Contact Resistance: 20 mΩ Max
 Insulation Resistance: 500 MΩ MIN
 Withstanding Voltage: 100V AC r.m.s
 Temperature Range-Operating: -25°C~+85°C

Material and Plating
 Housing: PA6T(UL 94V-0)
 Contact Pin: Phosphor Bronze
 Plating: Gold Plated/Selective gold in contact area, matte(bright) tin on tail

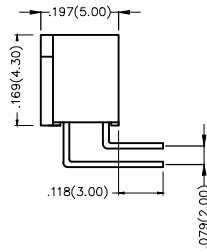
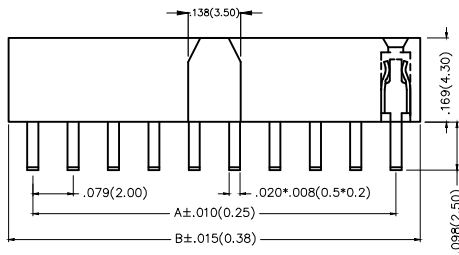
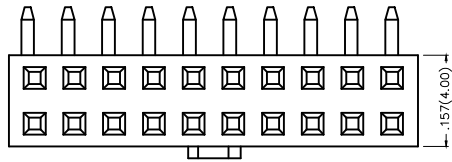

Recommended P.C.Board Layout



Ordering Information

FFH 200 10 - D XX B 1 XX 4 K6 K
 1 2 3 4 5 6 7 8 9 10 11

1 Category FFH-Female Header	2 Series Number 200-Pitch2.0mm	3 Distinction No. 10	4 Row Option D-Double Row	5 Circuits XX	6 Entry Angle B-90° Angle
7 Plating 1-Gold Plated 3-Selective gold in contact area, matte(bright) tin on tail	8 Thickness of Plating 00-Gold Flash 05-5μ" Custom plate available	9 Material-Resin 4-PA6T	10 Color-Resin K6-Black	11 Packaging K-Tray	

 THIRD ANGLE PROJECTION	GENERAL TOLERANCES (UNLESS SPECIFIED)		APPROVE BY FRANK	DATE 12/JUL/13	PART NO. FFH20010-DXXBXXX4K6K	ITEM NO. FFH20010	 3K-KAMING
	DESIGN UNITS Inch (metric)	X.X±.012(0.30)	.X'±5'	CHECKED BY CHERRY	DATE 12/JUL/13	TITLE Board to Board (Female Header) Pitch 2.0mm 90° Angle (DIP)	
SCALE 5:1	SIZE A4	X.XX±.006(0.15)	.XX'±1'	DRAWN BY JACOB	DATE 12/JUL/13	THIS DRAWING CONTAINS INFORMATION THAT IS PROPRIETARY TO DONG GUAN LANG LUN(3K-KAMING) ELECTRONIC PRODUCTS CO.,LTD. AND SHOULD NOT BE USED WITHOUT WRITTEN PERMISSION	
		X.XXX±.004(0.10)	.XXX'±0.5'			REV 0	SHEET NO. 1/1

REV	LOCATIONS	DESCRIPTION	DATE	REVISER	APPD



Circuits (n)	Part No.	Dimensions(in/mm)		Circuits (n)	Part No.	Dimensions(in/mm)	
		A	B			A	B
8	FFH20010-D08BXXX4K6K	.236(6.00)	.335(8.50)	46	FFH20010-D46BXXX4K6K	1.732(44.00)	1.831(46.50)
10	FFH20010-D10BXXX4K6K	.315(8.00)	.413(10.50)	48	FFH20010-D48BXXX4K6K	1.811(46.00)	1.909(48.50)
12	FFH20010-D12BXXX4K6K	.394(10.00)	.492(12.50)	50	FFH20010-D50BXXX4K6K	1.890(48.00)	1.988(50.50)
14	FFH20010-D14BXXX4K6K	.472(12.00)	.571(14.50)	52	FFH20010-D52BXXX4K6K	1.969(50.00)	2.067(52.50)
16	FFH20010-D16BXXX4K6K	.551(14.00)	.650(16.50)	54	FFH20010-D54BXXX4K6K	2.047(52.00)	2.146(54.50)
18	FFH20010-D18BXXX4K6K	.630(16.00)	.728(18.50)	56	FFH20010-D56BXXX4K6K	2.126(54.00)	2.224(56.50)
20	FFH20010-D20BXXX4K6K	.709(18.00)	.807(20.50)	58	FFH20010-D58BXXX4K6K	2.205(56.00)	2.303(58.50)
22	FFH20010-D22BXXX4K6K	.787(20.00)	.886(22.50)	60	FFH20010-D60BXXX4K6K	2.283(58.00)	2.382(60.50)
24	FFH20010-D24BXXX4K6K	.866(22.00)	.965(24.50)	62	FFH20010-D62BXXX4K6K	2.362(60.00)	2.461(62.50)
26	FFH20010-D26BXXX4K6K	.845(24.00)	1.043(26.50)	64	FFH20010-D64BXXX4K6K	2.441(62.00)	2.539(64.50)
28	FFH20010-D28BXXX4K6K	1.024(26.00)	1.122(28.50)	66	FFH20010-D66BXXX4K6K	2.520(64.00)	2.618(66.50)
30	FFH20010-D30BXXX4K6K	1.102(28.00)	1.201(30.50)	68	FFH20010-D68BXXX4K6K	2.598(66.00)	2.697(68.50)
32	FFH20010-D32BXXX4K6K	1.181(30.00)	1.280(32.50)	70	FFH20010-D70BXXX4K6K	2.677(68.00)	2.776(70.50)
34	FFH20010-D34BXXX4K6K	1.260(32.00)	1.358(34.50)	72	FFH20010-D72BXXX4K6K	2.756(70.00)	2.854(72.50)
36	FFH20010-D36BXXX4K6K	1.339(34.00)	1.437(36.50)	74	FFH20010-D74BXXX4K6K	2.835(72.00)	2.933(74.50)
38	FFH20010-D38BXXX4K6K	1.417(36.00)	1.516(38.50)	76	FFH20010-D76BXXX4K6K	2.913(74.00)	3.012(76.50)
40	FFH20010-D40BXXX4K6K	1.496(38.00)	1.594(40.50)	78	FFH20010-D78BXXX4K6K	2.992(76.00)	3.091(78.50)
42	FFH20010-D42BXXX4K6K	1.575(40.00)	1.673(42.50)	80	FFH20010-D80BXXX4K6K	3.071(78.00)	3.169(80.50)
44	FFH20010-D44BXXX4K6K	1.654(42.00)	1.752(44.50)				



 THIRD ANGLE PROJECTION	GENERAL TOLERANCES (UNLESS SPECIFIED)		APPROVE BY FRANK	DATE 12/JUL/13	PART NO. FFH20010-DXXBXXX4K6K	ITEM NO. FFH20010	 3K-KAMING
	X.±.012(0.30)	X.±5'	CHECKED BY CHERRY	DATE 12/JUL/13	TITLE Board to Board (Female Header) Pitch 2.0mm 90° Angle (DIP)		
DESIGN UNITS Inch (metric)	X.X±.008(0.20)	.X'±2'	DRAWN BY JACOB	DATE 12/JUL/13	THIS DRAWING CONTAINS INFORMATION THAT IS PROPRIETARY TO DONG GUAN LANG LUN(3K-KAMING) ELECTRONIC PRODUCTS CO.,LTD. AND SHOULD NOT BE USED WITHOUT WRITTEN PERMISSION		
SCALE 5:1	SIZE A4	X.XX±.006(0.15)					
		X.XXX±.004(0.10)					