

REV	LOCATIONS	DESCRIPTION	DATE	REVISER	APPD



Electrical

Current Rating: 2A AC(rms)/DC
Voltage Rating: 250V AC(rms)/DC
Contact Resistance: 20 mΩ Max
Insulation Resistance: 500 MΩ MIN
Withstanding Voltage: 100V AC r.m.s
Temperature Range-Operating: -25°C~+85°C

Material and Plating

Housing: PA6T(UL 94V-0)
Contact Pin: Brass
Plating: Gold plated/ Selective gold plated on contact area and 120μ" Min. matte tin plated on tails area

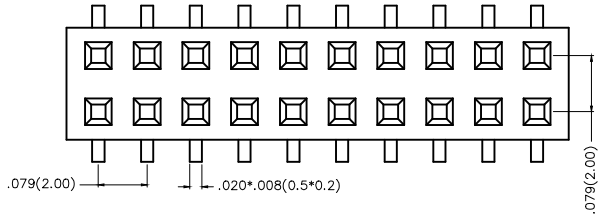

Packing: M-Reel(With Cap)

Packing: M1-Reel(With Mylar)

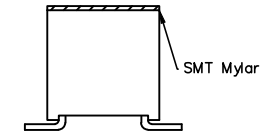
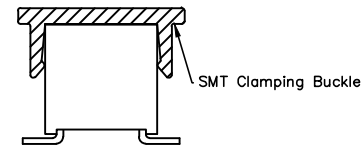
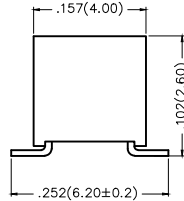
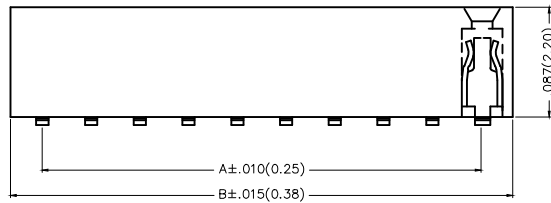

Ordering Information

FFH 200 09 - D XX S X XX 4 K6 XX
1 2 3 4 5 6 7 8 9 10 11

1 Category FFH-Female Header	2 Series Number 200-Pitch 2.0mm	3 Distinction No. 09	4 Row Option D-Double Row	5 Circuits XX	6 Entry Angle S-180° Vertical
7 Plating 1-Gold plated 7-Selective gold plated on contact area and matte tin plated on tails area	8 Thickness of Plating 00-Gold Flash 05-5μ" Custom plate available	9 Material-Resin 4-PA6T	10 Color-Resin K6-Black	11 Packaging M-Reel(With Cap) M1-Reel(With Mylar)	

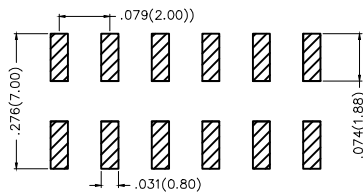

Recommended P.C.Board Layout

THIRD ANGLE PROJECTION	GENERAL TOLERANCES (UNLESS SPECIFIED)		APPROVE BY FRANK	DATE 23/JUL/13	PART NO. FFH20009-DXXSXXX4K6XX	ITEM NO. FFH20009	
	DESIGN UNITS Inch (metric)	X.±.012(0.30) X.X±.008(0.20) X.XX±.006(0.15) X.XXX±.004(0.10)	X.±5' .X'±2' .XX'±1' .XXX'±0.5'	CHECKED BY CHERRY	DATE 23/JUL/13	TITLE Board to Board (Female Header) Pitch 2.0mm 180° Vertical (SMT)	
SCALE 5:1	SIZE A4	DRAWN BY JACOB		DATE 23/JUL/13	THIS DRAWING CONTAINS INFORMATION THAT IS PROPRIETARY TO DONG GUAN LANG LUN(3K-KAMING) ELECTRONIC PRODUCTS CO.,LTD. AND SHOULD NOT BE USED WITHOUT WRITTEN PERMISSION		



REV	LOCATIONS	DESCRIPTION	DATE	REVISER	APPD

Circuits (n)	Part No.	Dimensions(in/mm)		Circuits (n)	Part No.	Dimensions(in/mm)	
		A	B			A	B
4	FFH20009-D04SXXX4K6M	.079(2.00)	.157(4.00)	44	FFH20009-D44SXXX4K6M	1.654(42.00)	1.732(44.00)
6	FFH20009-D06SXXX4K6M	.157(4.00)	.236(6.00)	46	FFH20009-D46SXXX4K6M	1.732(44.00)	1.811(46.00)
8	FFH20009-D08SXXX4K6M	.236(6.00)	.315(8.00)	48	FFH20009-D48SXXX4K6M	1.811(46.00)	1.890(48.00)
10	FFH20009-D10SXXX4K6M	.315(8.00)	.394(10.00)	50	FFH20009-D50SXXX4K6M	1.890(48.00)	1.969(50.00)
12	FFH20009-D12SXXX4K6M	.394(10.00)	.472(12.00)	52	FFH20009-D52SXXX4K6M	1.969(50.00)	2.047(52.00)
14	FFH20009-D14SXXX4K6M	.472(12.00)	.551(14.00)	54	FFH20009-D54SXXX4K6M	2.047(52.00)	2.126(54.00)
16	FFH20009-D16SXXX4K6M	.551(14.00)	.630(16.00)	56	FFH20009-D56SXXX4K6M	2.126(54.00)	2.205(56.00)
18	FFH20009-D18SXXX4K6M	.630(16.00)	.709(18.00)	58	FFH20009-D58SXXX4K6M	2.205(56.00)	2.283(58.00)
20	FFH20009-D20SXXX4K6M	.709(18.00)	.787(20.00)	60	FFH20009-D60SXXX4K6M	2.283(58.00)	2.362(60.00)
22	FFH20009-D22SXXX4K6M	.787(20.00)	.866(22.00)	62	FFH20009-D62SXXX4K6M	2.362(60.00)	2.441(62.00)
24	FFH20009-D24SXXX4K6M	.866(22.00)	.845(24.00)	64	FFH20009-D64SXXX4K6M	2.441(62.00)	2.520(64.00)
26	FFH20009-D26SXXX4K6M	.845(24.00)	1.024(26.00)	66	FFH20009-D66SXXX4K6M	2.520(64.00)	2.598(66.00)
28	FFH20009-D28SXXX4K6M	1.024(26.00)	1.102(28.00)	68	FFH20009-D68SXXX4K6M	2.598(66.00)	2.677(68.00)
30	FFH20009-D30SXXX4K6M	1.102(28.00)	1.181(30.00)	70	FFH20009-D70SXXX4K6M	2.677(68.00)	2.756(70.00)
32	FFH20009-D32SXXX4K6M	1.181(30.00)	1.260(32.00)	72	FFH20009-D72SXXX4K6M	2.756(70.00)	2.835(72.00)
34	FFH20009-D34SXXX4K6M	1.260(32.00)	1.339(34.00)	74	FFH20009-D74SXXX4K6M	2.835(72.00)	2.913(74.00)
36	FFH20009-D36SXXX4K6M	1.339(34.00)	1.417(36.00)	76	FFH20009-D76SXXX4K6M	2.913(74.00)	2.992(76.00)
38	FFH20009-D38SXXX4K6M	1.417(36.00)	1.496(38.00)	78	FFH20009-D78SXXX4K6M	2.992(76.00)	3.071(78.00)
40	FFH20009-D40SXXX4K6M	1.496(38.00)	1.575(40.00)	80	FFH20009-D80SXXX4K6M	3.071(78.00)	3.150(80.00)
42	FFH20009-D42SXXX4K6M	1.575(40.00)	1.654(42.00)				



 THIRD ANGLE PROJECTION	GENERAL TOLERANCES (UNLESS SPECIFIED)		APPROVE BY	DATE	PART NO.	ITEM NO.	 3K-KAMING	
	X±.012(0.30)	.X'±5'	FRANK	23/JUL/13	FFH20009-DXXSXXX4K6XX	FFH20009		
	X.X±.008(0.20)	.X'±2'	CHECKED BY	DATE	TITLE			
DESIGN UNITS Inch (metric)	X.XX±.006(0.15)	.XX'±1'	CHERRY	23/JUL/13	Board to Board (Female Header) Pitch 2.00mm 180° Vertical (SMT)		REV 0	SHEET NO. 2/2
SCALE 5:1	X.XXX±.004(0.10)	.XXX'±0.5'	DRAWN BY	DATE	THIS DRAWING CONTAINS INFORMATION THAT IS PROPRIETARY TO DONG GUAN LANG LUN(3K-KAMING) ELECTRONIC PRODUCTS CO.,LTD. AND SHOULD NOT BE USED WITHOUT WRITTEN PERMISSION			
SIZE A4			JACOB	23/JUL/13				

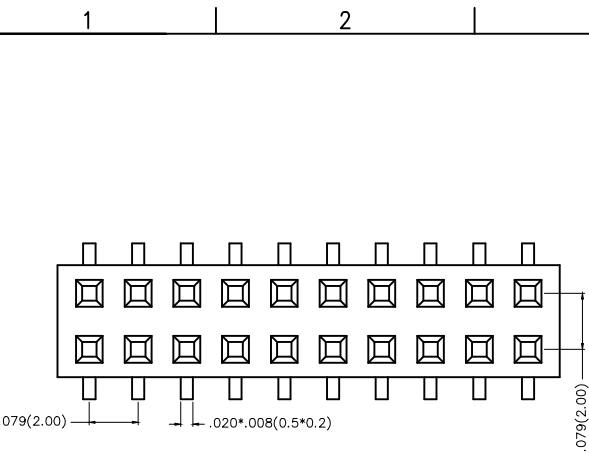

Electrical

Current Rating: 2A AC(rms)/DC
 Voltage Rating: 250V AC(rms)/DC
 Contact Resistance: 20 mΩ Max
 Insulation Resistance: 500 MΩ MIN
 Withstanding Voltage: 100V AC r.m.s
 Temperature Range—Operating: -25°C~+85°C

Material and Plating

Housing: PA6T(UL 94V-0)
 Contact Pin: Brass
 Plating: Gold plated/ Selective gold plated on contact area and 120μ" Min. matte tin plated on tails area

Packing: M—Reel(With Cap)

Packing: M1—Reel(With Mylar)

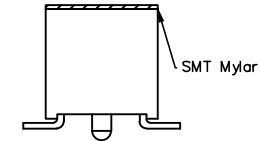
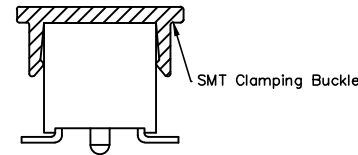
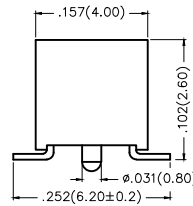
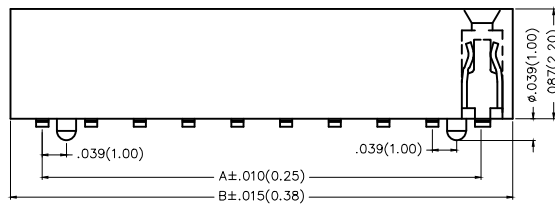

Ordering Information

FFH 200 09 — D XX S X XX 4 K6 XX A
 1 2 3 4 5 6 7 8 9 10 11 12

1 Category FFH—Female Header	2 Series Number 200—Pitch2.0mm	3 Distinction No. 09	4 Row Option D—Double Row	5 Circuits XX	6 Entry Angle S—180° Vertical	7 Plating 1—Gold plated 7—Selective gold plated on contact area and matte tin plated on tails area	8 Thickness of Plating 00—Gold Flash 05—5μ" Custom plate available	9 Material—Resin 4—PA6T	10 Color—Resin K6—Black	11 Packaging M—Reel(With Cap) M1—Reel(With Mylar)	12 Type A—With Position
-----------------------------------	-------------------------------------	---------------------------	--------------------------------	--------------------	------------------------------------	--	---	------------------------------	------------------------------	---	------------------------------

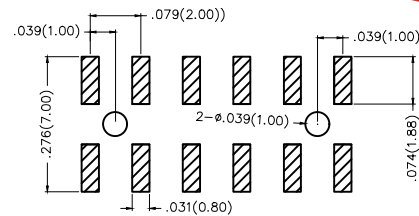

Recommended P.C.Board Layout

THIRD ANGLE PROJECTION	GENERAL TOLERANCES (UNLESS SPECIFIED)		APPROVE BY FRANK	DATE 23/JUL/13	PART NO. FFH20009-DXXSXXX4K6XXA	ITEM NO. FFH20009	
	DESIGN UNITS Inch (metric)	X.X±.012(0.30) X.X±.008(0.20) X.XX±.006(0.15) X.XXX±.004(0.10)	X'±5" 'X'±2" .XX'±1" .XXX'±0.5'	CHECKED BY CHERRY	DATE 23/JUL/13	TITLE Board to Board (Female Header) Pitch 2.0mm 180° Vertical (SMT)	
SCALE 5:1	SIZE A4	DRAWN BY JACOB		DATE 23/JUL/13	THIS DRAWING CONTAINS INFORMATION THAT IS PROPRIETARY TO DONG GUAN LANG LUN(3K-KAMING) ELECTRONIC PRODUCTS CO.,LTD. AND SHOULD NOT BE USED WITHOUT WRITTEN PERMISSION		

REV	LOCATIONS	DESCRIPTION	DATE	REVISER	APPD



Circuits (n)	Part No.	Dimensions(in/mm)		Circuits (n)	Part No.	Dimensions(in/mm)	
		A	B			A	B
6	FFH20009-D06SXXX4K6MA	.157(4.00)	.236(6.00)	44	FFH20009-D44SXXX4K6MA	1.654(42.00)	1.732(44.00)
8	FFH20009-D08SXXX4K6MA	.236(6.00)	.315(8.00)	46	FFH20009-D46SXXX4K6MA	1.732(44.00)	1.811(46.00)
10	FFH20009-D10SXXX4K6MA	.315(8.00)	.394(10.00)	48	FFH20009-D48SXXX4K6MA	1.811(46.00)	1.890(48.00)
12	FFH20009-D12SXXX4K6MA	.394(10.00)	.472(12.00)	50	FFH20009-D50SXXX4K6MA	1.890(48.00)	1.969(50.00)
14	FFH20009-D14SXXX4K6MA	.472(12.00)	.551(14.00)	52	FFH20009-D52SXXX4K6MA	1.969(50.00)	2.047(52.00)
16	FFH20009-D16SXXX4K6MA	.551(14.00)	.630(16.00)	54	FFH20009-D54SXXX4K6MA	2.047(52.00)	2.126(54.00)
18	FFH20009-D18SXXX4K6MA	.630(16.00)	.709(18.00)	56	FFH20009-D56SXXX4K6MA	2.126(54.00)	2.205(56.00)
20	FFH20009-D20SXXX4K6MA	.709(18.00)	.787(20.00)	58	FFH20009-D58SXXX4K6MA	2.205(56.00)	2.283(58.00)
22	FFH20009-D22SXXX4K6MA	.787(20.00)	.866(22.00)	60	FFH20009-D60SXXX4K6MA	2.283(58.00)	2.362(60.00)
24	FFH20009-D24SXXX4K6MA	.866(22.00)	.845(24.00)	62	FFH20009-D62SXXX4K6MA	2.362(60.00)	2.441(62.00)
26	FFH20009-D26SXXX4K6MA	.845(24.00)	1.024(26.00)	64	FFH20009-D64SXXX4K6MA	2.441(62.00)	2.520(64.00)
28	FFH20009-D28SXXX4K6MA	1.024(26.00)	1.102(28.00)	66	FFH20009-D66SXXX4K6MA	2.520(64.00)	2.598(66.00)
30	FFH20009-D30SXXX4K6MA	1.102(28.00)	1.181(30.00)	68	FFH20009-D68SXXX4K6MA	2.598(66.00)	2.677(68.00)
32	FFH20009-D32SXXX4K6MA	1.181(30.00)	1.260(32.00)	70	FFH20009-D70SXXX4K6MA	2.677(68.00)	2.756(70.00)
34	FFH20009-D34SXXX4K6MA	1.260(32.00)	1.339(34.00)	72	FFH20009-D72SXXX4K6MA	2.756(70.00)	2.835(72.00)
36	FFH20009-D36SXXX4K6MA	1.339(34.00)	1.417(36.00)	74	FFH20009-D74SXXX4K6MA	2.835(72.00)	2.913(74.00)
38	FFH20009-D38SXXX4K6MA	1.417(36.00)	1.496(38.00)	76	FFH20009-D76SXXX4K6MA	2.913(74.00)	2.992(76.00)
40	FFH20009-D40SXXX4K6MA	1.496(38.00)	1.575(40.00)	78	FFH20009-D78SXXX4K6MA	2.992(76.00)	3.071(78.00)
42	FFH20009-D42SXXX4K6MA	1.575(40.00)	1.654(42.00)	80	FFH20009-D80SXXX4K6MA	3.071(78.00)	3.150(80.00)



 THIRD ANGLE PROJECTION	GENERAL TOLERANCES (UNLESS SPECIFIED)		APPROVE BY FRANK	DATE 23/JUL/13	PART NO. FFH20009-DXXSXXX4K6XXA	ITEM NO. FFH20009	 3K-KAMING
	X.±.012(0.30)	.X'±5'	CHECKED BY CHERRY	DATE 23/JUL/13	TITLE Board to Board (Female Header) Pitch 2.00mm 180° Vertical (SMT)		
	DESIGN UNITS Inch (metric)	X.XX±.008(0.20)	.XX'±2'	DRAWN BY JACOB	DATE 23/JUL/13	THIS DRAWING CONTAINS INFORMATION THAT IS PROPRIETARY TO DONG GUAN LANG LUN(3K-KAMING) ELECTRONIC PRODUCTS CO.,LTD. AND SHOULD NOT BE USED WITHOUT WRITTEN PERMISSION	
	SCALE 5:1	SIZE A4	X.XXX±.004(0.10)	.XX'±0.5'			