

| REV | LOCATIONS | DESCRIPTION | DATE | REVISER | APPD |
|-----|-----------|-------------|------|---------|------|
| | | | | | |

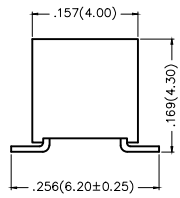

Electrical
 Current Rating: 2A AC(rms)/DC
 Voltage Rating: 250V AC(rms)/DC
 Contact Resistance: 20 mΩ Max
 Insulation Resistance: 500 MΩ MIN
 Withstanding Voltage: 100V AC r.m.s
 Temperature Range—Operating: -25°C~+85°C

Material and Plating
 Housing: PA6T(UL 94V-0)
 Contact Pin: Brass
 Plating: Gold Plated/Selective gold in contact area, tin on tail

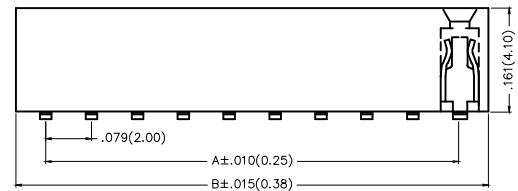
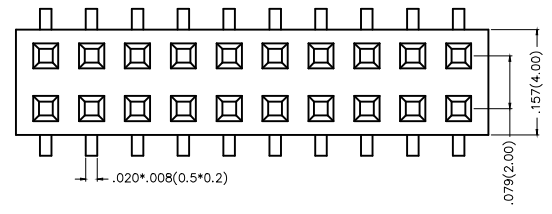

Packing: M—Reel(With Cap)

Packing: M1—Reel(With Mylar)

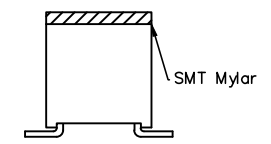
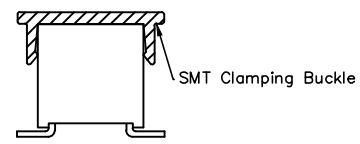

Ordering Information

FFH 200 05 — D XX S X XX 4 K6 XX
 1 2 3 4 5 6 7 8 9 10 11

| | | | | | | | | | | | |
|---|---|---|--|---|--------------------------|----|----------------------------|----|--|---|--------------------------------|
| 1 | Category FFH—Female Header | 2 | Series Number 200—Pitch 2.00mm | 3 | Distinction No. 05 | 4 | Row Option D—Double Row | 5 | Circuits XX | 6 | Entry Angle S—180° Vertical |
| 7 | Plating 1—Gold Plated 3—Selective gold in contact area, tin on tail | 8 | Thickness of Plating 00—Gold Flash 05—5μ Custom plate available | 9 | Material—Resin 4—PA6T | 10 | Color—Resin K6—Black | 11 | Packaging M—Reel(With Cap) M1—Reel(With Mylar) L—Tube | | |

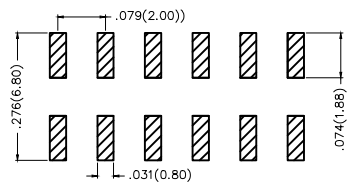

Recommended P.C.Board Layout

| | | | | | | | |
|------------------------|---------------------------------------|--|--|----------------------|---|---|--|
| THIRD ANGLE PROJECTION | GENERAL TOLERANCES (UNLESS SPECIFIED) | | APPROVE BY FRANK | DATE 23/JUL/13 | PART NO. FFH20005—DXXSXX4K6XX | ITEM NO. FFH20005 | |
| | DESIGN UNITS Inch (metric) | X.±.012(0.30) X.X±.008(0.20) X.XX±.006(0.15) X.XXX±.004(0.10) | X.±5° .X'±2° .XX'±1° .XXX'±0.5' | CHECKED BY CHERRY | DATE 23/JUL/13 | TITLE Board to Board (Female Header) Pitch 2.00mm 180° Vertical (SMT) | |
| SCALE 5:1 | SIZE A4 | DRAWN BY JACOB | | DATE 23/JUL/13 | THIS DRAWING CONTAINS INFORMATION THAT IS PROPRIETARY TO DONG GUAN LANG LUN(3K-KAMING) ELECTRONIC PRODUCTS CO.,LTD. AND SHOULD NOT BE USED WITHOUT WRITTEN PERMISSION | | |

| | | | | | |
|-----|-----------|-------------|------|---------|------|
| REV | LOCATIONS | DESCRIPTION | DATE | REVISER | APPD |
| | | | | | |



| Circuits (n) | Part No. | Dimensions(in/mm) | | Circuits (n) | Part No. | Dimensions(in/mm) | |
|--------------|-----------------------|-------------------|--------------|--------------|-----------------------|-------------------|--------------|
| | | A | B | | | A | B |
| 4 | FFH20005-D04SXXX4K6XX | .079(2.00) | .177(4.50) | 44 | FFH20005-D44SXXX4K6XX | 1.654(42.00) | 1.752(44.50) |
| 6 | FFH20005-D06SXXX4K6XX | .157(4.00) | .256(6.50) | 46 | FFH20005-D46SXXX4K6XX | 1.732(44.00) | 1.831(46.50) |
| 8 | FFH20005-D08SXXX4K6XX | .236(6.00) | .335(8.50) | 48 | FFH20005-D48SXXX4K6XX | 1.811(46.00) | 1.909(48.50) |
| 10 | FFH20005-D10SXXX4K6XX | .315(8.00) | .413(10.50) | 50 | FFH20005-D50SXXX4K6XX | 1.890(48.00) | 1.988(50.50) |
| 12 | FFH20005-D12SXXX4K6XX | .394(10.00) | .492(12.50) | 52 | FFH20005-D52SXXX4K6XX | 1.969(50.00) | 2.067(52.50) |
| 14 | FFH20005-D14SXXX4K6XX | .472(12.00) | .571(14.50) | 54 | FFH20005-D54SXXX4K6XX | 2.047(52.00) | 2.146(54.50) |
| 16 | FFH20005-D16SXXX4K6XX | .551(14.00) | .650(16.50) | 56 | FFH20005-D56SXXX4K6XX | 2.126(54.00) | 2.224(56.50) |
| 18 | FFH20005-D18SXXX4K6XX | .630(16.00) | .728(18.50) | 58 | FFH20005-D58SXXX4K6XX | 2.205(56.00) | 2.303(58.50) |
| 20 | FFH20005-D20SXXX4K6XX | .709(18.00) | .807(20.50) | 60 | FFH20005-D60SXXX4K6XX | 2.283(58.00) | 2.382(60.50) |
| 22 | FFH20005-D22SXXX4K6XX | .787(20.00) | .886(22.50) | 62 | FFH20005-D62SXXX4K6XX | 2.362(60.00) | 2.460(62.50) |
| 24 | FFH20005-D24SXXX4K6XX | .866(22.00) | .965(24.50) | 64 | FFH20005-D64SXXX4K6XX | 2.441(62.00) | 2.539(64.50) |
| 26 | FFH20005-D26SXXX4K6XX | .845(24.00) | 1.043(26.50) | 66 | FFH20005-D66SXXX4K6XX | 2.520(64.00) | 2.618(66.50) |
| 28 | FFH20005-D28SXXX4K6XX | 1.024(26.00) | 1.122(28.50) | 68 | FFH20005-D68SXXX4K6XX | 2.598(66.00) | 2.697(68.50) |
| 30 | FFH20005-D30SXXX4K6XX | 1.102(28.00) | 1.201(30.50) | 70 | FFH20005-D70SXXX4K6XX | 2.677(68.00) | 2.776(70.50) |
| 32 | FFH20005-D32SXXX4K6XX | 1.181(30.00) | 1.280(32.50) | 72 | FFH20005-D72SXXX4K6XX | 2.756(70.00) | 2.854(72.50) |
| 34 | FFH20005-D34SXXX4K6XX | 1.260(32.00) | 1.358(34.50) | 74 | FFH20005-D74SXXX4K6XX | 2.835(72.00) | 2.933(74.50) |
| 36 | FFH20005-D36SXXX4K6XX | 1.339(34.00) | 1.437(36.50) | 76 | FFH20005-D76SXXX4K6XX | 2.913(74.00) | 3.012(76.50) |
| 38 | FFH20005-D38SXXX4K6XX | 1.417(36.00) | 1.516(38.50) | 78 | FFH20005-D78SXXX4K6XX | 2.992(76.00) | 3.091(78.50) |
| 40 | FFH20005-D40SXXX4K6XX | 1.496(38.00) | 1.594(40.50) | 80 | FFH20005-D80SXXX4K6XX | 3.071(78.00) | 3.169(80.50) |
| 42 | FFH20005-D42SXXX4K6XX | 1.575(40.00) | 1.673(42.50) | | | | |



| | | | | | | | |
|-------------------------------|---------------------------------------|-----------|------------|-----------|---|----------|------------------------|
| THIRD ANGLE PROJECTION | GENERAL TOLERANCES (UNLESS SPECIFIED) | | APPROVE BY | DATE | PART NO. | ITEM NO. | 3K-KAMING® |
| | X.±.012(0.30) | X.±5' | FRANK | 23/JUL/13 | FFH20005-DXXSXXX4K6XX | FFH20005 | |
| DESIGN UNITS Inch (metric) | X.X±.008(0.20) | .X±2' | CHECKED BY | DATE | TITLE | | REV 0 SHEET NO. 1/1 |
| SCALE SIZE | X.XX±.006(0.15) | .XX±1' | CHERRY | 23/JUL/13 | Board to Board (Female Header) Pitch 2.00mm 180° Vertical (SMT) | | |
| 5:1 A4 | X.XXX±.004(0.10) | .XXX±0.5' | DRAWN BY | DATE | THIS DRAWING CONTAINS INFORMATION THAT IS PROPRIETARY TO DONG GUAN LANG LUN(3K-KAMING) ELECTRONIC PRODUCTS CO.,LTD. AND SHOULD NOT BE USED WITHOUT WRITTEN PERMISSION | | |
| | | | JACOB | 23/JUL/13 | | | |

| REV | LOCATIONS | DESCRIPTION | DATE | REVISER | APPD |
|-----|-----------|---------------------------------------|----------|---------|------|
| 1 | △ | Part NO. FFH20004 Change to FFH20005A | 20150901 | CHERRY | FAN |



Electrical
 Current Rating: 2A AC(rms)/DC
 Voltage Rating: 250V AC(rms)/DC
 Contact Resistance: 20 mΩ Max
 Insulation Resistance: 500 MΩ MIN
 Withstanding Voltage: 100V AC r.m.s
 Temperature Range—Operating: -25°C~+85°C
 Material and Plating
 Housing: PA6T(UL 94V-0)
 Contact Pin: Brass
 Plating: Gold Plated/Selective gold in contact area, tin on tail

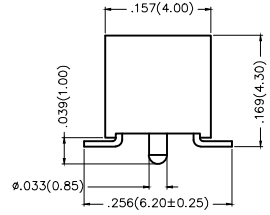
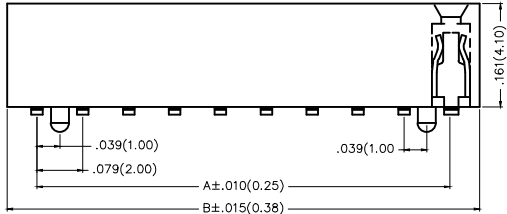
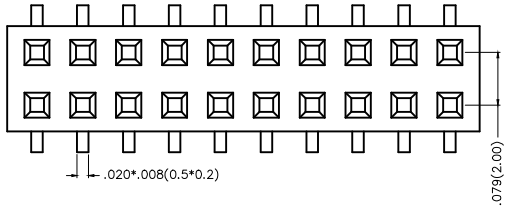

Packing: M—Reel(With Cap)

Packing: M1—Reel(With Mylar)

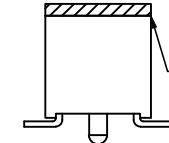
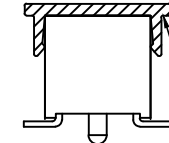

Ordering Information

FFH 200 05 — D XX S X XX 4 K6 XX A
 1 2 3 4 5 6 7 8 9 10 11 12

| | | | | | |
|---|---|----------------------------|------------------------------|---|----------------------------------|
| 1 Category FFH—Female Header | 2 Series Number 200—Pitch2.00mm | 3 Distinction No. 05 | 4 Row Option D—Double Row | 5 Circuits XX | 6 Entry Angle S—180° Vertical |
| 7 Plating 1—Gold Plated 3—Selective gold in contact area, tin on tail | 8 Thickness of Plating 00—Gold Flash 05—5μ" Custom plate available | 9 Material—Resin 4—PA6T | 10 Color—Resin K6—Black | 11 Packaging M—Reel(With Cap) M1—Reel(With Mylar) L—Tube | 12 Type A—With Position |

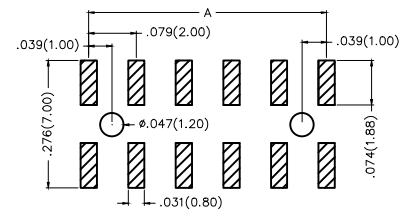

Recommended P.C.Board Layout

| | | | | | | | |
|------------------------|---------------------------------------|--|--|----------------------|---|--|--|
| THIRD ANGLE PROJECTION | GENERAL TOLERANCES (UNLESS SPECIFIED) | | APPROVE BY FRANK | DATE 23/JUL/13 | PART NO. △ FFH20005-DXXSXXX4K6XXA | ITEM NO. FFH20005 | |
| | DESIGN UNITS Inch (metric) | X.±.012(0.30) X.X±.008(0.20) X.XX±.006(0.15) X.XXX±.004(0.10) | X.±5° .X'±2° .XX'±1° .XXX'±0.5' | CHECKED BY CHERRY | DATE 23/JUL/13 | TITLE Board to Board (Female Header) Pitch 2.0mm 180° Vertical (SMT) | |
| SCALE 5:1 | SIZE A4 | DRAWN BY JACOB | | DATE 23/JUL/13 | THIS DRAWING CONTAINS INFORMATION THAT IS PROPRIETARY TO DONG GUAN LANG LUN(3K-KAMING) ELECTRONIC PRODUCTS CO.,LTD. AND SHOULD NOT BE USED WITHOUT WRITTEN PERMISSION | | |

| REV | LOCATIONS | DESCRIPTION | DATE | REVISER | APPD |
|-----|-----------|-------------|------|---------|------|
| | | | | | |



| Circuits (n) | Part No. | Dimensions(in/mm) | | Circuits (n) | Part No. | Dimensions(in/mm) | |
|--------------|------------------------|-------------------|--------------|--------------|------------------------|-------------------|--------------|
| | | A | B | | | A | B |
| 4 | FFH20005-D04SXXX4K6XXA | .079(2.00) | .177(4.50) | 44 | FFH20005-D44SXXX4K6XXA | 1.654(42.00) | 1.752(44.50) |
| 6 | FFH20005-D06SXXX4K6XXA | .157(4.00) | .256(6.50) | 46 | FFH20005-D46SXXX4K6XXA | 1.732(44.00) | 1.831(46.50) |
| 8 | FFH20005-D08SXXX4K6XXA | .236(6.00) | .335(8.50) | 48 | FFH20005-D48SXXX4K6XXA | 1.811(46.00) | 1.909(48.50) |
| 10 | FFH20005-D10SXXX4K6XXA | .315(8.00) | .413(10.50) | 50 | FFH20005-D50SXXX4K6XXA | 1.890(48.00) | 1.988(50.50) |
| 12 | FFH20005-D12SXXX4K6XXA | .394(10.00) | .492(12.50) | 52 | FFH20005-D52SXXX4K6XXA | 1.969(50.00) | 2.067(52.50) |
| 14 | FFH20005-D14SXXX4K6XXA | .472(12.00) | .571(14.50) | 54 | FFH20005-D54SXXX4K6XXA | 2.047(52.00) | 2.146(54.50) |
| 16 | FFH20005-D16SXXX4K6XXA | .551(14.00) | .650(16.50) | 56 | FFH20005-D56SXXX4K6XXA | 2.126(54.00) | 2.224(56.50) |
| 18 | FFH20005-D18SXXX4K6XXA | .630(16.00) | .728(18.50) | 58 | FFH20005-D58SXXX4K6XXA | 2.205(56.00) | 2.303(58.50) |
| 20 | FFH20005-D20SXXX4K6XXA | .709(18.00) | .807(20.50) | 60 | FFH20005-D60SXXX4K6XXA | 2.283(58.00) | 2.382(60.50) |
| 22 | FFH20005-D22SXXX4K6XXA | .787(20.00) | .886(22.50) | 62 | FFH20005-D62SXXX4K6XXA | 2.362(60.00) | 2.460(62.50) |
| 24 | FFH20005-D24SXXX4K6XXA | .866(22.00) | .965(24.50) | 64 | FFH20005-D64SXXX4K6XXA | 2.441(62.00) | 2.539(64.50) |
| 26 | FFH20005-D26SXXX4K6XXA | .845(24.00) | 1.043(26.50) | 66 | FFH20005-D66SXXX4K6XXA | 2.520(64.00) | 2.618(66.50) |
| 28 | FFH20005-D28SXXX4K6XXA | 1.024(26.00) | 1.122(28.50) | 68 | FFH20005-D68SXXX4K6XXA | 2.598(66.00) | 2.697(68.50) |
| 30 | FFH20005-D30SXXX4K6XXA | 1.102(28.00) | 1.201(30.50) | 70 | FFH20005-D70SXXX4K6XXA | 2.677(68.00) | 2.776(70.50) |
| 32 | FFH20005-D32SXXX4K6XXA | 1.181(30.00) | 1.280(32.50) | 72 | FFH20005-D72SXXX4K6XXA | 2.756(70.00) | 2.854(72.50) |
| 34 | FFH20005-D34SXXX4K6XXA | 1.260(32.00) | 1.358(34.50) | 74 | FFH20005-D74SXXX4K6XXA | 2.835(72.00) | 2.933(74.50) |
| 36 | FFH20005-D36SXXX4K6XXA | 1.339(34.00) | 1.437(36.50) | 76 | FFH20005-D76SXXX4K6XXA | 2.913(74.00) | 3.012(76.50) |
| 38 | FFH20005-D38SXXX4K6XXA | 1.417(36.00) | 1.516(38.50) | 78 | FFH20005-D78SXXX4K6XXA | 2.992(76.00) | 3.091(78.50) |
| 40 | FFH20005-D40SXXX4K6XXA | 1.496(38.00) | 1.594(40.50) | 80 | FFH20005-D80SXXX4K6XXA | 3.071(78.00) | 3.169(80.50) |
| 42 | FFH20005-D42SXXX4K6XXA | 1.575(40.00) | 1.673(42.50) | | | | |



| | | | | | | | |
|-------------------------------|--|------------------|---------------------|----------------------|------------------------------------|--|----------------|
| THIRD ANGLE PROJECTION | GENERAL TOLERANCES (UNLESS SPECIFIED) | | APPROVE BY FRANK | DATE 23/JUL/13 | PART NO. FFH20005-DXXSXXX4K6XXA | ITEM NO. FFH20005 | 3K-KAMING® |
| | DESIGN UNITS Inch (metric) | X.±.012(0.30) | X.±5' | CHECKED BY CHERRY | DATE 23/JUL/13 | TITLE Board to Board (Female Header) Pitch 2.00mm 180° Vertical (SMT) | |
| SCALE 5:1 | SIZE A4 | X.XX±.006(0.15) | .XX±1' | DRAWN BY JACOB | DATE 23/JUL/13 | THIS DRAWING CONTAINS INFORMATION THAT IS PROPRIETARY TO DONG GUAN LANG LUN(3K-KAMING) ELECTRONIC PRODUCTS CO.,LTD. AND SHOULD NOT BE USED WITHOUT WRITTEN PERMISSION | |
| | | X.XXX±.004(0.10) | .XXX±0.5' | | | REV 1 | SHEET NO. 2/2 |