

REV	LOCATIONS	DESCRIPTION	DATE	REVISER	APPD

A  
B  
C  
D  
E  
F

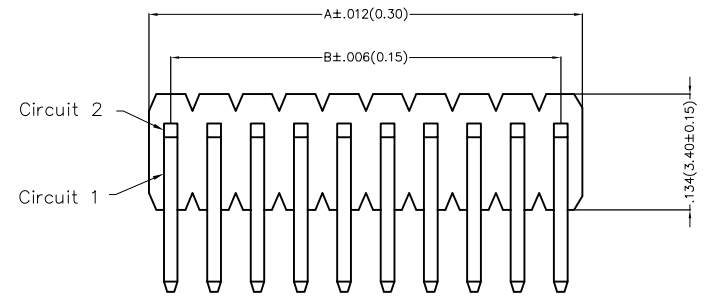

**SPECIFICATIONS**

**Electrical**  
 Current Rating: 1.0A AC(rms)/DC  
 Contact Resistance: 20 mΩ Max  
 Insulation Resistance: 1000 MΩ MIN  
 Withstanding Voltage: 500V AC/Minute  
 Operating Temperature: -40°C~+105°C

**Material**  
 Housing: PA6T/PBT, UL 94V-0  
 Pin: Brass  
 Pin Plating: Gold plated/ Selective gold plated on contact area and 120μ" Min. matte tin plated on tails area

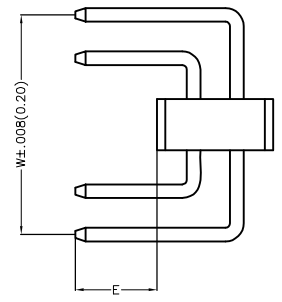
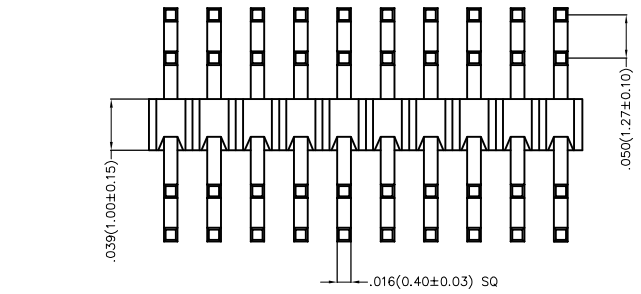

**Ordering Information**

FPH 1 27 44 - D XX B X XX X XX XX 00 B  
 1 2 3 4 5 6 7 8 9 10 11 12

1   <b>Category</b> FPH-Pin Header	2   <b>Series Number</b> 127-Pitch1.27mm	3   <b>Distinction No.</b> 44	4   <b>Row Option</b> D-Double Row	5   <b>Circuits</b> XX	6   <b>Entry Angle</b> B-90° Angle
7   <b>Plating</b> 1-Gold plated 7-Selective gold plated on contact area and matte tin plated on tails area	8   <b>Thickness of Plating</b> 01-1μ" 15-15μ" Custom plate available	9   <b>Material-Resin</b> 1-PBT 4-PA6T	10   <b>E Size</b> 01,02...-Serial number (See Table1)	11   <b>W Size</b> 01,02...-Serial number (See Table1)	12   <b>Packaging</b> B-PE Bag

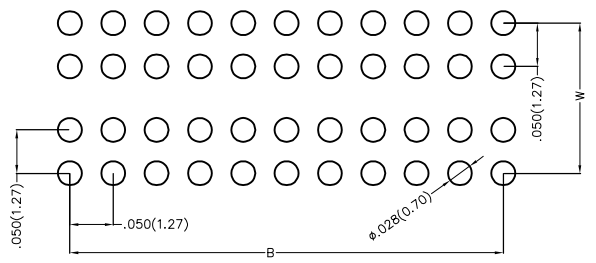

**Recommended P.C.Board Layout**  
 Tolerances: ±.002(0.05)

 THIRD ANGLE PROJECTION DESIGN UNITS Inch (metric) SCALE 5:1 SIZE A<	GENERAL TOLERANCES (UNLESS SPECIFIED)		APPROVE BY FRANK	DATE 17/DEC/19	PART NO. FPH12744-DXXBXXXXXXXXX00B	ITEM NO. FPH12744	 3K-KAMING REV 0 SHEET NO. 1/3
	X.±.012(0.30)	X.'±5'	CHECKED BY CHERRY	DATE 17/DEC/19	TITLE Board to Board(Pin Header) Pitch 1.27mm 90° Angle(DIP)		
	X.X±.008(0.20)	.X'±2'	DRAWN BY ZOEY	DATE 17/DEC/19	THIS DRAWING CONTAINS INFORMATION THAT IS PROPRIETARY TO DONG GUAN LANG LUN(3K-KAMING) ELECTRONIC PRODUCTS CO., LTD. AND SHOULD NOT BE USED WITHOUT WRITTEN PERMISSION		
	X.XX±.006(0.15)	.XX'±1'					

A  
B  
C  
D  
E  
F

1 2 3 4 5 6 7 8

REV	LOCATIONS	DESCRIPTION	DATE	REVISED	APPD

Table1

Serial number	Dimensions(in/mm) E	Serial number	Dimensions(in/mm) E
01	.059(1.50)	19	.236(6.00)
02	.069(1.75)	20	.246(6.25)
03	.079(2.00)	21	.256(6.50)
04	.089(2.25)	22	.266(6.75)
05	.098(2.50)	23	.276(7.00)
06	.108(2.75)	24	.285(7.25)
07	.118(3.00)	25	.295(7.50)
08	.128(3.25)	26	.305(7.75)
09	.138(3.50)	27	.315(8.00)
10	.148(3.75)	28	.325(8.25)
11	.157(4.00)	29	.335(8.50)
12	.167(4.25)	30	.344(8.75)
13	.177(4.50)	31	.354(9.00)
14	.187(4.75)	32	.364(9.25)
15	.197(5.00)	33	.374(9.50)
16	.207(5.25)	34	.384(9.75)
17	.217(5.50)	35	.394(10.00)
18	.226(5.75)		

Serial number	Dimensions(in/mm) W	Serial number	Dimensions(in/mm) W
01	.217(5.50)	19	.394(10.00)
02	.226(5.75)	20	.404(10.25)
03	.236(6.00)	21	.413(10.50)
04	.246(6.25)	22	.423(10.75)
05	.256(6.50)	23	.433(11.00)
06	.266(6.75)	24	.443(11.25)
07	.276(7.00)	25	.453(11.50)
08	.285(7.25)	26	.463(11.75)
09	.295(7.50)	27	.472(12.00)
10	.305(7.75)		
11	.315(8.00)		
12	.325(8.25)		
13	.335(8.50)		
14	.344(8.75)		
15	.354(9.00)		
16	.364(9.25)		
17	.374(9.50)		
18	.384(9.75)		

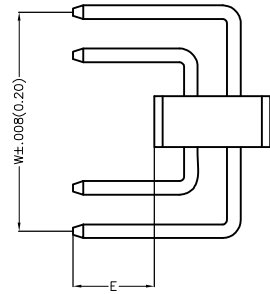

<p>THIRD ANGLE PROJECTION</p>	GENERAL TOLERANCES (UNLESS SPECIFIED)		APPROVE BY	DATE	PART NO.	ITEM NO.	<p>3K-KAMING</p>
	X.±.012(0.30)	X.±5'	FRANK	17/DEC/19	FPH12744-DXXBXXXXXXXXX00B	FPH12744	
	X.X±.008(0.20)	.X'±2'	CHECKED BY	DATE	TITLE Board to Board(Pin Header) Pitch 1.27mm 90° Angle(DIP)		
	X.XX±.006(0.15)	.XX'±1'	CHERRY	17/DEC/19	REV 0	SHEET NO. 2/3	
SCALE	SIZE	X.XXX±.004(0.10)	.XXX'±0.5'	DRAWN BY	DATE	THIS DRAWING CONTAINS INFORMATION THAT IS PROPRIETARY TO DONG GUAN LANG LUN(3K-KAMING) ELECTRONIC PRODUCTS CO., LTD. AND SHOULD NOT BE USED WITHOUT WRITTEN PERMISSION	
5:1	A4			ZOEY	17/DEC/19		

1

2

3

4

5

6

7

8

REV	LOCATIONS	DESCRIPTION	DATE	REVISER	APPD

A

B

C

D

E

F

A

B

C

D

E

F



Circuits (n)	Part No.	Dimensions(in/mm)		Circuits (n)	Part No.	Dimensions(in/mm)	
		A	B			A	B
2	FPH12744-D02BXXXXXXXX00B	--	.100(2.54)	52	FPH12744-D52BXXXXXXXX00B	1.250(31.75)	2.600(66.04)
4	FPH12744-D04BXXXXXXXX00B	.100(1.27)	.200(5.08)	54	FPH12744-D54BXXXXXXXX00B	1.300(33.02)	2.700(68.58)
6	FPH12744-D06BXXXXXXXX00B	.100(2.54)	.300(7.62)	56	FPH12744-D56BXXXXXXXX00B	1.350(34.29)	2.800(71.12)
8	FPH12744-D08BXXXXXXXX00B	.150(3.81)	.400(10.16)	58	FPH12744-D58BXXXXXXXX00B	1.400(35.56)	2.900(73.66)
10	FPH12744-D10BXXXXXXXX00B	.200(5.08)	.500(12.70)	60	FPH12744-D60BXXXXXXXX00B	1.450(36.83)	3.000(76.20)
12	FPH12744-D12BXXXXXXXX00B	.250(6.35)	.600(15.24)	62	FPH12744-D62BXXXXXXXX00B	1.500(38.10)	3.100(78.74)
14	FPH12744-D14BXXXXXXXX00B	.300(7.62)	.700(17.78)	64	FPH12744-D64BXXXXXXXX00B	1.550(39.37)	3.200(81.28)
16	FPH12744-D16BXXXXXXXX00B	.350(8.89)	.800(20.32)	66	FPH12744-D66BXXXXXXXX00B	1.600(40.64)	3.300(83.82)
18	FPH12744-D18BXXXXXXXX00B	.400(10.16)	.900(22.86)	68	FPH12744-D68BXXXXXXXX00B	1.650(41.91)	3.400(86.36)
20	FPH12744-D20BXXXXXXXX00B	.450(11.43)	1.000(25.40)	70	FPH12744-D70BXXXXXXXX00B	1.700(43.18)	3.500(88.90)
22	FPH12744-D22BXXXXXXXX00B	.500(12.70)	1.100(27.94)	72	FPH12744-D72BXXXXXXXX00B	1.750(44.45)	3.600(91.44)
24	FPH12744-D24BXXXXXXXX00B	.550(13.97)	1.200(30.48)	74	FPH12744-D74BXXXXXXXX00B	1.800(45.72)	3.700(93.98)
26	FPH12744-D26BXXXXXXXX00B	.600(15.24)	1.300(33.02)	76	FPH12744-D76BXXXXXXXX00B	1.850(46.99)	3.800(96.52)
28	FPH12744-D28BXXXXXXXX00B	.650(16.51)	1.400(35.56)	78	FPH12744-D78BXXXXXXXX00B	1.900(48.26)	3.900(99.06)
30	FPH12744-D30BXXXXXXXX00B	.700(17.78)	1.500(38.10)	80	FPH12744-D80BXXXXXXXX00B	1.950(49.53)	4.000(101.60)
32	FPH12744-D32BXXXXXXXX00B	.750(19.05)	1.600(40.64)	82	FPH12744-D82BXXXXXXXX00B	2.000(50.80)	4.100(104.14)
34	FPH12744-D34BXXXXXXXX00B	.800(20.32)	1.700(43.18)	84	FPH12744-D84BXXXXXXXX00B	2.050(52.07)	4.200(106.68)
36	FPH12744-D36BXXXXXXXX00B	.850(21.59)	1.800(45.72)	86	FPH12744-D86BXXXXXXXX00B	2.100(53.34)	4.300(109.22)
38	FPH12744-D38BXXXXXXXX00B	.900(22.86)	1.900(48.26)	88	FPH12744-D88BXXXXXXXX00B	2.150(54.61)	4.400(111.76)
40	FPH12744-D40BXXXXXXXX00B	.950(24.13)	2.00(50.80)	90	FPH12744-D90BXXXXXXXX00B	2.200(55.88)	4.500(114.30)
42	FPH12744-D42BXXXXXXXX00B	1.000(25.40)	2.100(53.34)	92	FPH12744-D92BXXXXXXXX00B	2.250(57.15)	4.600(116.84)
44	FPH12744-D44BXXXXXXXX00B	1.050(26.67)	2.200(55.88)	94	FPH12744-D94BXXXXXXXX00B	2.300(58.42)	4.700(119.38)
46	FPH12744-D46BXXXXXXXX00B	1.100(27.94)	2.300(58.42)	96	FPH12744-D96BXXXXXXXX00B	2.350(59.69)	4.800(121.92)
48	FPH12744-D48BXXXXXXXX00B	1.150(29.21)	2.400(60.96)	98	FPH12744-D98BXXXXXXXX00B	2.400(60.96)	4.900(124.46)
50	FPH12744-D50BXXXXXXXX00B	1.200(30.48)	2.500(63.50)	100	FPH12744-D100BXXXXXXXX00B	2.450(62.23)	5.000(127.00)



<p>THIRD ANGLE PROJECTION</p>	GENERAL TOLERANCES (UNLESS SPECIFIED)		APPROVE BY FRANK	DATE 17/DEC/19	PART NO. FPH12744-DXXBXXXXXXXX00B	ITEM NO. FPH12744	<p>3K-KAMING</p>	
	X.±.012(0.30)	X.±5'	CHECKED BY CHERRY	DATE 17/DEC/19	TITLE Board to Board(Pin Header) Pitch 1.27mm 90° Angle(DIP)			REV 0 SHEET NO. 3/3
	DESIGN UNITS Inch (metric)	X.X±.008(0.20)	X.±2'	DRAWN BY ZOEY	DATE 17/DEC/19	THIS DRAWING CONTAINS INFORMATION THAT IS PROPRIETARY TO DONG GUAN LANG LUN(3K-KAMING) ELECTRONIC PRODUCTS CO.,LTD. AND SHOULD NOT BE USED WITHOUT WRITTEN PERMISSION		
	SCALE 5:1	SIZE A<	X.XX±.006(0.15)	X.X±1'	X.XXX±.004(0.10)	X.XX±0.5'		

1

2

3

4

5

6

7

8