

REV	LOCATIONS	DESCRIPTION	DATE	REVISER	APPD
1	▲	Old: .016*.006(0.4*0.15) New: .018*.006(0.45*0.15)	10/OCT/14	KTAE	FRANK

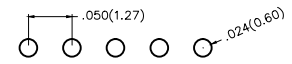

Electrical
 Current Rating: 1A AC(rms)/DC
 Voltage Rating: 250V AC(rms)/DC
 Contact Resistance: 20 mΩ Max
 Insulation Resistance: 500 MΩ MIN
 Withstanding Voltage: 100V AC r.m.s
 Temperature Range-Operating: -25°C ~ +85°C

Material and Plating
 Housing: PA6T(UL 94V-0)
 Contact Pin: Phosphor Bronze
 Plating: Gold Plated/Selective gold in contact area,
 matte(bright) tin on tail

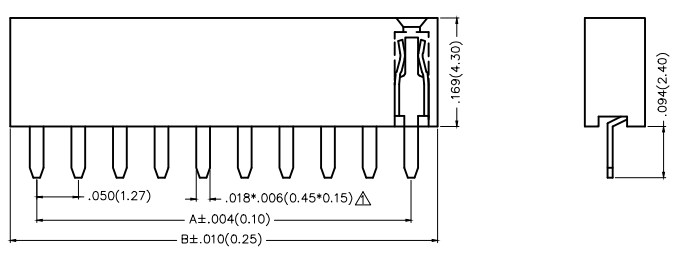
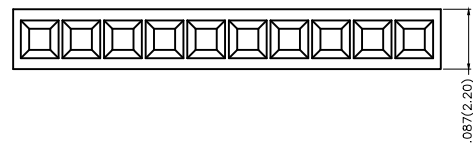

Recommended P.C.Board Layout

Ordering Information

FFH 127 02 - S XX S X XX 4 K6 K
 1 2 3 4 5 6 7 8 9 10 11

- | | | | | | |
|---|--|-----------------------------------|-------------------------------------|-------------------------------|---|
| 1 <u>Category</u>
FFH-Female Header | 2 <u>Series Number</u>
127-Pitch1.27mm | 3 <u>Distinction No.</u>
02 | 4 <u>Row Option</u>
S-Single Row | 5 <u>Circuits</u>
XX | 6 <u>Entry Angle</u>
S-180° Vertical |
| 7 <u>Plating</u>
1-Gold Plated
3-Selective gold in contact area,
matte(bright) tin on tail | 8 <u>Thickness of Plating</u>
00-Gold Flash
05-5μ"
Custom plate available | 9 <u>Material-Resin</u>
4-PA6T | 10 <u>Color-Resin</u>
Black-K6 | 11 <u>Packaging</u>
Tray-K | |

 THIRD ANGLE PROJECTION	GENERAL TOLERANCES (UNLESS SPECIFIED)		APPROVE BY FRANK	DATE 10/JUL/13	PART NO. FFH12702-SXXSXXX4K6K	ITEM NO. FFH12702	 3K-KAMING
	DESIGN UNITS Inch (metric)	X.X±.012(0.30)	.X'±5'	CHECKED BY CHERRY	DATE 10/JUL/13	TITLE Board to Board (Female Header) Pitch 1.27mm 180° Vertical (DIP)	
SCALE 5:1	SIZE A4	X.XX±.006(0.15)	.XX'±1'	DRAWN BY JACOB	DATE 10/JUL/13	THIS DRAWING CONTAINS INFORMATION THAT IS PROPRIETARY TO DONG GUAN LANG LUN(3K-KAMING) ELECTRONIC PRODUCTS CO.,LTD. AND SHOULD NOT BE USED WITHOUT WRITTEN PERMISSION	REV 1 SHEET NO. 1/2

REV	LOCATIONS	DESCRIPTION	DATE	REVISER	APPD
1	△	Old: .016*.006(0.4*0.15) New: .018*.006(0.45*0.15)	10/OCT/14	KTAE	FRANK



Circuits (n)	Part No.	Dimensions(in/mm)		Circuits (n)	Part No.	Dimensions(in/mm)	
		A	B			A	B
3	FFH12702-S03SXXX4K6K	.100(2.54)	.164(4.16)	22	FFH12702-S22SXXX4K6K	1.050(26.67)	1.114(28.29)
4	FFH12702-S04SXXX4K6K	.150(3.81)	.214(5.43)	23	FFH12702-S23SXXX4K6K	1.100(27.94)	1.164(29.56)
5	FFH12702-S05SXXX4K6K	.200(5.08)	.264(6.70)	24	FFH12702-S24SXXX4K6K	1.150(29.21)	1.214(30.83)
6	FFH12702-S06SXXX4K6K	.250(6.35)	.314(7.97)	25	FFH12702-S25SXXX4K6K	1.200(30.48)	1.264(32.10)
7	FFH12702-S07SXXX4K6K	.300(7.62)	.364(9.24)	26	FFH12702-S26SXXX4K6K	1.250(31.75)	1.314(33.37)
8	FFH12702-S08SXXX4K6K	.350(8.89)	.414(10.51)	27	FFH12702-S27SXXX4K6K	1.300(33.02)	1.364(34.64)
9	FFH12702-S09SXXX4K6K	.400(10.16)	.464(11.78)	28	FFH12702-S28SXXX4K6K	1.350(34.29)	1.414(35.91)
10	FFH12702-S10SXXX4K6K	.450(11.43)	.514(13.05)	29	FFH12702-S29SXXX4K6K	1.400(35.56)	1.464(37.18)
11	FFH12702-S11SXXX4K6K	.500(12.70)	.564(14.32)	30	FFH12702-S30SXXX4K6K	1.450(36.83)	1.514(38.45)
12	FFH12702-S12SXXX4K6K	.550(13.97)	.614(15.59)	31	FFH12702-S31SXXX4K6K	1.500(38.10)	1.564(39.72)
13	FFH12702-S13SXXX4K6K	.600(15.24)	.664(16.86)	32	FFH12702-S32SXXX4K6K	1.550(39.37)	1.614(40.99)
14	FFH12702-S14SXXX4K6K	.650(16.51)	.714(18.13)	33	FFH12702-S33SXXX4K6K	1.600(40.64)	1.664(42.26)
15	FFH12702-S15SXXX4K6K	.700(17.78)	.764(19.40)	34	FFH12702-S34SXXX4K6K	1.650(41.91)	1.714(43.53)
16	FFH12702-S16SXXX4K6K	.750(19.05)	.814(20.67)	35	FFH12702-S35SXXX4K6K	1.700(43.18)	1.764(44.80)
17	FFH12702-S17SXXX4K6K	.800(20.32)	.864(21.94)	36	FFH12702-S36SXXX4K6K	1.750(44.45)	1.814(46.07)
18	FFH12702-S18SXXX4K6K	.850(21.59)	.914(23.21)	37	FFH12702-S37SXXX4K6K	1.800(45.72)	1.864(47.34)
19	FFH12702-S19SXXX4K6K	.900(22.86)	.964(24.48)	38	FFH12702-S38SXXX4K6K	1.850(46.99)	1.914(48.61)
20	FFH12702-S20SXXX4K6K	.950(24.13)	1.014(25.75)	39	FFH12702-S39SXXX4K6K	1.900(48.26)	1.964(49.88)
21	FFH12702-S21SXXX4K6K	1.000(25.40)	1.064(27.02)	40	FFH12702-S40SXXX4K6K	1.950(49.53)	2.014(51.55)



 THIRD ANGLE PROJECTION	GENERAL TOLERANCES (UNLESS SPECIFIED)		APPROVE BY FRANK	DATE 10/JUL/13	PART NO. FFH12702-SXXSXXX4K6K	ITEM NO. FFH12702	 3K-KAMING
	X.±0.012(0.30)	X.±5'	CHECKED BY CHERRY	DATE 10/JUL/13	TITLE Board to Board (Female Header) Pitch 1.27mm 180° Vertical (DIP)		
DESIGN UNITS Inch (metric)	X.XX±.008(0.20)	.X'±2'	DRAWN BY JACOB	DATE 10/JUL/13	THIS DRAWING CONTAINS INFORMATION THAT IS PROPRIETARY TO DONG GUAN LANG LUN(3K-KAMING) ELECTRONIC PRODUCTS CO., LTD. AND SHOULD NOT BE USED WITHOUT WRITTEN PERMISSION		
SCALE 5:1	SIZE A4	X.XX±.006(0.15)	.XX'±1'				
		X.XXX±.004(0.10)	.XXX'±0.5'				

REV	LOCATIONS	DESCRIPTION	DATE	REVISER	APPD
1	△	Size change	10/OCT/14	KTAE	FRANK



Electrical
 Current Rating: 1A AC(rms)/DC
 Voltage Rating: 250V AC(rms)/DC
 Contact Resistance: 20 mΩ Max
 Insulation Resistance: 500 MΩ MIN
 Withstanding Voltage: 100V AC r.m.s
 Temperature Range—Operating: -25°C~+85°C

Material and Plating
 Housing: PA6T(UL 94V-0)
 Contact Pin: Phosphor Bronze
 Plating: Gold Plated/Selective gold in contact area, matte(bright) tin on tail

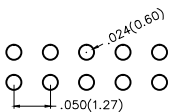
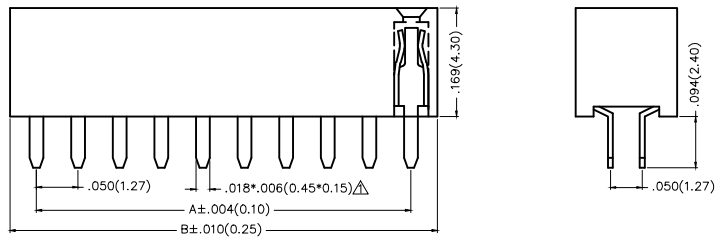
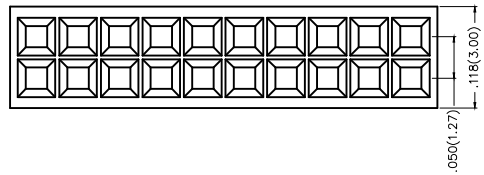

Recommended P.C.Board Layout



Ordering Information

FFH 127 02 - D XX S X XX 4 K6 X
 1 2 3 4 5 6 7 8 9 10 11

1 Category FFH—Female Header	2 Series Number 127—Pitch1.27mm	3 Distinction No. 02	4 Row Option D—Double Row	5 Circuits XX	6 Entry Angle S—180° Vertical
7 Plating 1—Gold Plated 3—Selective gold in contact area, matte(bright) tin on tail	8 Thickness of Plating 00—Gold Flash 05—5μ" Custom plate available	9 Material—Resin 4—PA6T	10 Color—Resin K6—Black	11 Packaging K—Tray L—Tube	

 THIRD ANGLE PROJECTION	GENERAL TOLERANCES (UNLESS SPECIFIED)		APPROVE BY FRANK	DATE 10/JUL/13	PART NO. FFH12702-DXXSXXX4K6X	ITEM NO. FFH12702	 3K-KAMING
	DESIGN UNITS Inch (metric)	X.±.012(0.30) X.X±.008(0.20)	X.±5" .X±2"	CHECKED BY CHERRY	DATE 10/JUL/13	TITLE Board to Board (Female Header) Pitch 1.27mm 180° Vertical (DIP)	
SCALE 5:1	SIZE A4	X.XX±.006(0.15) X.XXX±.004(0.10)	.XX±1" .XXX±0.5"	DRAWN BY JACOB	DATE 10/JUL/13	THIS DRAWING CONTAINS INFORMATION THAT IS PROPRIETARY TO DONG GUAN LANG LUN(3K-KAMING) ELECTRONIC PRODUCTS CO., LTD. AND SHOULD NOT BE USED WITHOUT WRITTEN PERMISSION	REV 1 SHEET NO. 1/2

REV	LOCATIONS	DESCRIPTION	DATE	REVISER	APPD
1	△	Size change	10/OCT/14	KTAE	FRANK



Circuits (n)	Part No.	Dimensions(in/mm)		Circuits (n)	Part No.	Dimensions(in/mm)	
		A	B			A	B
6	FFH12702-D06SXXX4K6X	.100(2.54)	.164(4.16)	46	FFH12702-D46SXXX4K6X	1.100(27.94)	1.164(29.56)
8	FFH12702-D08SXXX4K6X	.150(3.81)	.214(5.43)	48	FFH12702-D48SXXX4K6X	1.150(29.21)	1.214(30.83)
10	FFH12702-D10SXXX4K6X	.200(5.08)	.264(6.70)	50	FFH12702-D50SXXX4K6X	1.200(30.48)	1.264(32.10)
12	FFH12702-D12SXXX4K6X	.250(6.35)	.314(7.97)	52	FFH12702-D52SXXX4K6X	1.250(31.75)	1.314(33.37)
14	FFH12702-D14SXXX4K6X	.300(7.62)	.364(9.24)	54	FFH12702-D54SXXX4K6X	1.300(33.02)	1.364(34.64)
16	FFH12702-D16SXXX4K6X	.350(8.89)	.414(10.51)	56	FFH12702-D56SXXX4K6X	1.350(34.29)	1.414(35.91)
18	FFH12702-D18SXXX4K6X	.400(10.16)	.464(11.78)	58	FFH12702-D58SXXX4K6X	1.400(35.56)	1.464(37.18)
20	FFH12702-D20SXXX4K6X	.450(11.43)	.514(13.05)	60	FFH12702-D60SXXX4K6X	1.450(36.83)	1.514(38.45)
22	FFH12702-D22SXXX4K6X	.500(12.70)	.564(14.32)	62	FFH12702-D62SXXX4K6X	1.500(38.10)	1.564(39.72)
24	FFH12702-D24SXXX4K6X	.550(13.97)	.614(15.59)	64	FFH12702-D64SXXX4K6X	1.550(39.37)	1.614(40.99)
26	FFH12702-D26SXXX4K6X	.600(15.24)	.664(16.86)	66	FFH12702-D66SXXX4K6X	1.600(40.64)	1.664(42.26)
28	FFH12702-D28SXXX4K6X	.650(16.51)	.714(18.13)	68	FFH12702-D68SXXX4K6X	1.650(41.91)	1.714(43.53)
30	FFH12702-D30SXXX4K6X	.700(17.78)	.764(19.40)	70	FFH12702-D70SXXX4K6X	1.700(43.18)	1.764(44.80)
32	FFH12702-D32SXXX4K6X	.750(19.05)	.814(20.67)	72	FFH12702-D72SXXX4K6X	1.750(44.45)	1.814(46.07)
34	FFH12702-D34SXXX4K6X	.800(20.32)	.864(21.94)	74	FFH12702-D74SXXX4K6X	1.800(45.72)	1.864(47.34)
36	FFH12702-D36SXXX4K6X	.850(21.59)	.914(23.21)	76	FFH12702-D76SXXX4K6X	1.850(46.99)	1.914(48.61)
38	FFH12702-D38SXXX4K6X	.900(22.86)	.964(24.48)	78	FFH12702-D78SXXX4K6X	1.900(48.26)	1.964(49.88)
40	FFH12702-D40SXXX4K6X	.950(24.13)	1.014(25.75)	80	FFH12702-D80SXXX4K6X	1.950(49.53)	2.014(51.55)
42	FFH12702-D42SXXX4K6X	1.000(25.40)	1.064(27.02)	100	FFH12702-D100SXXX4K6X	2.450(62.23)	2.514(63.85)
44	FFH12702-D44SXXX4K6X	1.050(26.67)	1.114(28.29)				



<p>THIRD ANGLE PROJECTION</p>	GENERAL TOLERANCES (UNLESS SPECIFIED)		APPROVE BY	DATE	PART NO.	ITEM NO.	<p>3K-KAMING</p>	
	X.±.012(0.30)	X.±5'	FRANK	10/JUL/13				FFH12702-DXXSXXX4K6X
	DESIGN UNITS Inch (metric)	X.X±.008(0.20)	X.±2'	CHECKED BY	DATE	TITLE		REV 1
SCALE	X.XX±.006(0.15)	.XX±1'	CHERRY	10/JUL/13	Board to Board (Female Header) Pitch 1.27mm 180° Vertical (DIP)			
SIZE	X.XXX±.004(0.10)	.XXX±0.5'	DRAWN BY	DATE	THIS DRAWING CONTAINS INFORMATION THAT IS PROPRIETARY TO DONG GUAN LANG LUN(3K-KAMING) ELECTRONIC PRODUCTS CO.,LTD. AND SHOULD NOT BE USED WITHOUT WRITTEN PERMISSION			
5:1			JACOB	10/JUL/13				