

REV	LOCATIONS	DESCRIPTION	DATE	REVISER	APPD

SPECIFICATIONS

Electrical
 Current Rating: 0.5A AC(rms)/DC
 Voltage Rating: 50V AC(rms)/DC
 Contact Resistance: 50 mΩ Max.
 Insulation Resistance: 100 MΩ Min.
 Withstanding Voltage: 200V AC r.m.s.
 Temperature Range-Operating: -30°C~+80°C

Material and Plating
 Housing: PA9T (UL 94V-0)
 Contacts: Phosphor Bronze/ Gold Plated



Dimensions(in/mm)			
Height H	Female H1	Male H2	Male E
.157(4.00)	.118(3.00)	.039(1.00)	.157(4.00)
.177(4.50)	.138(3.50)	.039(1.00)	
.197(5.00)	.118(3.00)	.079(2.00)	
.197(5.00)	.157(4.00)	.039(1.00)	
.217(5.50)	.138(3.50)	.079(2.00)	
.217(5.50)	.177(4.50)	.039(1.00)	
.236(6.00)	.157(4.00)	.079(2.00)	.173(4.40)
.256(6.50)	.177(4.50)	.079(2.00)	
.276(7.00)	.118(3.00)	.157(4.00)	
.295(7.50)	.138(3.50)	.157(4.00)	
.315(8.00)	.157(4.00)	.157(4.00)	
.335(8.50)	.177(4.50)	.157(4.00)	

Ordering Information

FBB 080 09 — F XX S 1 XX 5 K6 M HXX
 1 2 3 4 5 6 7 8 9 10 11 12

1 Category FBB-Board to Board	2 Series Number 080-Pitch0.80mm	3 Distinction No. 09	4 Type F-Female	5 Circuits XX	6 Entry Angle S-180° Vertical
7 Plating 1-Gold Plated	8 Thickness of Plating 01-1μ" 03-3μ" Custom plate available	9 Material-Resin 5-PA9T	10 Color-Resin K6-Black	11 Packaging M-Reel	12 Female height H30-H1=3.00mm H35-H1=3.50mm ...

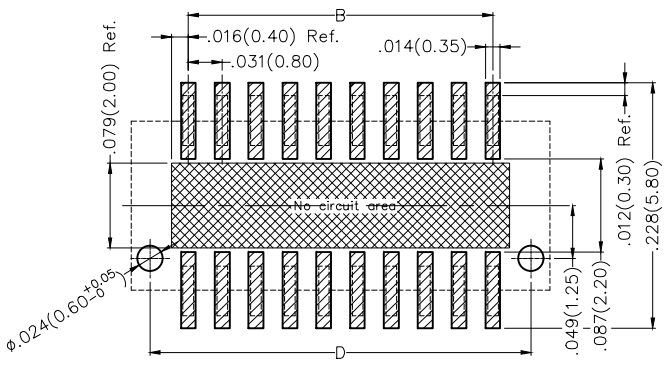
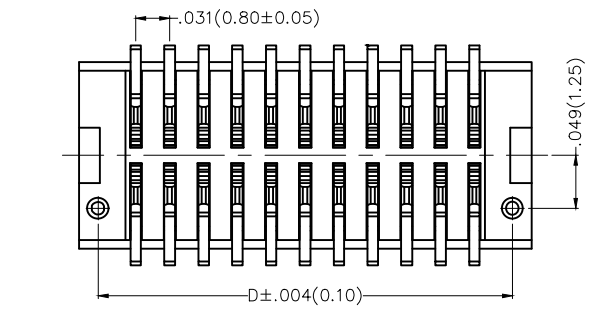
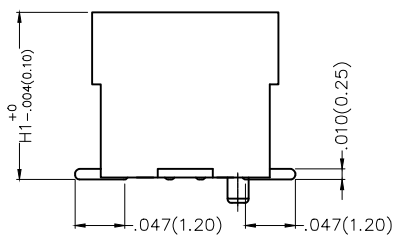
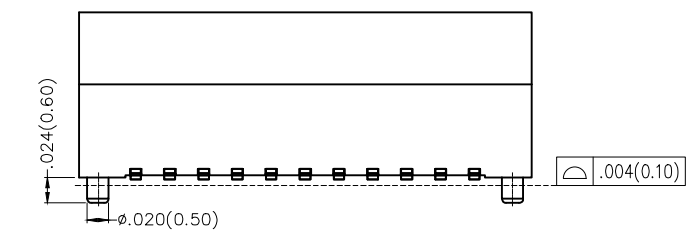
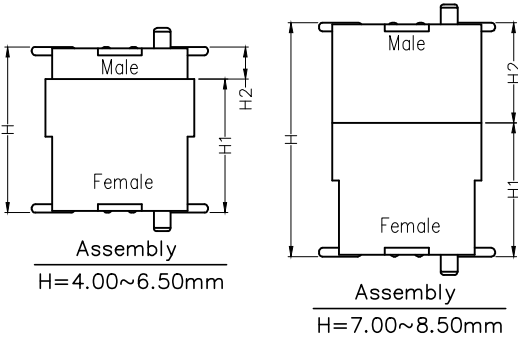
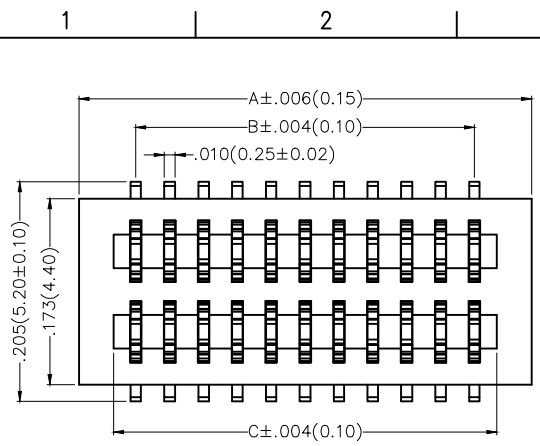

Recommended P.C.Board Layout
 General Tolerances: ±.002(0.05)

THIRD ANGLE PROJECTION	GENERAL TOLERANCES (UNLESS SPECIFIED)		APPROVE BY FRANK	DATE 21/AUG/19	PART NO. FBB08009-FXXS1XX5K6MHXX	ITEM NO. FBB08009	
	X.±.012(0.30)	X.±5'	CHECKED BY CHERRY	DATE 21/AUG/19	TITLE Board to Board Pitch 0.8mm 180° Vertical (SMT)		
DESIGN UNITS Inch (metric)	X.X±.008(0.20)	X.±2'	DRAWN BY KATE	DATE 21/AUG/19	THIS DRAWING CONTAINS INFORMATION THAT IS PROPRIETARY TO DONG GUAN LANG LUN(3K-KAMING) ELECTRONIC PRODUCTS CO.,LTD. AND SHOULD NOT BE USED WITHOUT WRITTEN PERMISSION		
SCALE 5:1	X.XX±.006(0.15)	.XX'±1'					
	X.XXX±.004(0.10)	.XXX±0.5'					