

REV	LOCATIONS	DESCRIPTION	DATE	REVISER	APPD

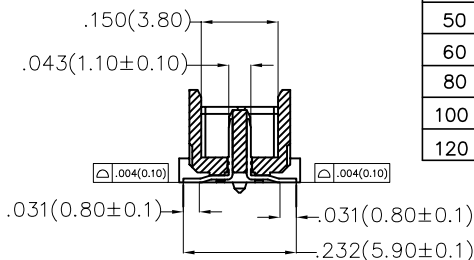

Section A-A
Scale 2:1

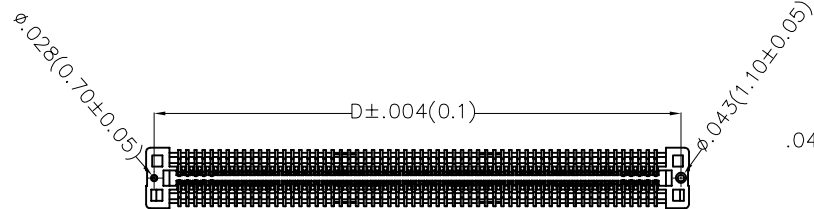
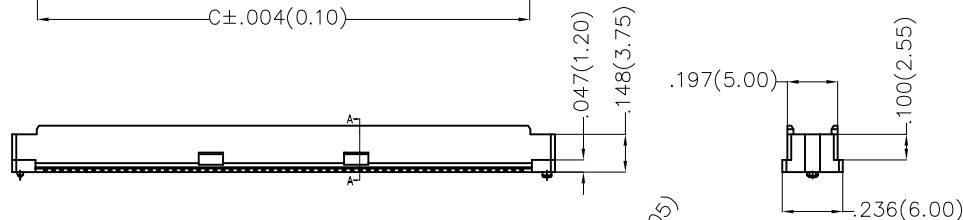
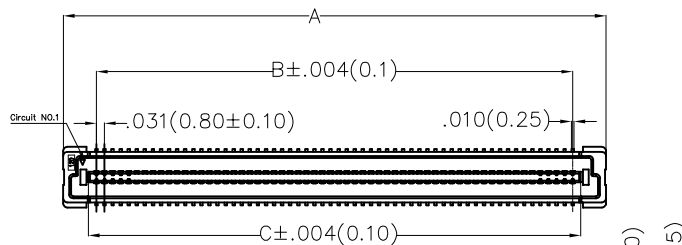
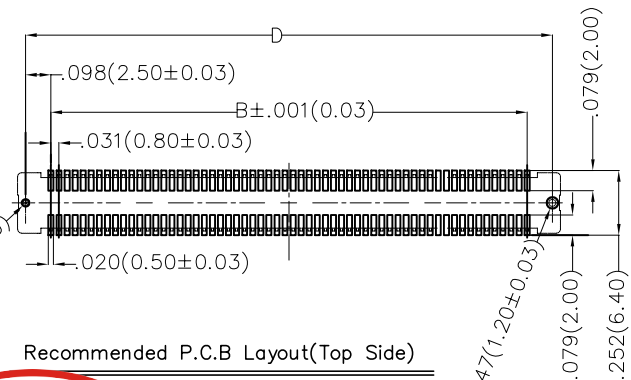

Recommended P.C.B Layout (Top Side)

PCB Board Tolerance ±0.05

Electrical

Current Rating: 0.5A AC(rms)/DC
Voltage Rating: 50V AC(rms)/DC
Contact Resistance: 50 mΩ Max.
Insulation Resistance: 500 MΩ Min.
Withstanding Voltage: 200V AC r.m.s.
Temperature Range-Operating: -30°C to +85°C

Material and Plating

Housing: LCP (UL94V-0)
Contacts Pin: Phosphor Bronze
Plating: Gold plated



Circuits (n)	Part No.	Dimensions(in/mm)			
		A	B	C	D
40	FBB08006-M40S1XX3W5M	.858(21.80)	.598(15.20)	.661(16.80)	.795(20.20)
50	FBB08006-M50S1XX3W5M	1.016(25.80)	.756(19.20)	.819(20.80)	.953(24.20)
60	FBB08006-M60S1XX3W5M	1.173(29.80)	.913(23.20)	.976(24.80)	1.110(28.20)
80	FBB08006-M80S1XX3W5M	1.488(37.80)	1.228(31.20)	1.291(32.80)	1.425(36.20)
100	FBB08006-M100S1XX3W5M	1.803(45.80)	1.543(39.20)	1.606(40.80)	1.470(44.20)
120	FBB08006-M120S1XX3W5M	2.118(53.80)	1.858(47.20)	1.921(48.80)	2.055(52.20)

Ordering Information

FBB 080 06 — M XX S 1 XX 3 W5 M
1 2 3 4 5 6 7 8 9 10 11

1 Category FBB-Board To Board	2 Series Number 080-Pitch0.8mm	3 Distinction No. 06	4 Type M-Male	5 Circuits XX	6 Entry Angle S-180° Vertical
7 Plating 1-Gold plated	8 Thickness of Plating 01-1μ" 05-5μ" Custom plate available	9 Material-Resin 3-LCP	10 Color-Resin W5-Natural	11 Packaging M-Reel	

<p>THIRD ANGLE PROJECTION</p>	GENERAL TOLERANCES (UNLESS SPECIFIED)		APPROVE BY FRANK	DATE 14/AUG/19	PART NO. FBB08006-MXXS1XX3W5M	ITEM NO. FBB08006	<p>3K-KAMING</p>			
	DESIGN UNITS Inch (metric)	X.X±.012(0.30) X.X±.008(0.20) X.XX±.006(0.15) X.XXX±.004(0.10)	X'.±5' .X'±2' .XX'±1' .XXX'±0.5'	CHECKED BY CHERRY	DATE 14/AUG/19	TITLE Board to Board Pitch 0.8mm 180° Vertical (SMT)		REV 0	SHEET NO. 1/1	
	SCALE 5:1	SIZE A-Z		DRAWN BY ZOEY	DATE 14/AUG/19	THIS DRAWING CONTAINS INFORMATION THAT IS PROPRIETARY TO DONG GUAN LANG LUN(3K-KAMING) ELECTRONIC PRODUCTS CO.,LTD. AND SHOULD NOT BE USED WITHOUT WRITTEN PERMISSION				

