

REV	LOCATIONS	DESCRIPTION	DATE	REVISER	APPD
1	△	1. Structure change 2. Size change	02/APR/20	KATE	CHERRY

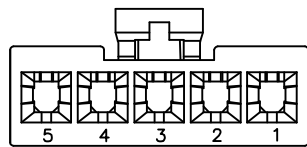

Electrical  
 Temperature Range—Operating: -40°C~+105°C  
 Material  
 Housing: PA66( UL 94V-0)  
 Applicable Terminal: FT42001  
 Mates With: FWF42006,FWF42007Series.

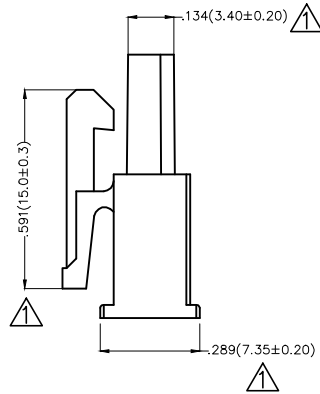
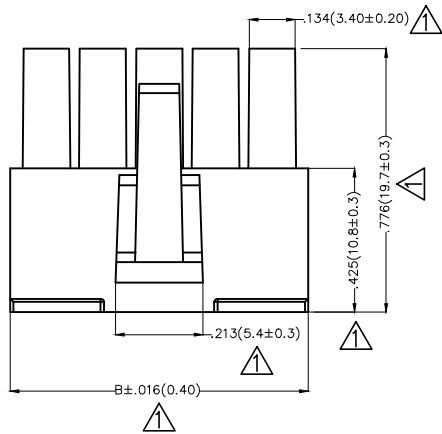
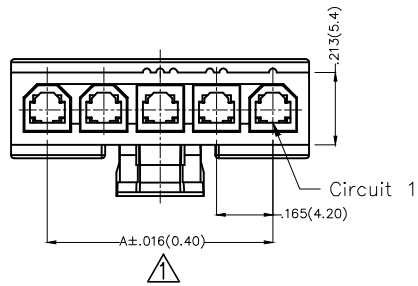

3-5Circuits

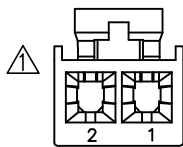

2Circuits

Circuits (n)	Part No.	Dimensions(in./mm)	
		A	B
2	FHG42003-S02M2TB	.165(4.20)	.379(9.60)
3	FHG42003-S03M2TB	.331(8.40)	.543(13.80)
4	FHG42003-S04M2TB	.496(12.60)	.709(18.00)
5	FHG42003-S05M2TB	.661(16.80)	.874(22.20)

### Ordering Information

FHG 420 03 — S XX M 2 T B  
 1 2 3 4 5 6 7 8 9

1	Category FHG—Housing	2	Series Number 420—Pitch4.2mm	3	Distinction No. 03	4	Row Option S—Single row	5	Circuits XX
6	Entry Type M—Male	7	Material—Resin 2—PA66	8	Color—Resin T—Transparent	9	Packaging B—PE Bag		



 THIRD ANGLE PROJECTION DESIGN UNITS Inch (metric) SCALE 5:1 SIZE A4	GENERAL TOLERANCES (UNLESS SPECIFIED)		APPROVE BY FRANK	DATE 25/JUN/13	PART NO. FHG42003-SXXM2TB	ITEM NO. FHG42003	 3K-KAMING®	
	X.±.012(0.30)	X.'±5'	CHECKED BY JACOB	DATE 25/JUN/13	TITLE Wire to Board Pitch 4.2mm(Housing)			REV 1
	X.X±.008(0.20)	.X'±2'	DRAWN BY CHERRY	DATE 25/JUN/13	THIS DRAWING CONTAINS INFORMATION THAT IS PROPRIETARY TO DONG GUAN LANG LUN(3K-KAMING) ELECTRONIC PRODUCTS CO., LTD. AND SHOULD NOT BE USED WITHOUT WRITTEN PERMISSON			
	X.XX±.006(0.15)	.XX'±1'						
	X.XXX±.004(0.10)	.XXX'±0.5'						