

0.1

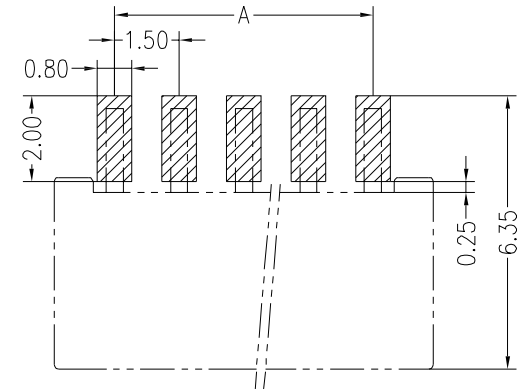

PCB LAYOUT

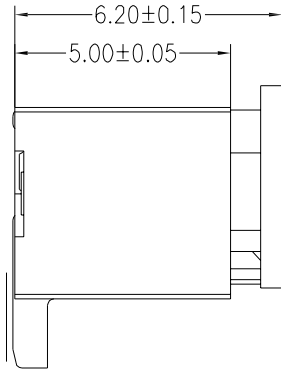
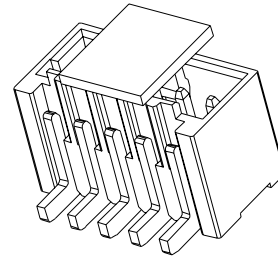
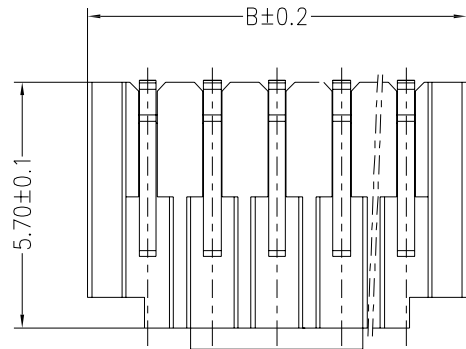

主要技术参数 Main Specifications

- 线 数 (Poles): 02 to 15
- 接触电阻 (Contact resistance): $\leq 20m\Omega$
- 绝缘电阻 (Insulation resistance): $\geq 1000M\Omega$
- 额定电压 (Rated voltage): 350V AC DC
- 额定电流 (Rated current): 3.0A AC DC
- 耐 电 压 (Withstand Voltage): 500V AC/minute
- 温度范围 (Temperature Range) : $-25^{\circ}C \sim +85^{\circ}C$

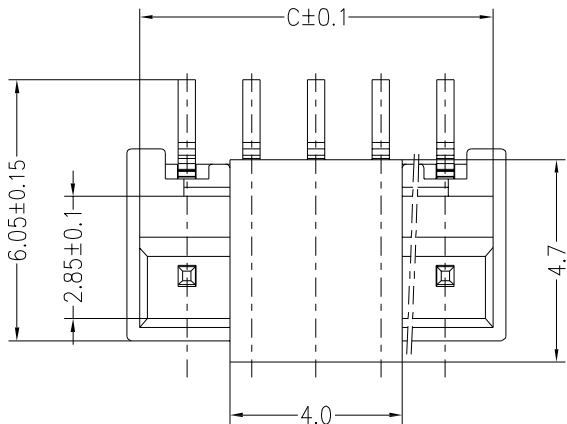

PIN.	DIM A	DIM B	DIM C
2pin	1.50	4.30	3.70
3pin	3.00	5.80	5.20
4pin	4.50	7.30	6.70
5pin	6.00	8.80	8.20
6pin	7.50	10.30	9.70
7pin	9.00	11.80	11.20
8pin	10.50	13.30	12.70
9pin	12.00	14.80	14.20
10pin	13.50	16.30	15.70
11pin	15.00	17.80	17.20
12pin	16.50	19.30	18.70
13pin	18.00	20.80	20.20
14pin	19.50	22.30	21.70
15pin	21.00	23.80	23.20

ITEM	COMPONENT	Q'TY	MATERIAL	FINISH
C	CAP	1 PCS	LCP	UL 94V-0, COLOR:BEIGE
B	CONTACT	2~15 PCS	PhosphorBronze	MATTE Sn-plated
A	HOUSING	1 PCS	LCP	UL 94V-0, COLOR:BEIGE

UNITS mm	东莞市朗纶电子制品有限公司 Dongguan langlun electronic products Co., Ltd		
MAT'L	PART NO.(INTENDED USE) A1504AWV-**	TITLE: 1.5MM PITCH 180° WAFER SMT TYPE	
FINISH	APPD:	DWG NO.: A1504AWV-**	
Q'TY PCS	CHKD:	DR:	SCALE SHEET REV. 1/1 1/1 A
.X ± 0.3	.X° ± 5°	HU 2016.09.28	
.X ± 0.25	.X° ± 2°		
.XX ± 0.20	.XX° ± 1°		
.XXX ± 0.10	.XXX° ± 0.5°		