

REV	LOCATIONS	DESCRIPTION	DATE	REVISER	APPD
1	△	1. Add the "TXGA" logo 2. Dimension: Change 0.90 into 1.20mm Change 1.70 into 1.30mm 3. Part No.: Change FRJ45141 into FRJ45019	31/MAY/18	KATE	ERIC

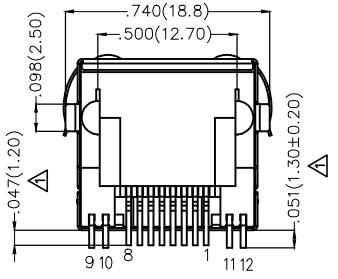

**Electrical**  
 Current Rating: 1.5A AC(rms)/DC  
 Voltage Rating: 125V AC(rms)/DC  
 Contact Resistance: 50 mΩ Max  
 Insulation Resistance: 500 MΩ MIN  
 Withstanding Voltage: 100V AC r.m.s  
 Operating Temperature: -40°C~+85°C  
 LED Rating: Forward Voltage: 2.2 Volts Typical  
 Reverse Voltage: 5 Volts Maximum.

**Material**  
 Housing: LCP (UL 94V-0)  
 Contact: Phosphor Bronze/Selective gold  
 in contact area, tin on tail  
 Shell: Copper Alloy/Nickel

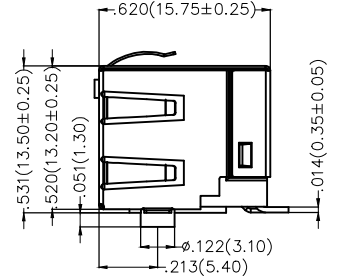
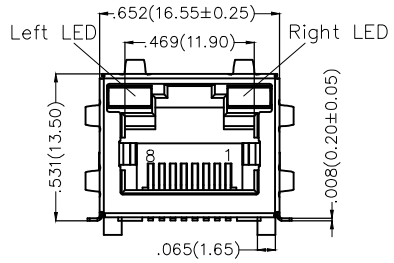
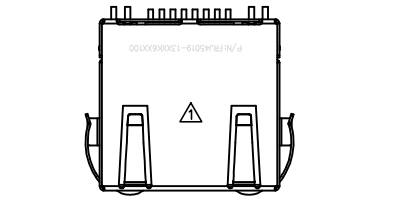
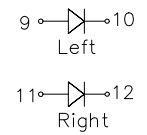

**Ordering Information**

FRJ45 019 — 1 3 XX K6 X X 1 0 0  
 1 2 3 4 5 6 7 8 9

1 Category FRJ45-RJ45 Connector	2 Distinction No. 019	3 Ports options 1-1 Port	4 Plating 3-Selective gold in contact area, tin on tail	5 Thickness of plating 00-Gold flash 02-2μ" Custom plate available
6 Color-Resin K6-Black	7 Packaging M-Reel K-Tray	8 LED style 1-L: Yellow R: Green 2-L: Green R: Yellow	9 Contact type 1-Square pin	

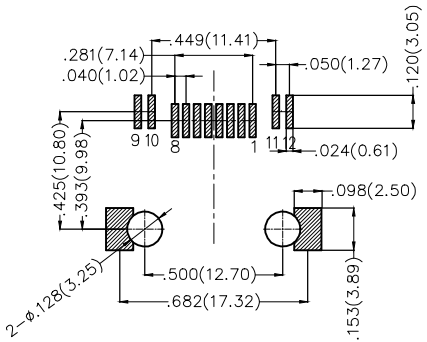

**Recommended P.C.Board Layout**

THIRD ANGLE PROJECTION	GENERAL TOLERANCES (UNLESS SPECIFIED)		APPROVE BY FRANK	DATE 30/JUN/17	PART NO. △ FRJ45019-13XXK6XX100	ITEM NO. FRJ45019	
	DESIGN UNITS Inch (metric)	X.±0.012(0.30) X.±5'	CHECKED BY CHERRY	DATE 30/JUN/17	TITLE RJ45 Connector 8P8C 90° Angle (SMT)		
SCALE 5:1	SIZE A4	X.XX±.006(0.15) .XX±1' X.XXX±.004(0.10) .XXX±0.5'	DRAWN BY LXF	DATE 30/JUN/17	THIS DRAWING CONTAINS INFORMATION THAT IS PROPRIETARY TO DONG GUAN LANG LUN(3K-KAMING) ELECTRONIC PRODUCTS CO.,LTD. AND SHOULD NOT BE USED WITHOUT WRITTEN PERMISSION		