

REV	LOCATIONS	DESCRIPTION	DATE	REVISER	APPD
1	△	Part No.: Change FRJ1102 into FRJ11002	05/JUN/18	KATE	ERIC

SPECIFICATIONS

Electrical

Current Rating: 1.5A AC(rms)/DC
Voltage Rating: 125V AC(rms)/DC
Contact Resistance: 20 mΩ Max
Insulation Resistance: 1000 MΩ MIN
Withstanding Voltage: 500V AC r.m.s
Temperature Range—Operating: -40°C~+85°C

Material and Plating

Housing: PBT UL 94V-0
Contact: Gold Flash
Plating: Full gold/Gold Plated

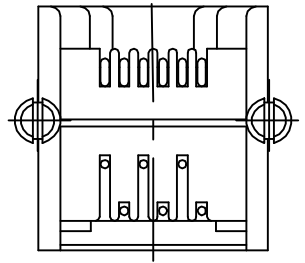
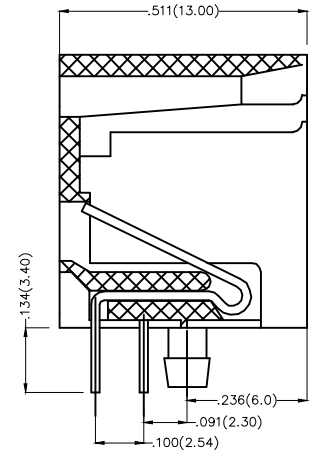
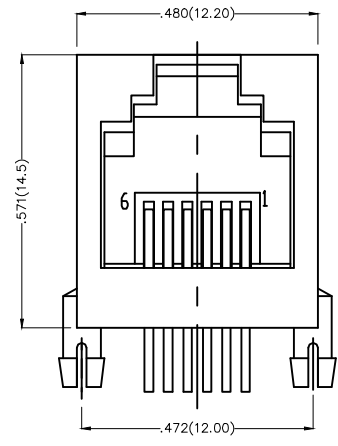

Ordering Information

FRJ11 002 - 1 1 XX G1 K 2 0
1 2 3 4 5 6 7 8

1 Category FRJ11-RJ11 Connector	2 Distinction No. 002	3 Ports options 1-1 Port	4 Plating 1-Gold Plated
5 Thickness of plating 00-Gold flash 03-3μ" Custom plate available	6 Color-Resin G1-Gray	7 Packaging K-Tray	8 Contact type 2-Round pin

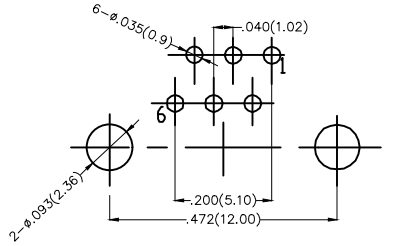

Recommended P.C.Board Layout

 THIRD ANGLE PROJECTION	GENERAL TOLERANCES (UNLESS SPECIFIED)		APPROVE BY FRANK	DATE 1/AUG/13	PART NO. △ FRJ11002-11XXG1K20	ITEM NO. FRJ11002	 3K-KAMING
	X.±.012(0.30)	.X'±5'	CHECKED BY CHERRY	DATE 1/AUG/13	TITLE RJ11 Connector 6P6C 90° Angle		
	DESIGN UNITS Inch (metric)	X.XX±.008(0.20)	.X'±2'	DRAWN BY JACOB	DATE 1/AUG/13	THIS DRAWING CONTAINS INFORMATION THAT IS PROPRIETARY TO DONG GUAN LANG LUN(3K-KAMING) ELECTRONIC PRODUCTS CO., LTD. AND SHOULD NOT BE USED WITHOUT WRITTEN PERMISSION	
	SCALE 5:1	SIZE A4	X.XX±.006(0.15)	.XX'±1'	X.XXX±.004(0.10)	.XXX'±0.5'	REV 1