

REV	LOCATIONS	DESCRIPTION	DATE	REVISER	APPD
-----	-----------	-------------	------	---------	------

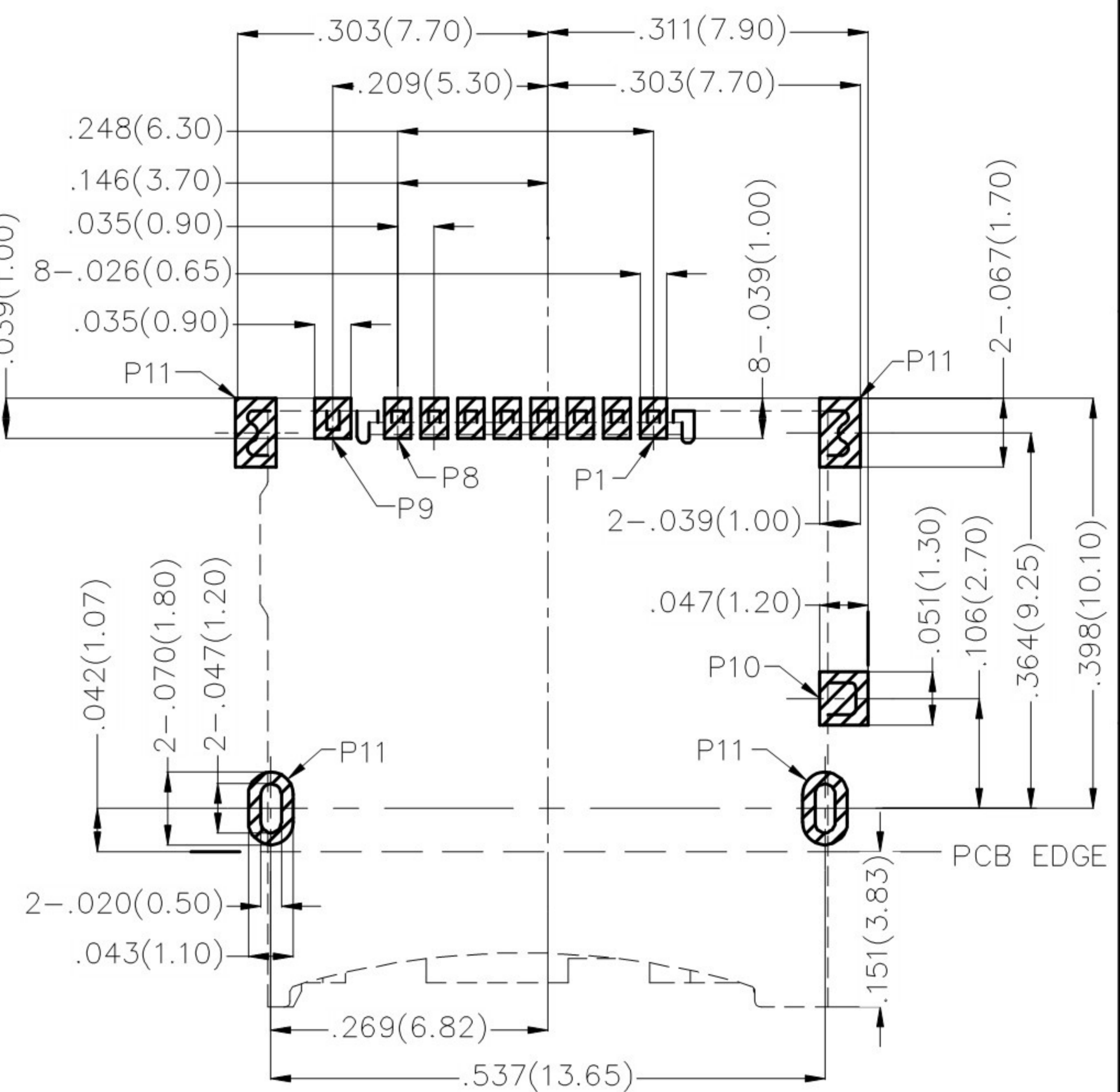

Recommended P.C.Board Layout
General tolerances: ±.002(0.05)

PAD AREA
 KEEP OUT AREA

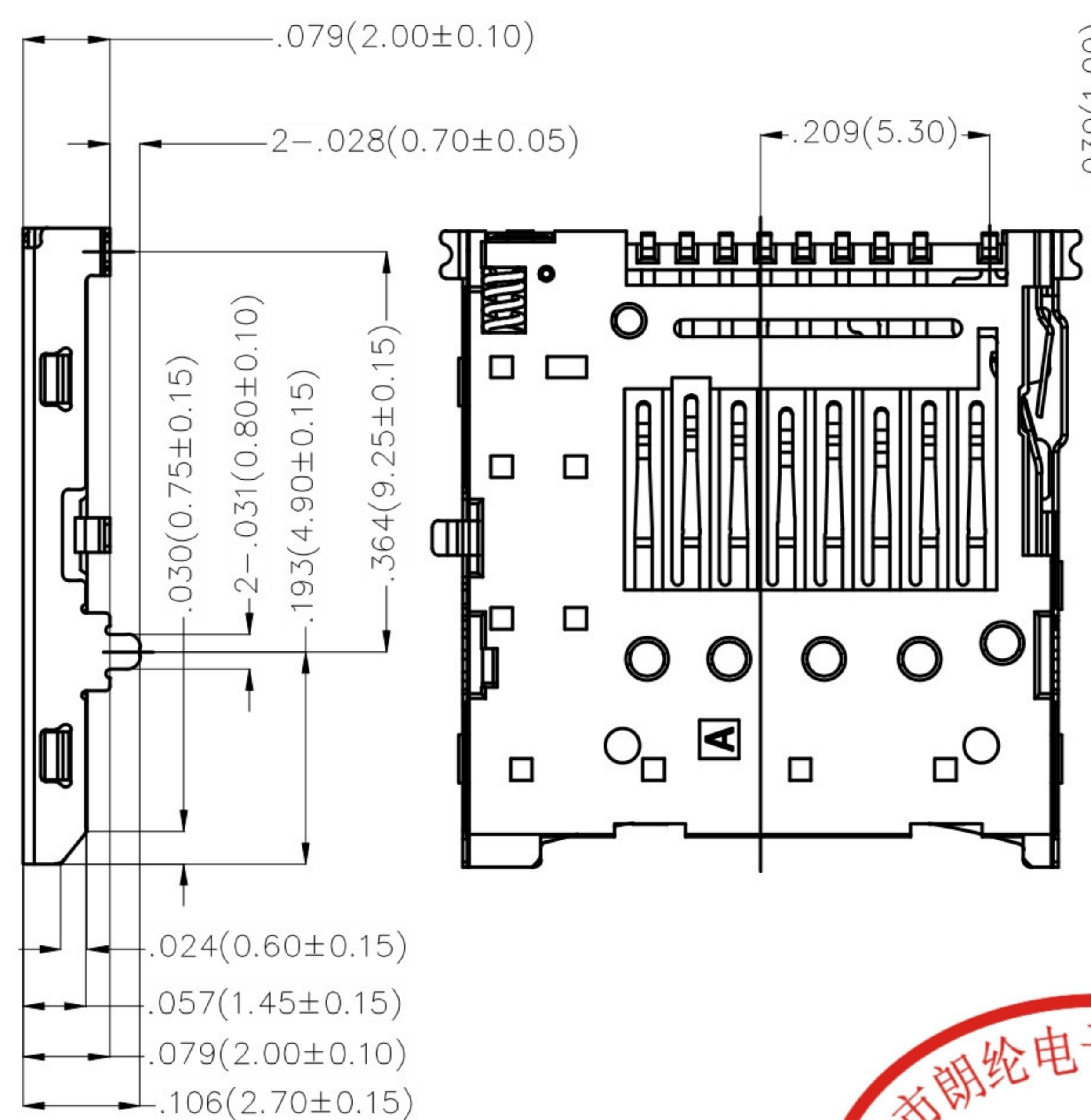
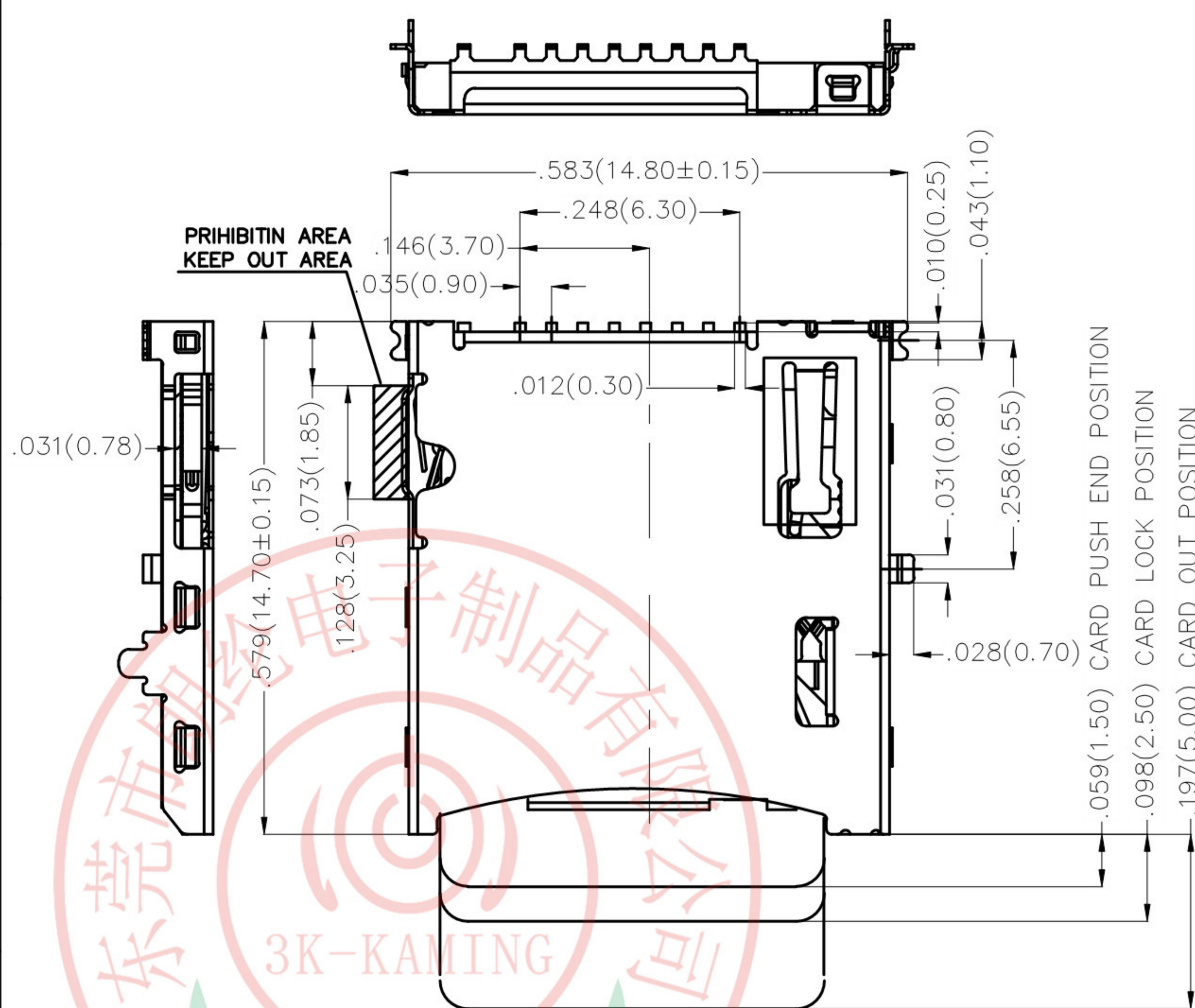
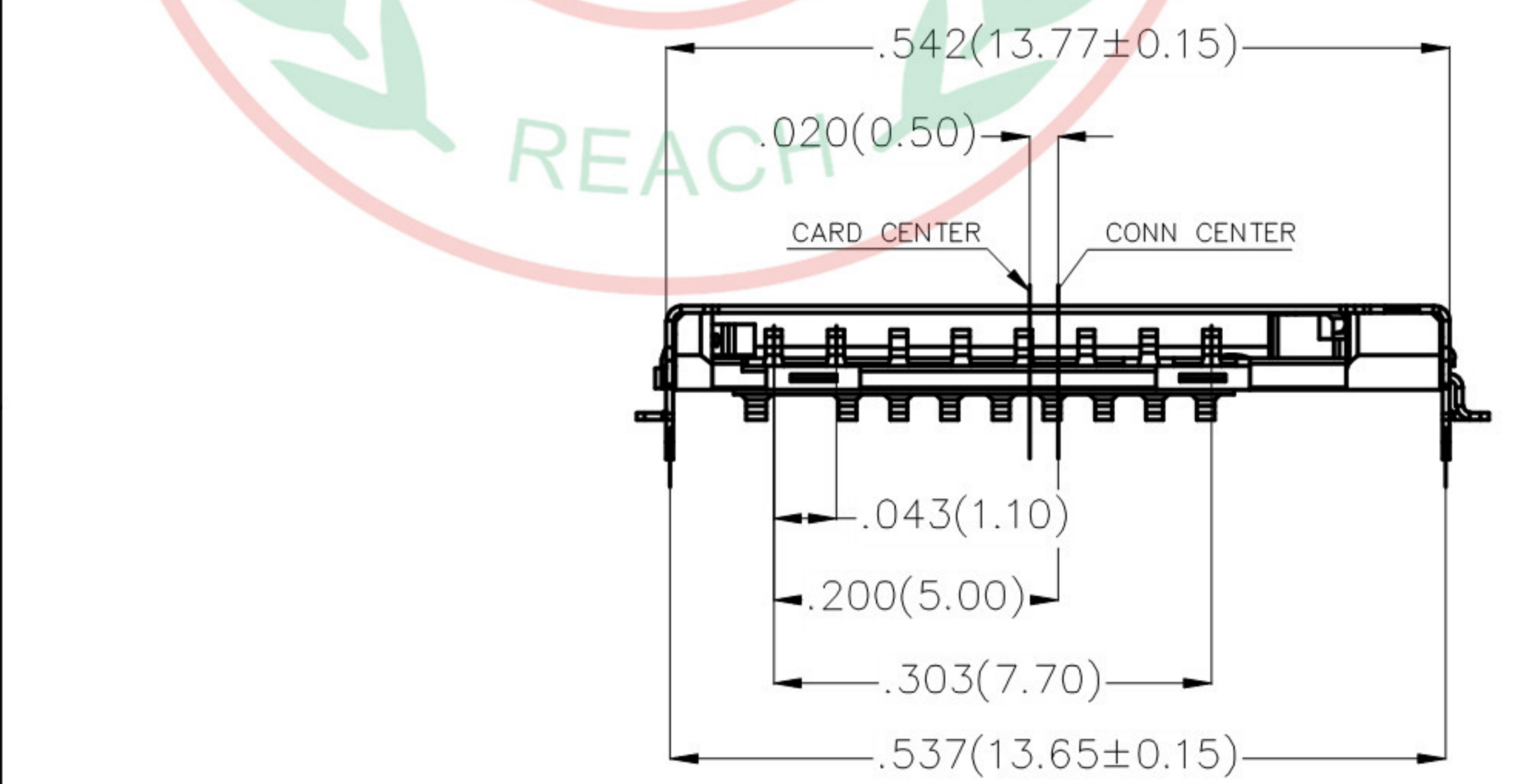

Electrical
Current Rating: 0.5A AC(rms)/DC
Voltage Rating: 100V AC(rms)/DC
Contact Resistance: 100 mΩ Max
Insulation Resistance: 1000 MΩ MIN
Withstanding Voltage: 500V AC r.m.s
Temperature Range-Operating: -25°C ~ +85°C

Material and Plating
Housing: LCP UL94 Black Color
Shell: SUS304 Nickel Plating
Contact Pin: 1μ" gold in contact area, gold flash in solder area, Nickel plated overall
Plating: Gold in contact area, Tin on tail.



Opening/Close of Switch

	Card Detect Switch	
CARD UNINSERTION	OPEN	
CARD HALF INSERTION	OPEN	
CARD INSERTION	CLOSE	
N/O		
P10	P9	P10 P9

PIN ASSIGNMENT

Pin No.	PIN ASSIGNMENT
P1	MICRO SD_DAT2
P2	MICROSD SD_CD/DAT3
P3	MICRO SD_CMD
P4	MICRO SD_VDD
P5	MICRO SD_CLK
P6	MICRO SD_VSS
P7	MICRO SD_DAT0
P8	MICRO SD_DAT1
P9	MICRO SD_CD
P10	MICRO SD_GND



 THIRD ANGLE PROJECTION	GENERAL TOLERANCES (UNLESS SPECIFIED)		APPROVE BY	DATE	PART NO.	ITEM NO.	 3K-KAMING
	X.±.012(0.30)	X.±5'	FRANK	13/JUL/19	FCD426-7M	FCD426	
DESIGN UNITS Inch (metric)	X.X±.008(0.20)	.X'±2'	CHECKED BY	DATE	TITLE		REV 0 SHEET NO. 1/2 THIS DRAWING CONTAINS INFORMATION THAT IS PROPRIETARY TO DONG GUAN LANG LUN (3K-KAMING) ELECTRONIC PRODUCTS CO., LTD. AND SHOULD NOT BE USED WITHOUT WRITTEN PERMISSION
SCALE 5:1	X.XX±.006(0.15)	.XX'±1'	CHERRY	13/JUL/19	MICRO SD PUSH (2.0)		
SIZE A4	X.XXX±.004(0.10)	.XXX'±0.5'	DRAWN BY	DATE			
			ZOEY	13/JUL/19			

REV	LOCATIONS	DESCRIPTION	DATE	REVISER	APPD

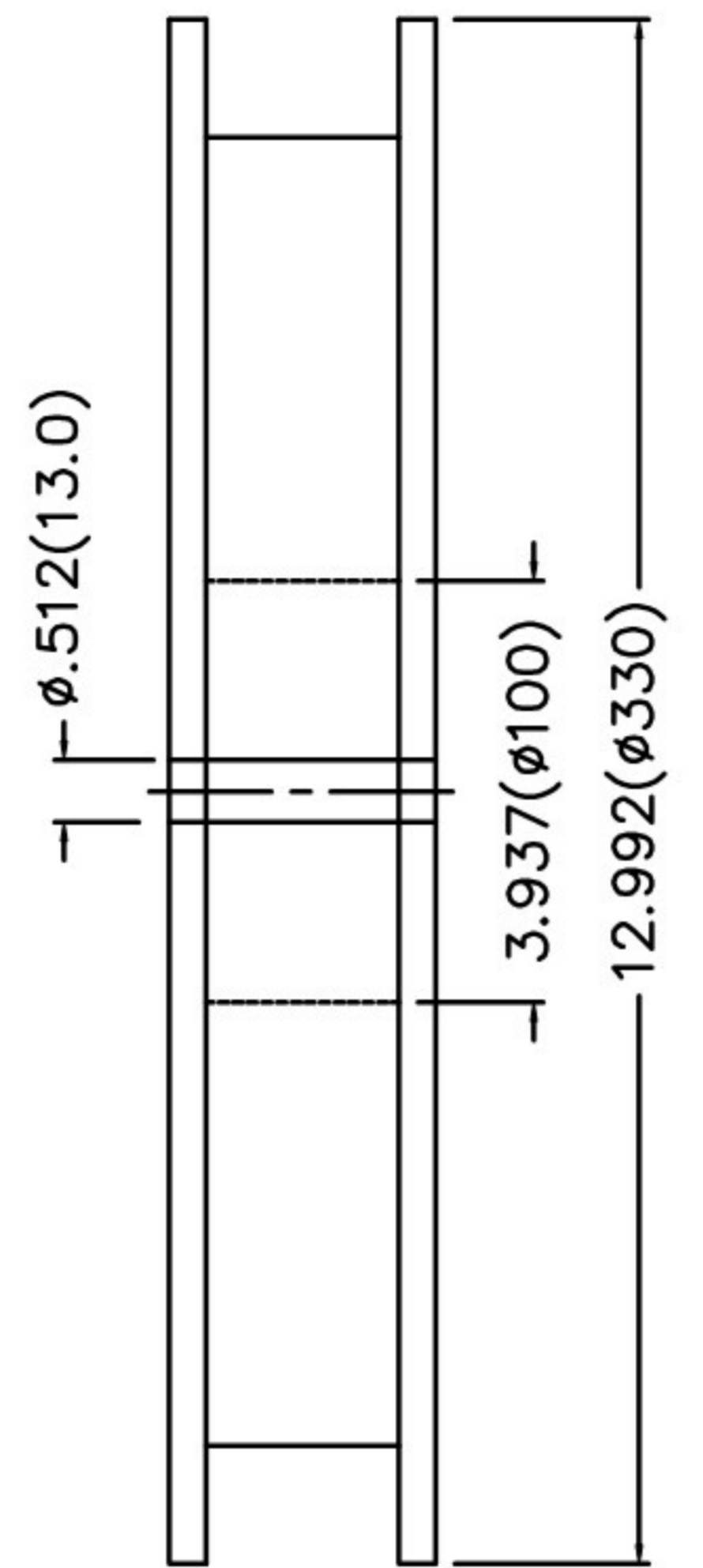
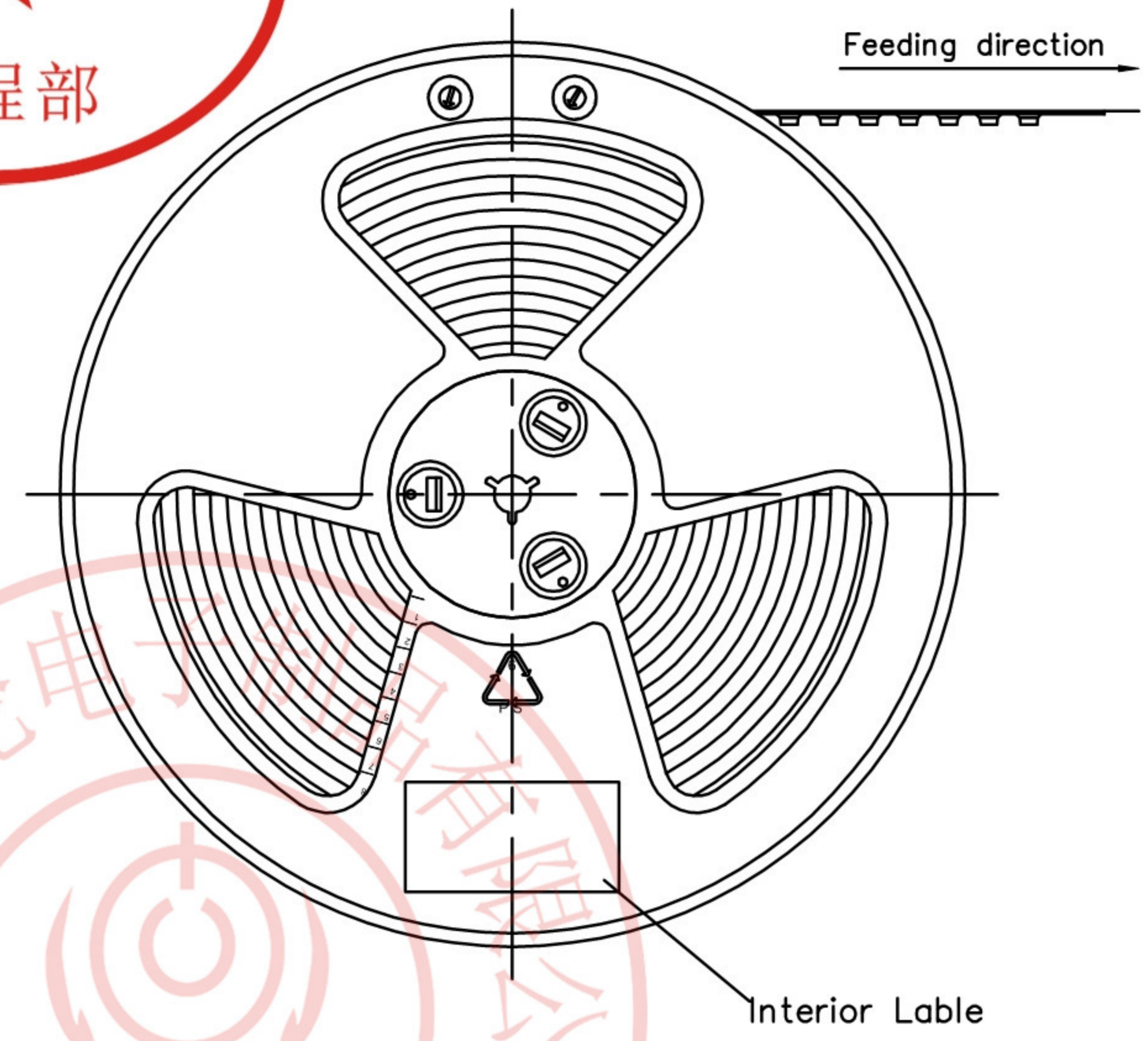

- Note:
- 10 sprocket hole cumulative tolerance ± 0.2
 - Carrier camber is within 1.0mm in 100mm
 - Material: White Conductive polystyrene Alloy 100% recyclable
 - All dimensions meet EIA-481-3 requirements
 - Component load per 13" reel: 1000pcs

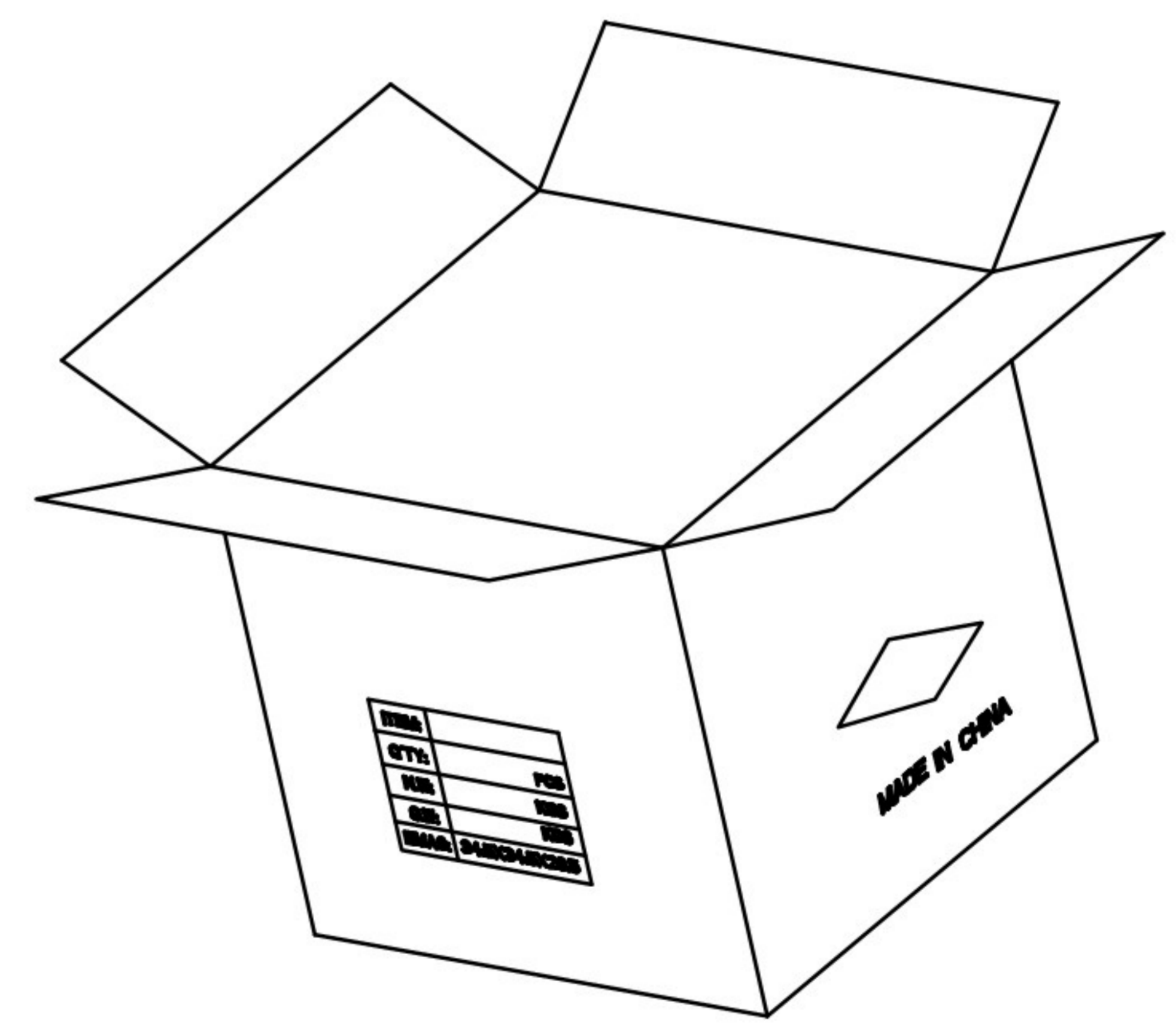
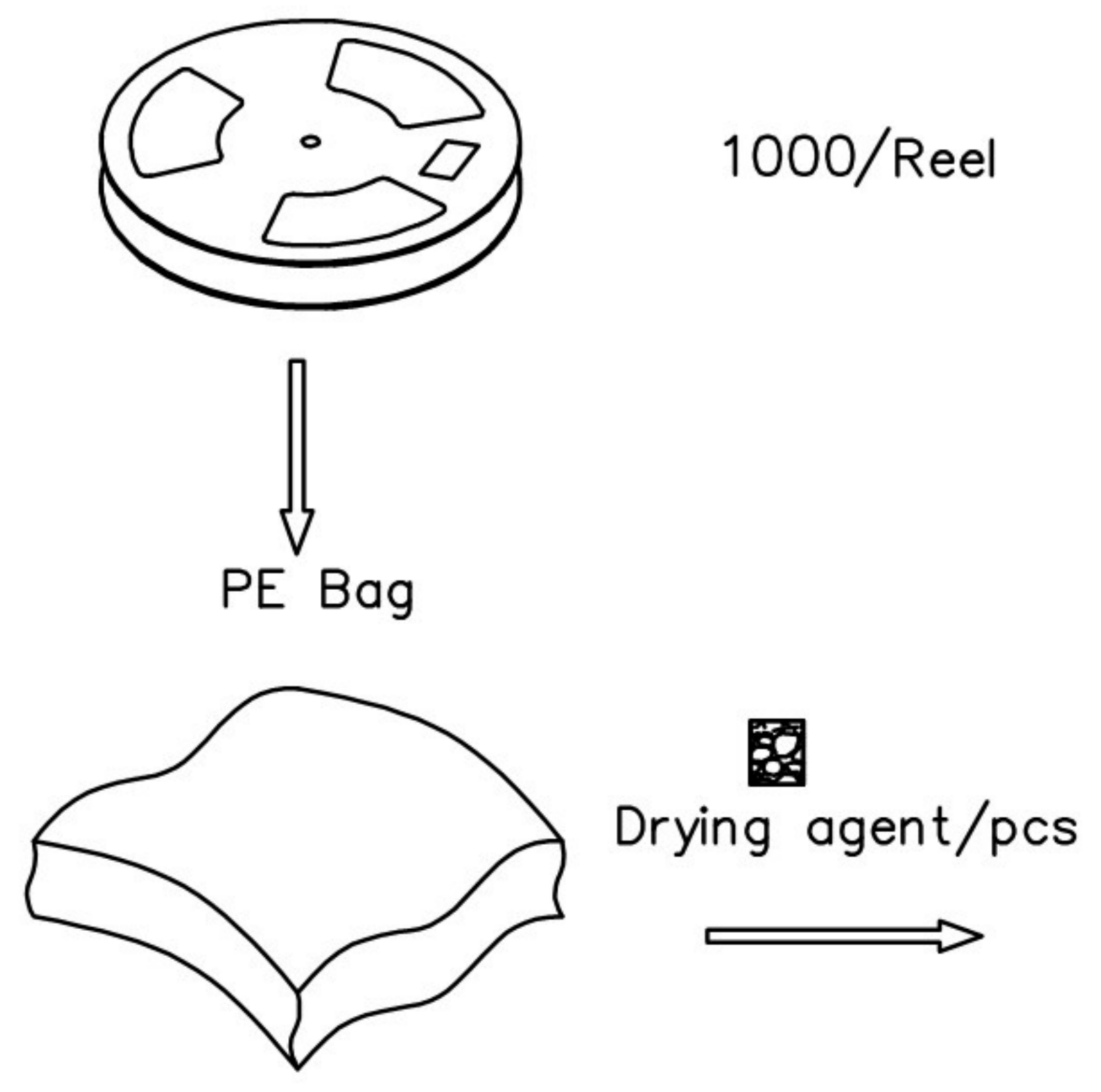
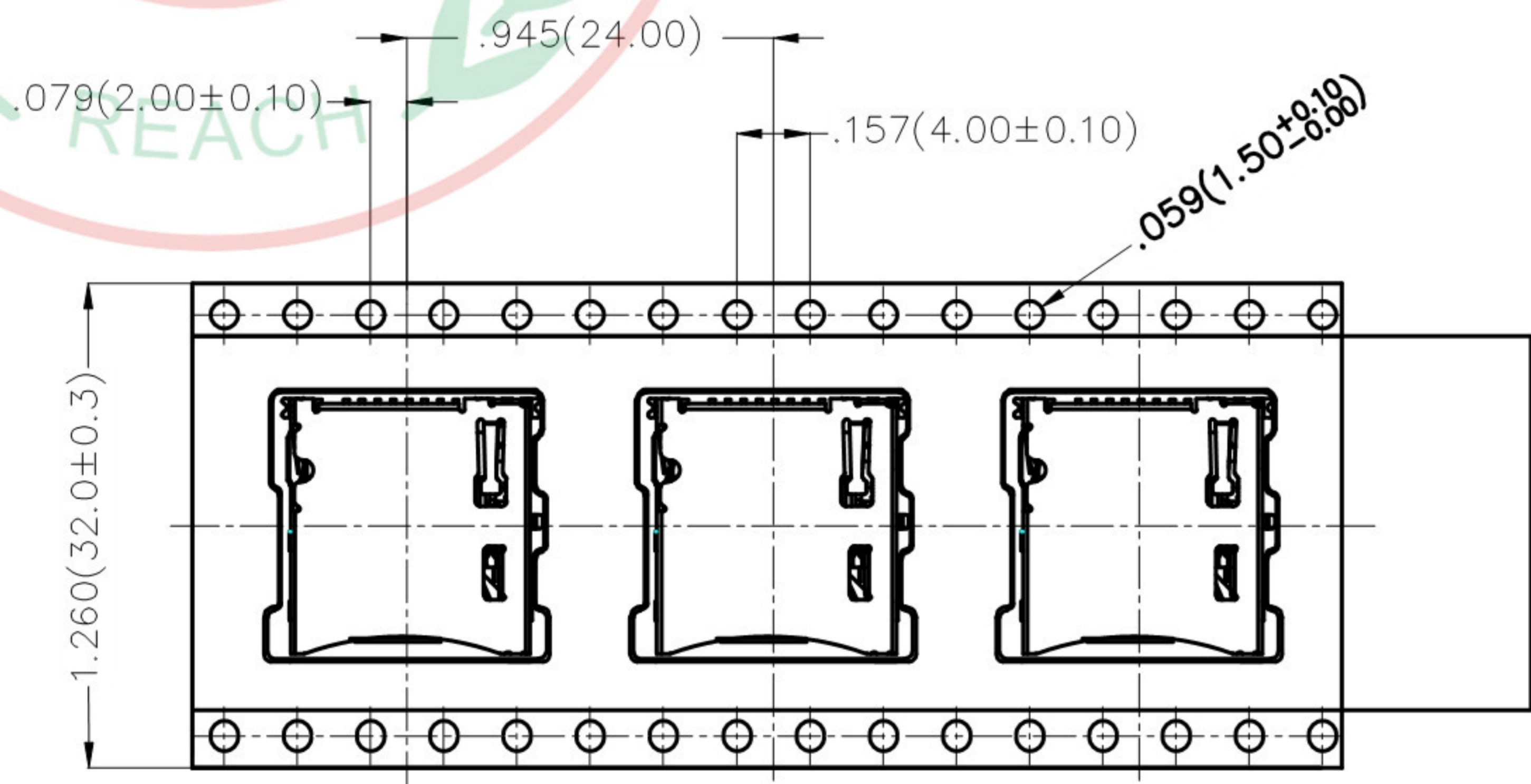
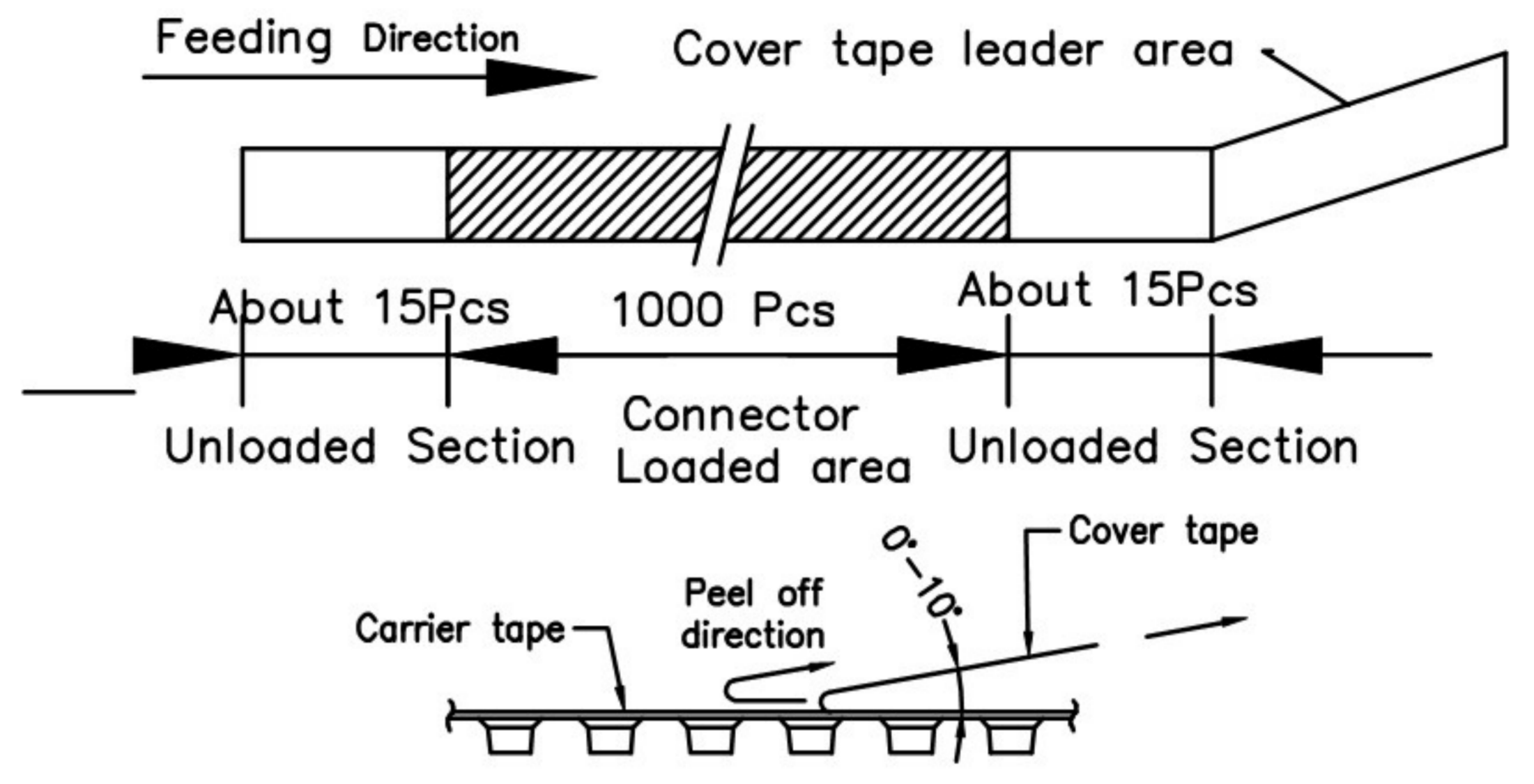

Feeding Direction →

 THIRD ANGLE PROJECTION DESIGN UNITS Inch (metric) SCALE 5:1 SIZE A4	GENERAL TOLERANCES (UNLESS SPECIFIED)		APPROVE BY FRANK	DATE 13/JUL/19	PART NO. FCD426-7M	ITEM NO. FCD426	 3K-KAMING
	X.±.012(0.30)	X.±5'	CHECKED BY CHERRY	DATE 13/JUL/19	TITLE MICRO SD PUSH (2.0)		
	X.X±.008(0.20)	.X'±2'	DRAWN BY ZOEY	DATE 13/JUL/19	THIS DRAWING CONTAINS INFORMATION THAT IS PROPRIETARY TO DONG GUAN LANG LUN(3K-KAMING) ELECTRONIC PRODUCTS CO., LTD. AND SHOULD NOT BE USED WITHOUT WRITTEN PERMISSION		
	X.XX±.006(0.15)	.XX'±1'					
	X.XXX±.004(0.10)	.XXX'±0.5'					