

REV	LOCATIONS	DESCRIPTION	DATE	REVISER	APPD
-----	-----------	-------------	------	---------	------

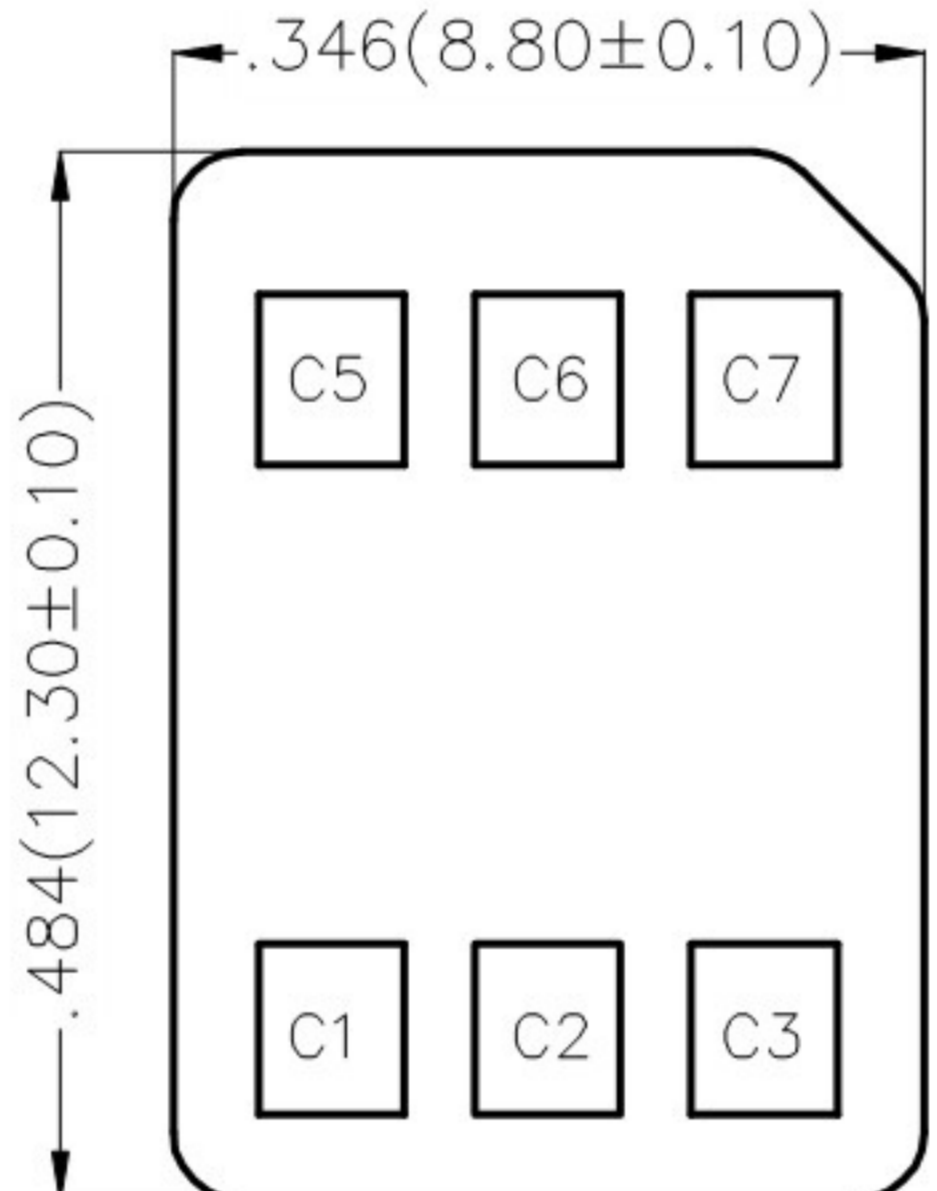
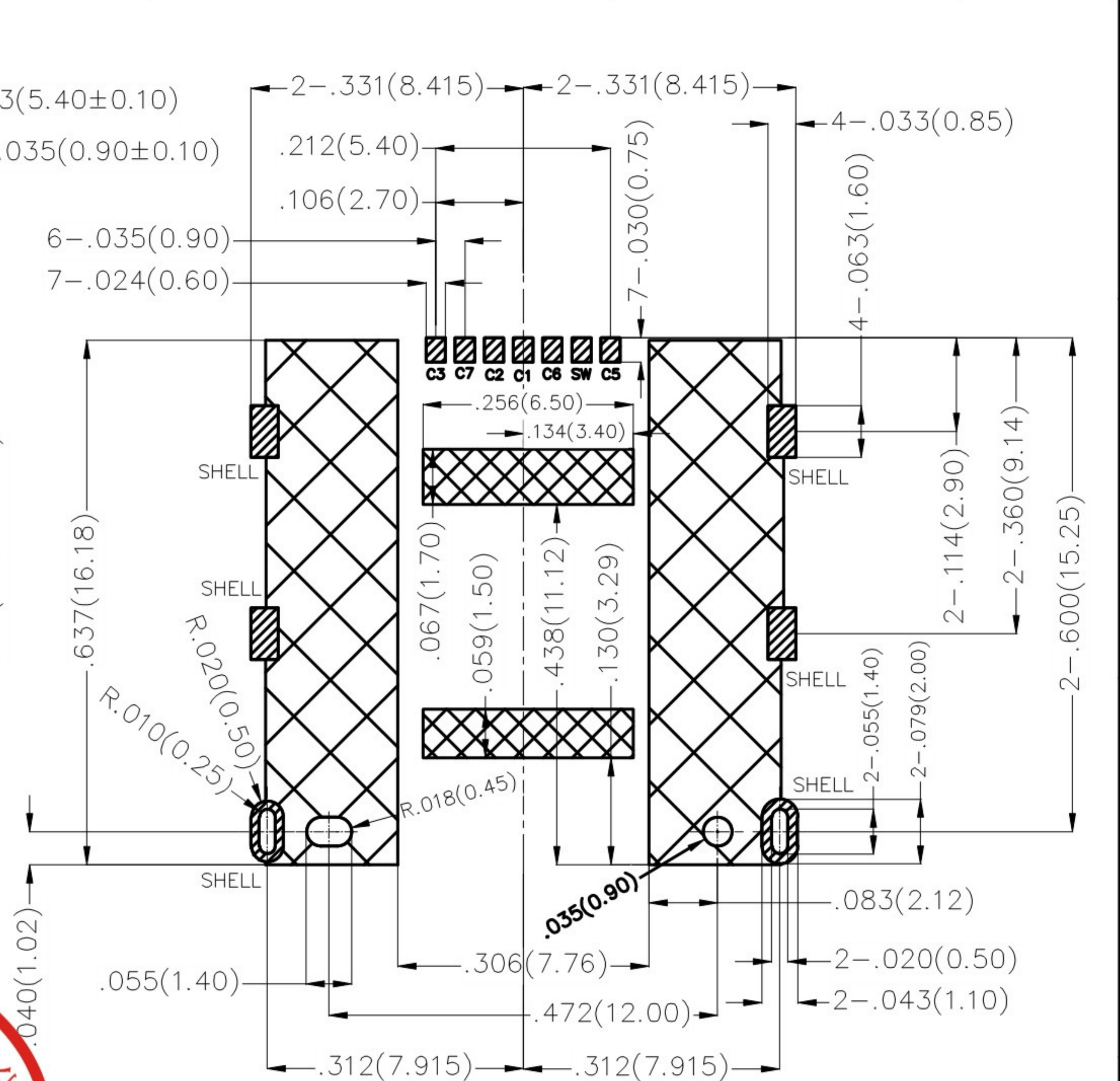
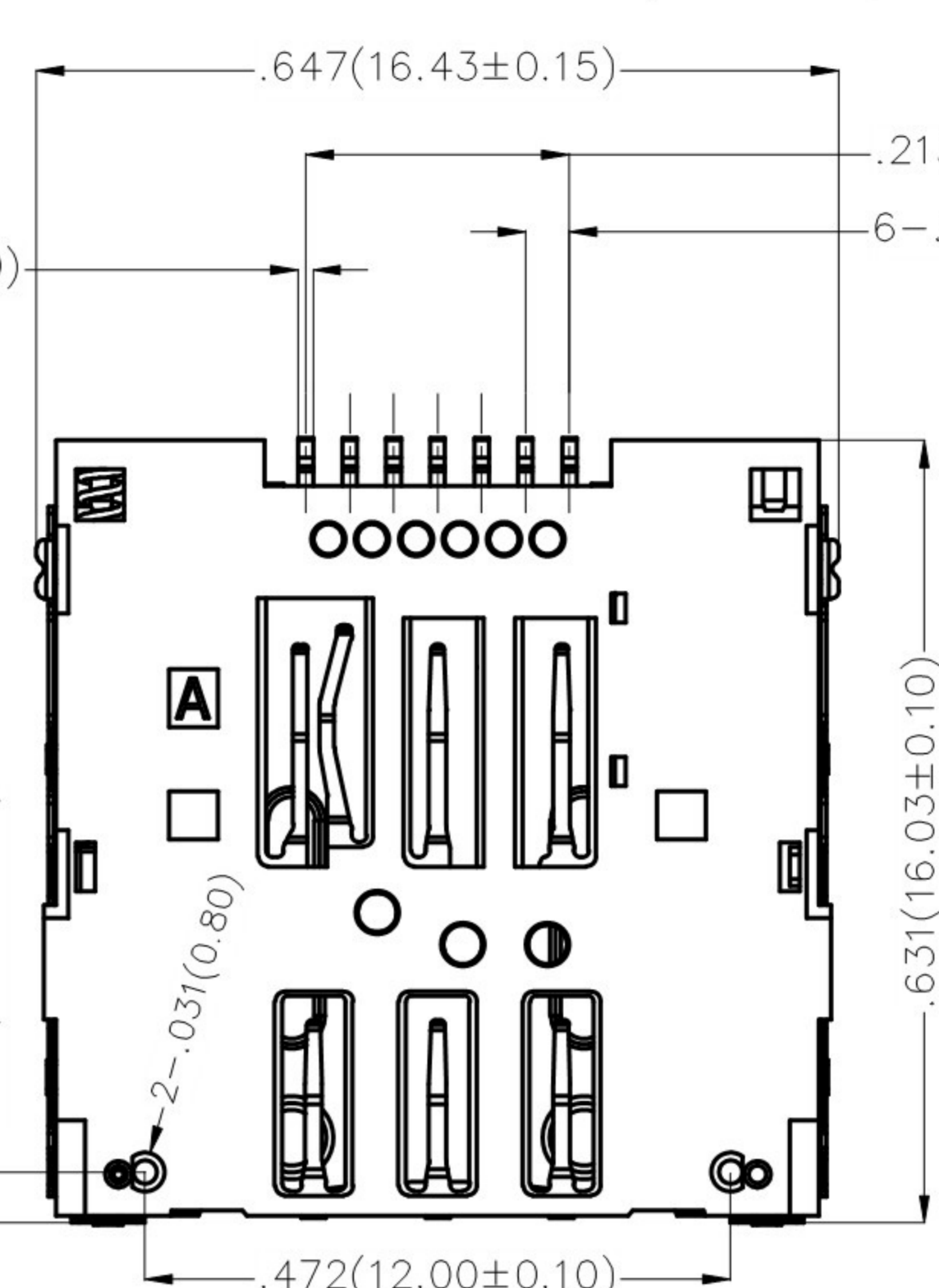
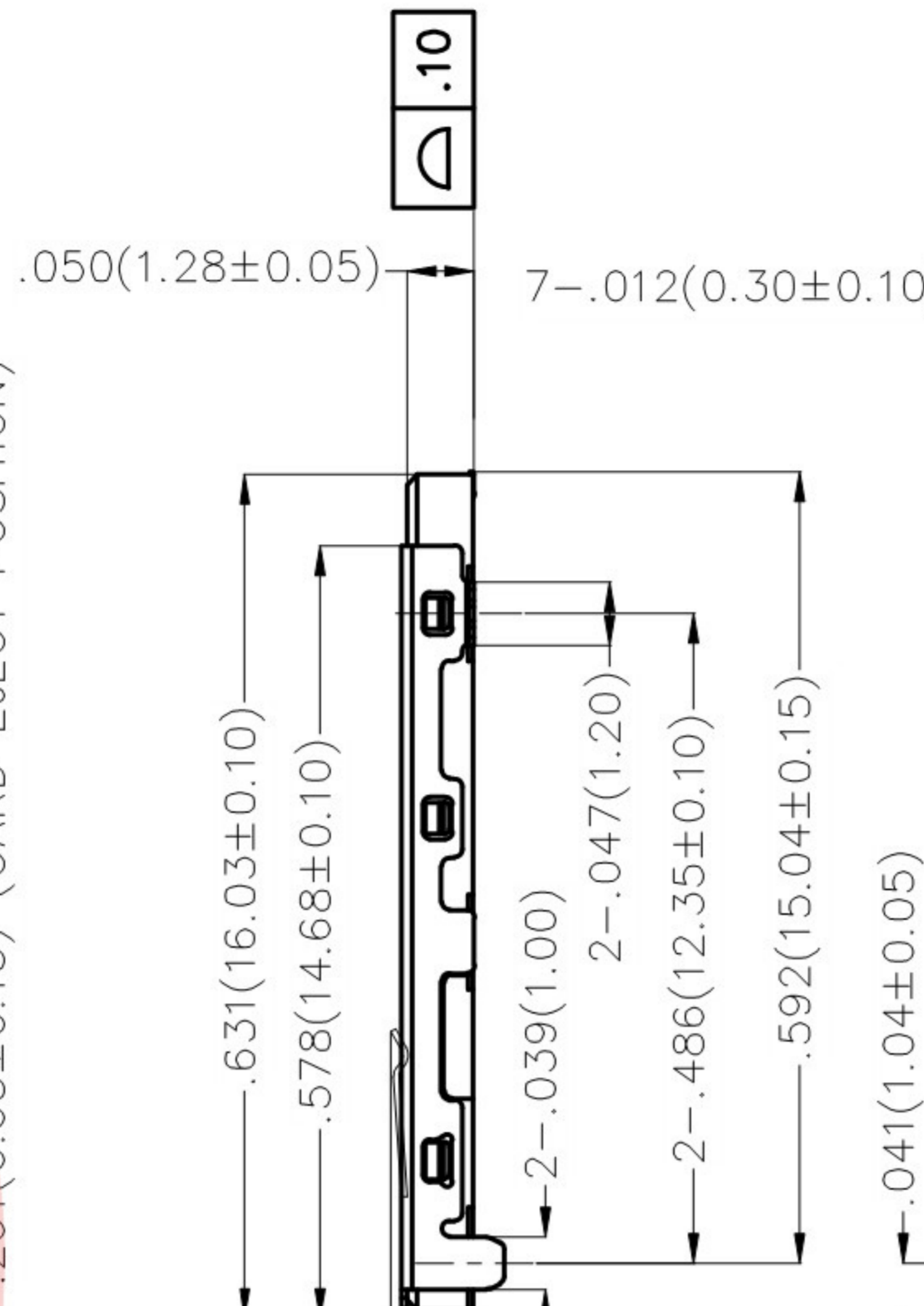
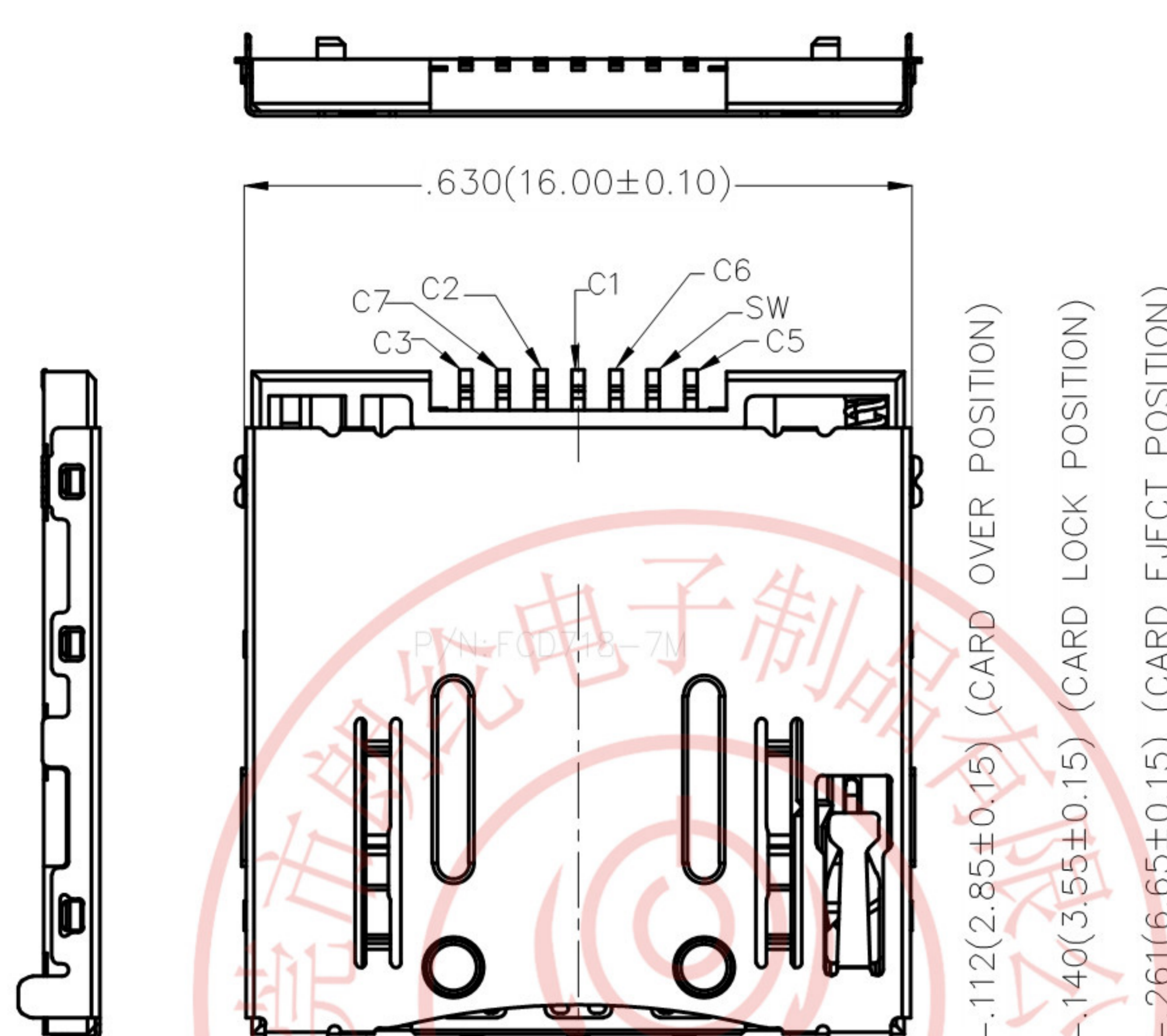

Electrical
 Current Rating: 0.5A AC(rms)/DC
 Voltage Rating: 30V AC(rms)/DC
 Contact Resistance: 50 mΩ Max
 Insulation Resistance: 100 MΩ MIN
 Withstanding Voltage: 500V AC r.m.s
 Temperature Range-Operating: -30°C~+85°C

Material and Plating
 Housing: LCP Black Color
 Shell: SUS304 Nickel Plating
 Contact Pin: Phosphor Bronze
 Plating: Selective gold in contact area, Tin on tail.

Recommended P.C.Board Layout
 General tolerances: ±.002(0.05)

- PAD AREA
- NO TRACE, NO TEST POINT, NO VIA HOLE, NO GROUND AREA
- PATTERNS ONLY FOR GND

Connector Pin Assignment

No.	Pin Name	Description
①	C1	Vcc of SIM
②	C2	RST of SIM
③	C3	CLK of SIM
④	C5	GND of SIM
⑤	C6	Vpp of SIM
⑥	C7	I/O of SIM
⑦	SW	Detection Switch (Normal Open)



 THIRD ANGLE PROJECTION DESIGN UNITS Inch (metric) SCALE 5:1 SIZE A4	GENERAL TOLERANCES (UNLESS SPECIFIED)		APPROVE BY FRANK	DATE 12/JUL/19	PART NO. FCD908-7M	ITEM NO. FCD908	 3K-KAMING REV 0 SHEET NO. 1/2
	X.±.012(0.30)	X'.±5'	CHECKED BY CHERRY	DATE 12/JUL/19	TITLE Nano SIM Push H1.38 With Tray		
	X.X±.008(0.20)	.X'±2'	DRAWN BY ZOEY	DATE 12/JUL/19	THIS DRAWING CONTAINS INFORMATION THAT IS PROPRIETARY TO DONG GUAN LANG LUN(3K-KAMING) ELECTRONIC PRODUCTS CO.,LTD. AND SHOULD NOT BE USED WITHOUT WRITTEN PERMISSION		
	X.XX±.006(0.15)	.XX'±1'					
	X.XXX±.004(0.10)	.XXX'±0.5'					

REV	LOCATIONS	DESCRIPTION	DATE	REVISER	APPD

Note:

- 10 sprocket hole cumulative tolerance ± 0.2
- Carrier camber is within 1.0mm in 100mm
- Material: White Conductive polystyrene Alloy 100% recyclable
- All dimensions meet EIA-481-3 requirements
- Component load per 13" reel: 1000pcs

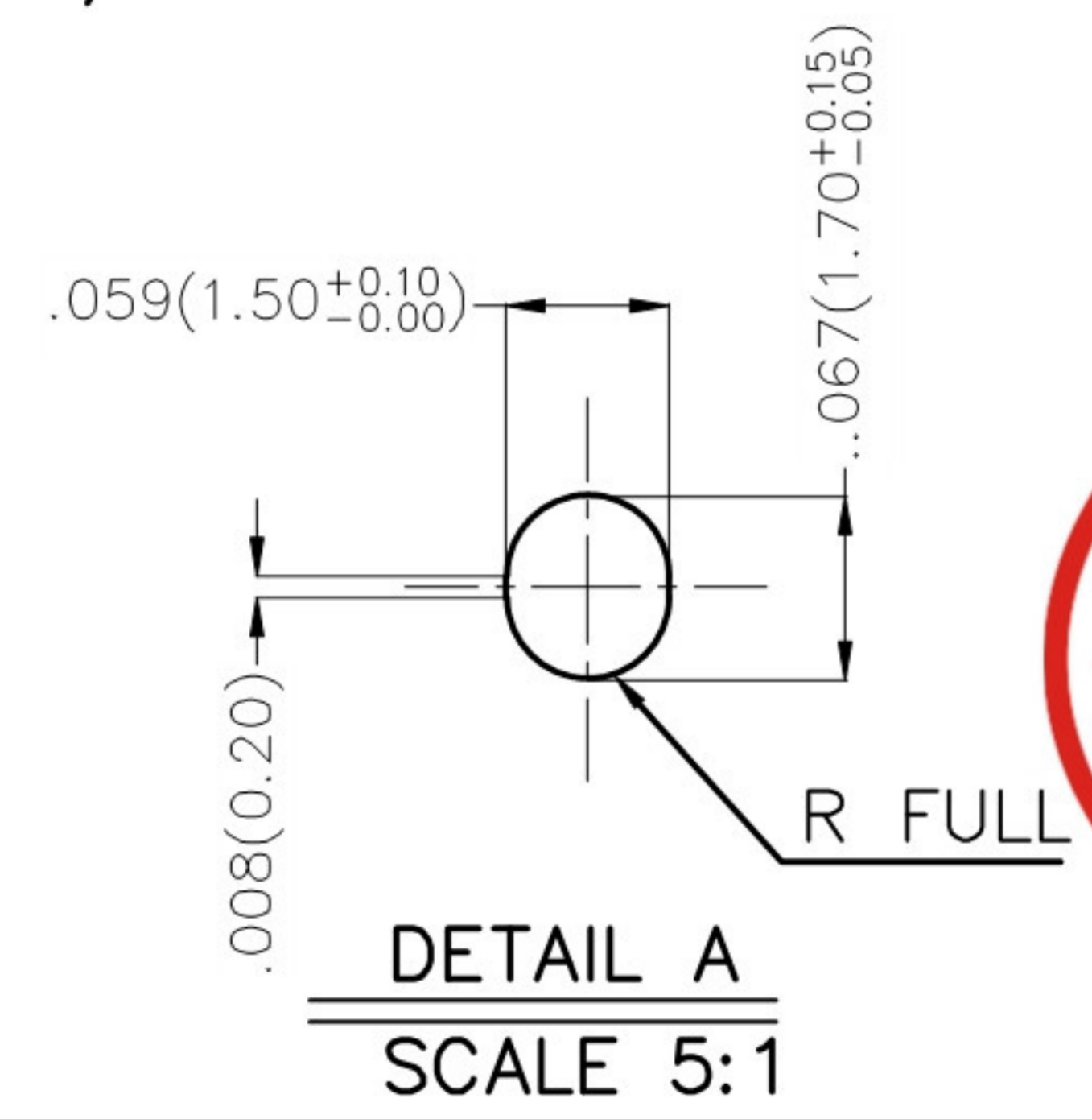
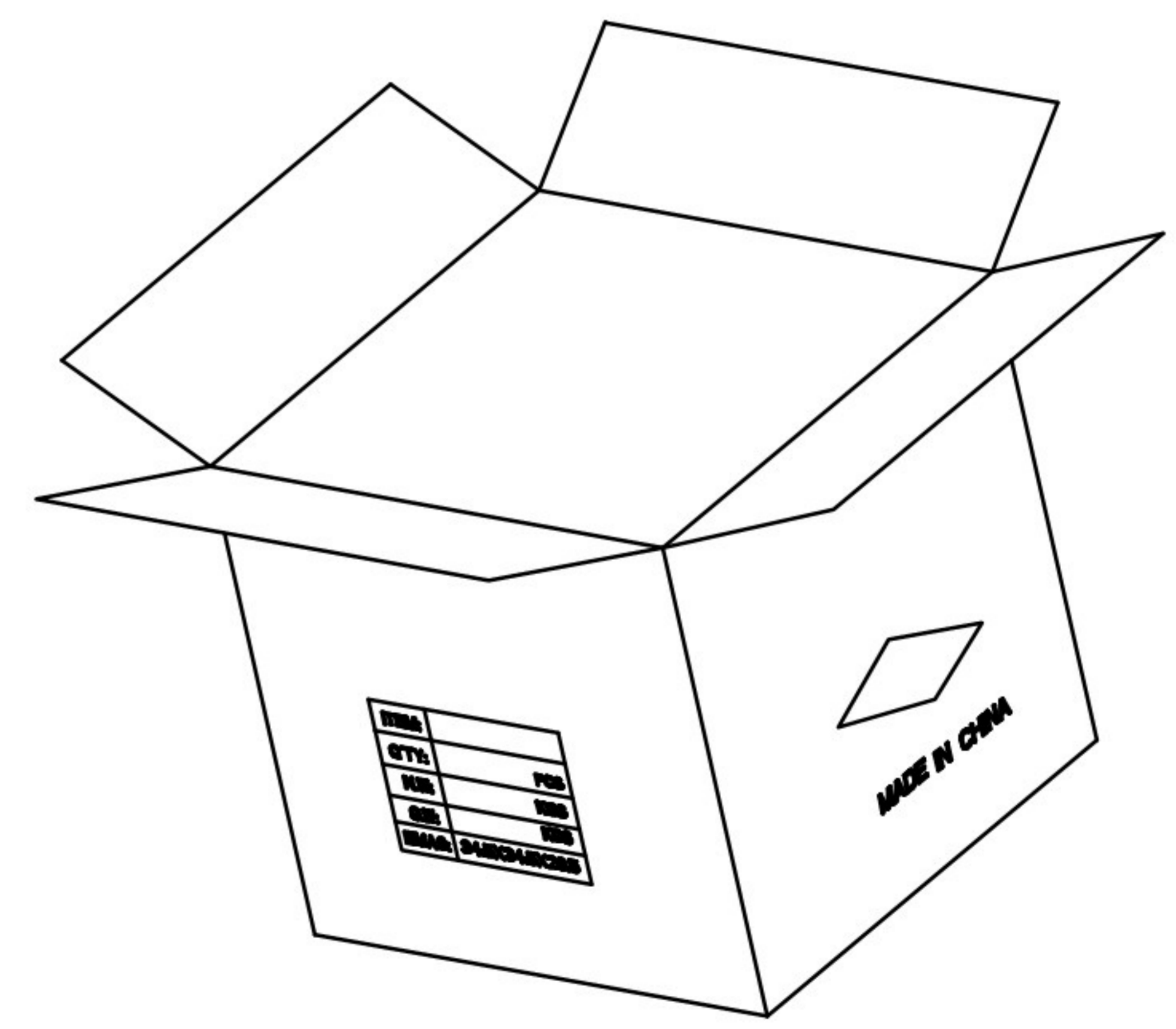
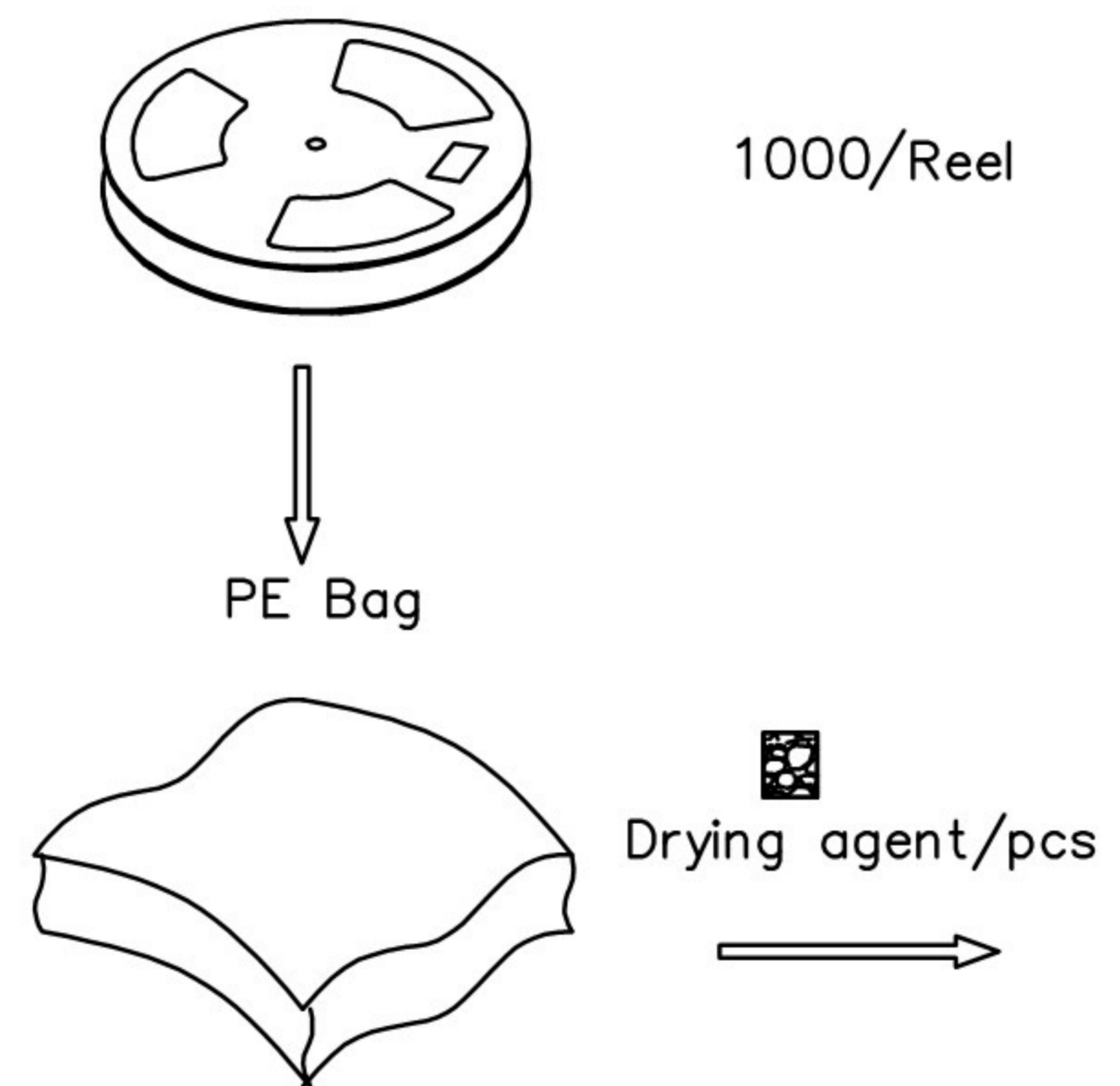
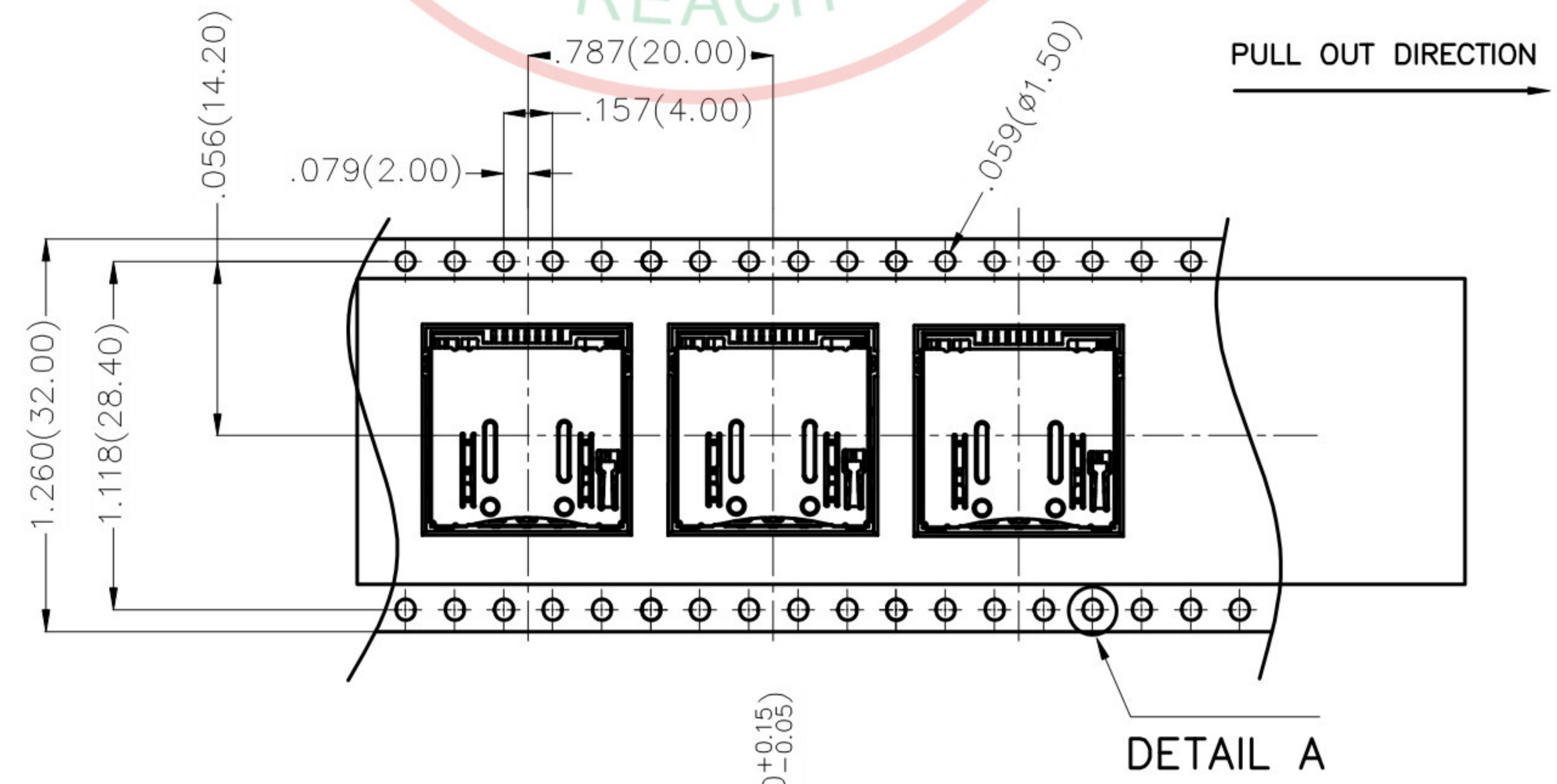
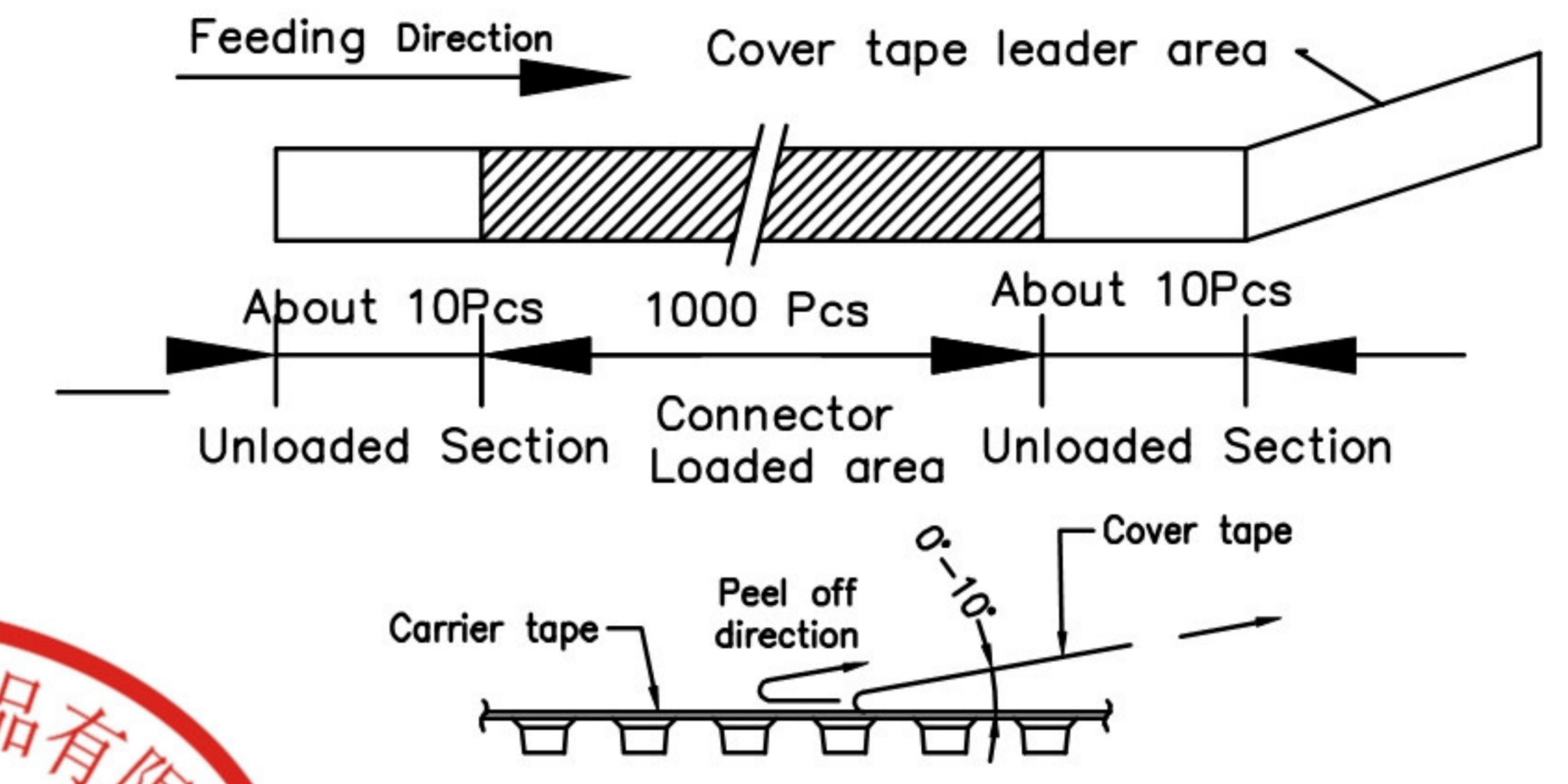
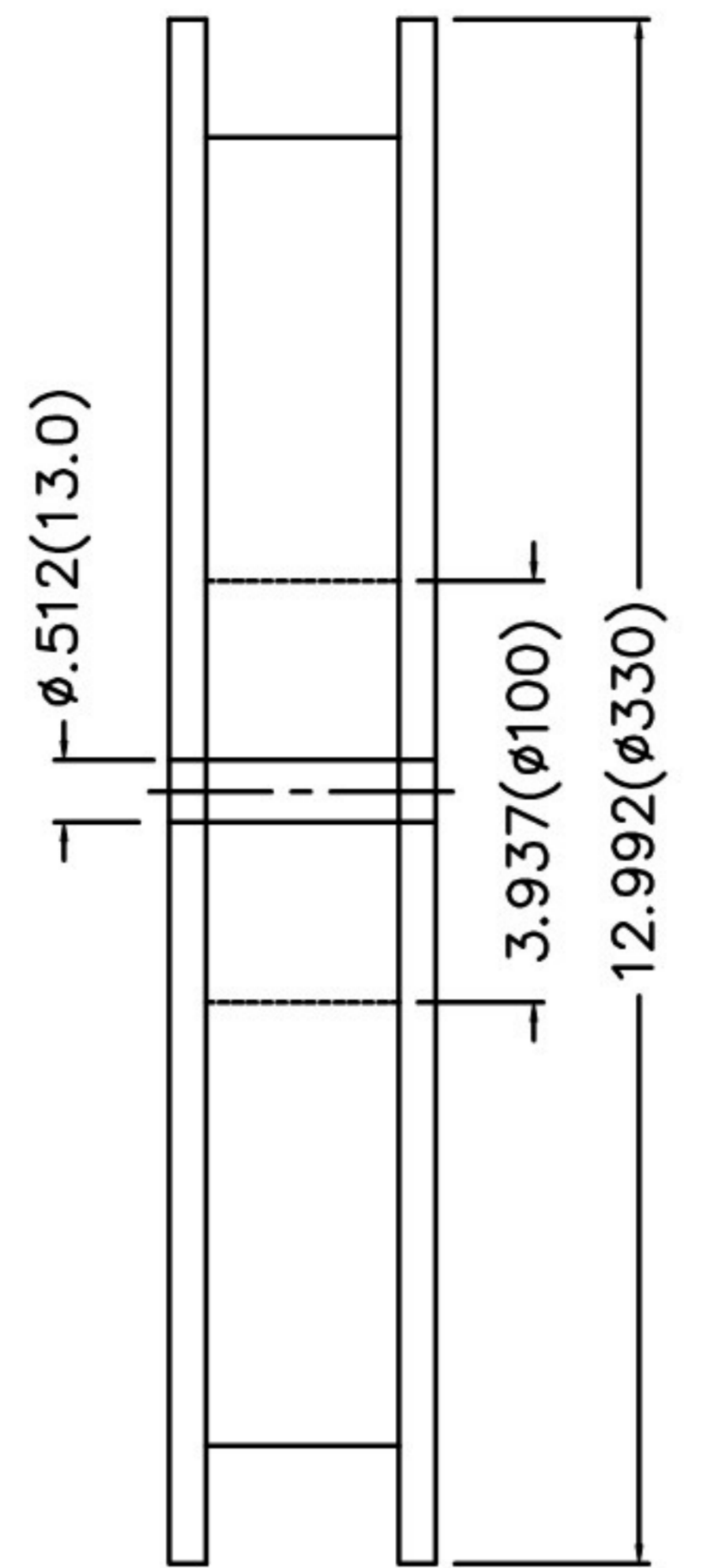
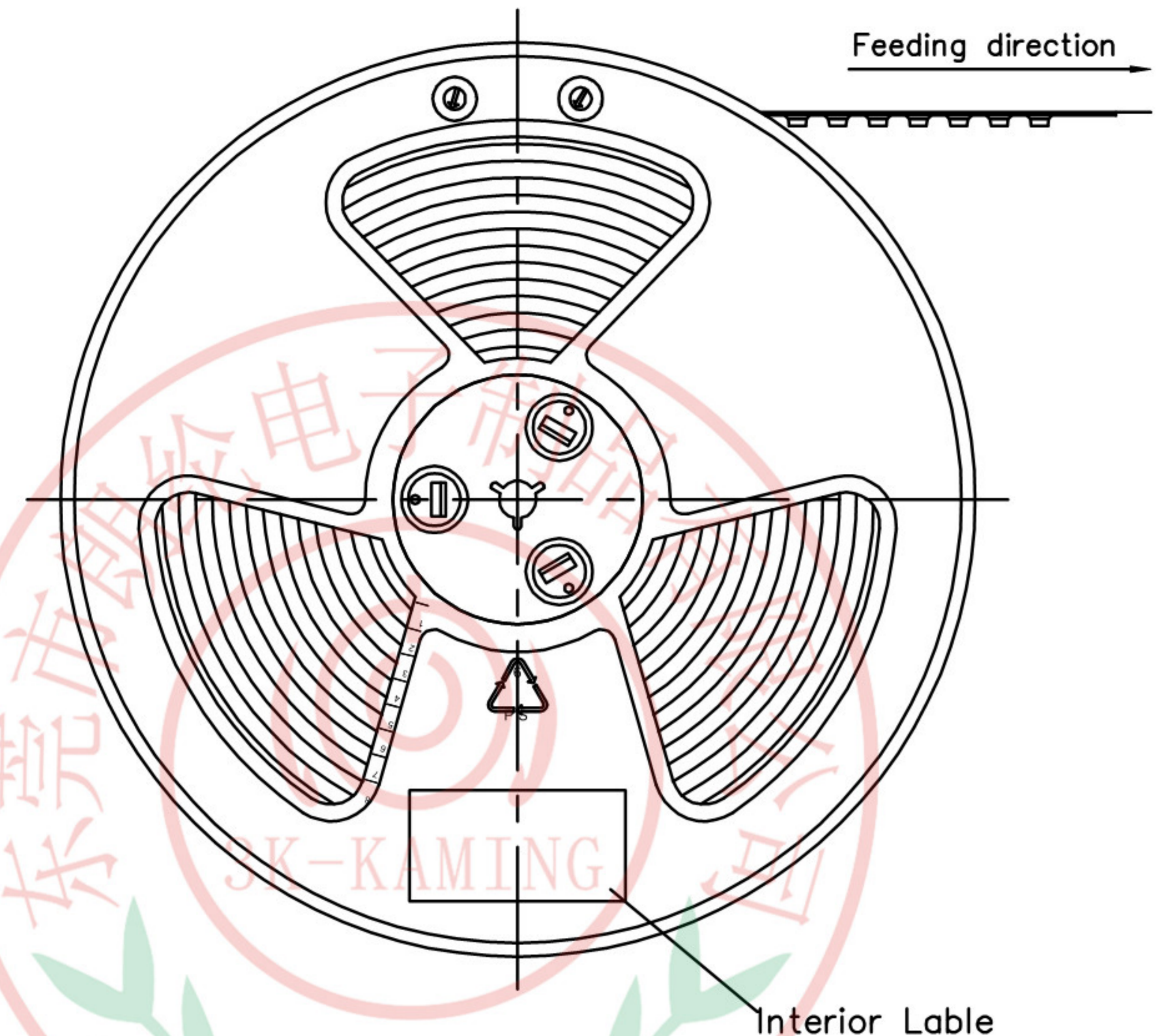

<p>THIRD ANGLE PROJECTION</p>	GENERAL TOLERANCES (UNLESS SPECIFIED)		APPROVE BY	DATE	PART NO.	ITEM NO.	<p>3K-KAMING</p>
	X. \pm .012(0.30)	X. \pm 5'	FRANK	11/JUL/19	FCD908-7M	FCD908	
DESIGN UNITS Inch (metric)	X.X \pm .008(0.20)	.X' \pm 2'	CHECKED BY	DATE	TITLE		<p>REV 0</p> <p>SHEET NO. 2/2</p>
SCALE 5:1	X.XX \pm .006(0.15)	.XX' \pm 1'	CHERRY	11/JUL/19	Nano SIM Push H1.38 With Tray		
SIZE A4	X.XXX \pm .004(0.10)	.XXX' \pm 0.5'	DRAWN BY	DATE	THIS DRAWING CONTAINS INFORMATION THAT IS PROPRIETARY TO DONG GUAN LANG LUN(3K-KAMING) ELECTRONIC PRODUCTS CO.,LTD. AND SHOULD NOT BE USED WITHOUT WRITTEN PERMISSION		
			ZOEY	11/JUL/19			