

1 2 3 4 5 6 7 8

REV	LOCATIONS	DESCRIPTION	DATE	REVISER	APPD

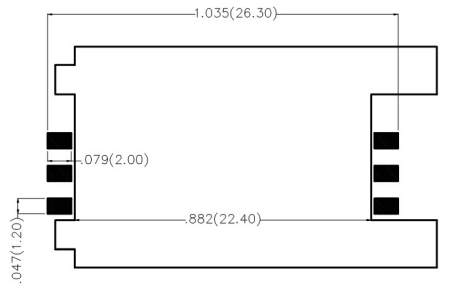

**Electrical**  
 Current Rating: 1A AC(rms)/DC  
 Voltage Rating: 250V AC(rms)/DC  
 Contact Resistance: 40 mΩ Max  
 Insulation Resistance: 100 MΩ MIN  
 Withstanding Voltage: 500V AC r.m.s  
 Temperature Range-Operating: -25°C~+80°C  
**Material and Plating**  
 Housing: High Temperature Plastic( UL 94V-0)  
 Contact Pin: Phosphor Bronze  
 Plating: Gold Plated/Tin Plated  
 Durability: 10,000 Times

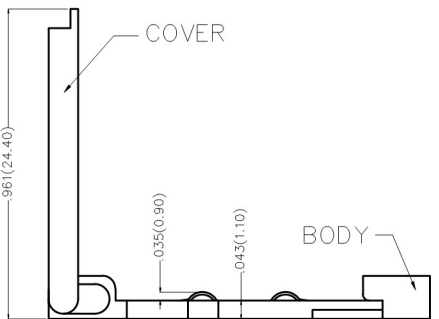
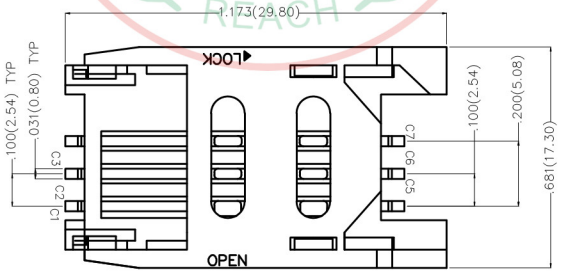
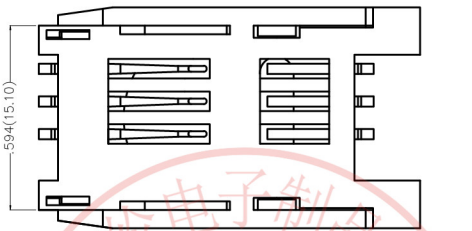

Recommended P.C.Board Layout

PIN NO.	PIN NAME
C1	Supply Voltage Vcc
C2	Rest(RST)
C3	Clock (CLK)
C4	
C5	Ground
C6	Programming Voltage Vpp
C7	I/O
C8	

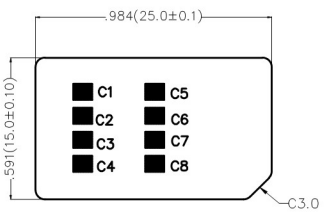

Reference Sim Card



 THIRD ANGLE PROJECTION	GENERAL TOLERANCES (UNLESS SPECIFIED)		APPROVE BY	DATE	PART NO.	ITEM NO.	 3K-KAMING
	X.±.012(0.30)	X.±5'	FRANK	28/JUN/13	FCD507-8M	FCD507	
	DESIGN UNITS Inch (metric)	X.X±.008(0.20) .X'±2'	CHECKED BY	DATE	TITLE		REV 0 SHEET NO. 1/1
	SCALE	X.XX±.006(0.15) .XX±1'	JACOB	28/JUN/13	SIM card connector(H: 2.5mm)		
SIZE	X.XXX±.004(0.10) .XXX±0.5'	DRAWN BY	DATE	THIS DRAWING CONTAINS INFORMATION THAT IS PROPRIETARY TO DONG GUAN LANG LUN(3K-KAMING) ELECTRONIC PRODUCTS CO.,LTD. AND SHOULD NOT BE USED WITHOUT WRITTEN PERMISSION			
5:1	A4	CHERRY	28/JUN/13				

1 2 3 4 5 6 7 8