

REV	LOCATIONS	DESCRIPTION	DATE	REVISER	APPD
1	△	Update version	13/DEC/18	KATE	ANDY



SPECIFICATIONS

Electrical
 Current Rating: 2.0A AC(rms)/DC
 Voltage Rating: 250V AC(rms)/DC
 Contact Resistance: 20 mΩ Max
 Insulation Resistance: 1000 MΩ Min
 Withstanding Voltage: 500V AC r.m.s
 Temperature Range-Operating: -40°C~+105°C

Material and Plating
 Housing: Glass Filled Polyester (UL94V-0)
 Contact Pin: Brass
 Plating: Gold Plated

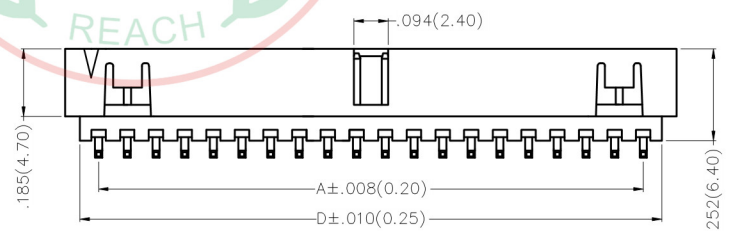
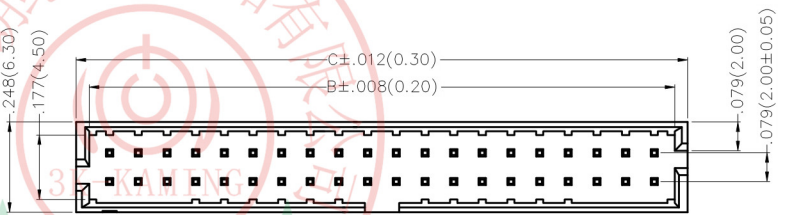
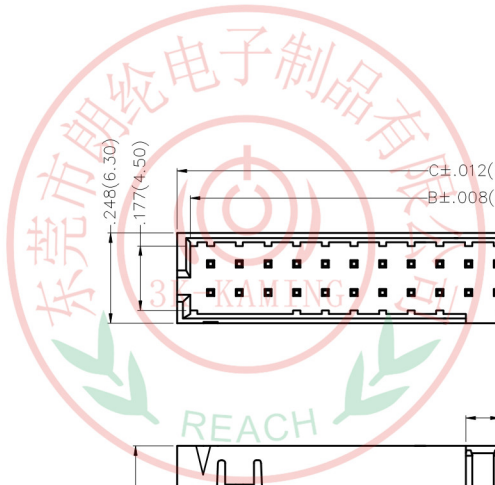

No.16~50 Circuits

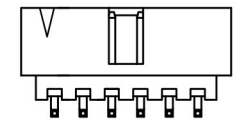
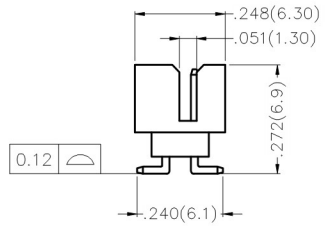

No.6~14 Circuits

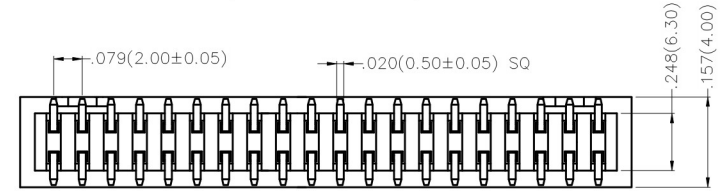

Ordering Information

FBH 200 15 - D XX S 1 XX 4 K6 K
 1 2 3 4 5 6 7 8 9 10 11

1 Category FBH-Box Header	2 Series Number 200-Pitch2.00mm	3 Distinction No. 15	4 Row Option D-Double Row	5 Circuits XX	6 Entry Angle S-Vertical
7 Plating 1-Gold Plated	8 Thickness of Plating 00-Gold Flash 03-3μ" Custom plate available	9 Material-Resin 4-PA9T	10 Color-Resin K6-Black	11 Packaging K-Tray	

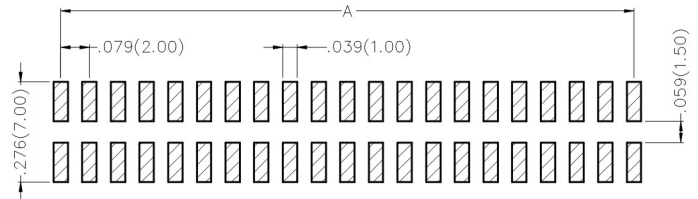

Recommended P.C.Board Layout

 THIRD ANGLE PROJECTION	GENERAL TOLERANCES (UNLESS SPECIFIED)		APPROVE BY FRANK	DATE 19/JUL/13	PART NO. FBH20015-DXXS1XX4K6K	ITEM NO. FBH20015	 3K-KAMING
	X.±.012(0.30)	X.±5'	CHECKED BY CHERRY	DATE 19/JUL/13	TITLE Wire to Board(Box Header) Pitch 2.00mm Vertical 180°(SMT)		
DESIGN UNITS Inch (metric)	X.X±.008(0.20)	X.±2'	DRAWN BY KATE	DATE 19/JUL/13	REV 1 SHEET NO. 1/2		
SCALE 5:1	SIZE A4	X.XX±.006(0.15)	THIS DRAWING CONTAINS INFORMATION THAT IS PROPRIETARY TO DONG GUAN LANG LUN(3K-KAMING) ELECTRONIC PRODUCTS CO.,LTD. AND SHOULD NOT BE USED WITHOUT WRITTEN PERMISSION				

REV	LOCATIONS	DESCRIPTION	DATE	REVISER	APPD
1	△	Update version	13/DEC/18	KATE	ANDY



SPECIFICATIONS

Electrical
 Current Rating: 2.0A AC(rms)/DC
 Voltage Rating: 250V AC(rms)/DC
 Contact Resistance: 20 mΩ Max
 Insulation Resistance: 1000 MΩ Min
 Withstanding Voltage: 500V AC r.m.s
 Temperature Range-Operating: -40°C~+105°C

Material and Plating
 Housing: Glass Filled Polyester (UL94V-0)
 Contact Pin: Brass
 Plating: Gold Plated

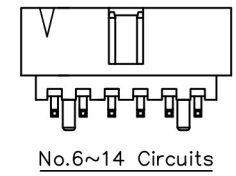
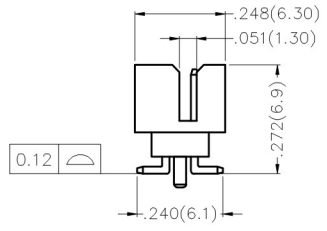
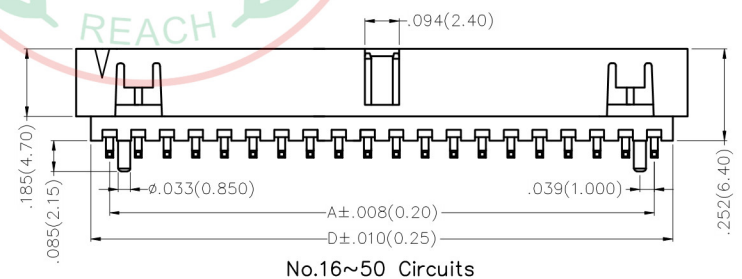
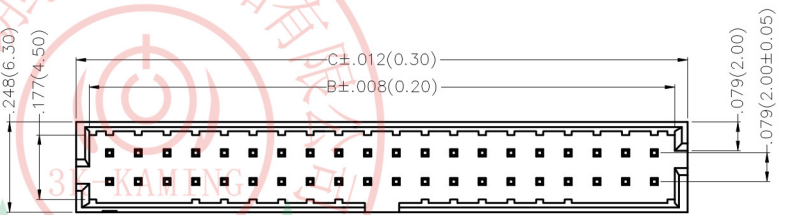
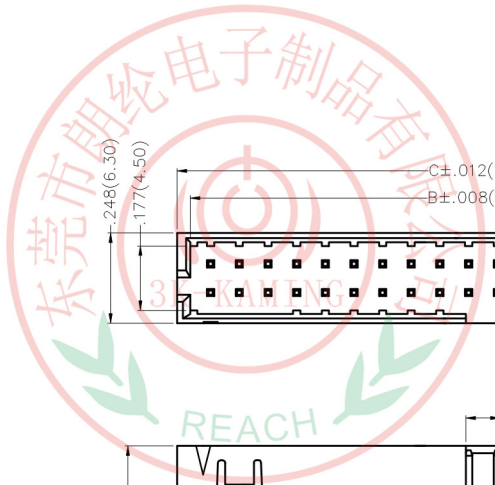

Ordering Information

FBH 200 15 - D XX S 1 XX 4 K6 K A
 1 2 3 4 5 6 7 8 9 10 11 12

1 Category FBH-Box Header	2 Series Number 200-Pitch2.00mm	3 Distinction No. 15	4 Row Option D-Double Row	5 Circuits XX	6 Entry Angle S-Vertical
7 Plating 1-Gold Plated	8 Thickness of Plating 00-Gold Flash 03-3μ" Custom plate available	9 Material-Resin 4-PA9T	10 Color-Resin K6-Black	11 Packaging K-Tray	12 Type A-With position

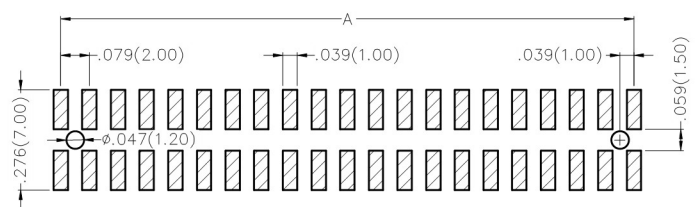
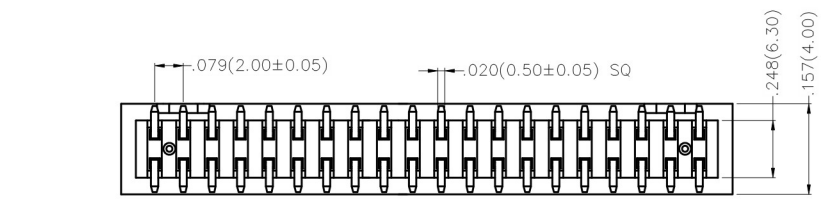

THIRD ANGLE PROJECTION	GENERAL TOLERANCES (UNLESS SPECIFIED)		APPROVE BY FRANK	DATE 19/JUL/13	PART NO. FBH20015-DXXS1XX4K6KA	ITEM NO. FBH20015	
	X.±.012(0.30)	X.±5'	CHECKED BY CHERRY	DATE 19/JUL/13	TITLE Wire to Board(Box Header) Pitch 2.00mm Vertical 180°(SMT)		
DESIGN UNITS Inch (metric)	X.X±.008(0.20)	X.±2'	DRAWN BY KATE	DATE 19/JUL/13	THIS DRAWING CONTAINS INFORMATION THAT IS PROPRIETARY TO DONG GUAN LANG LUN(3K-KAMING) ELECTRONIC PRODUCTS CO., LTD. AND SHOULD NOT BE USED WITHOUT WRITTEN PERMISSION		
SCALE 5:1	SIZE A4	X.XX±.006(0.15)					
		X.XXX±.004(0.10)					