

REV	LOCATIONS	DESCRIPTION	DATE	REVISER	APPD

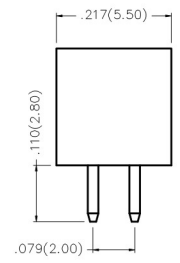

Electrical
 Current Rating 2.0A AC(rms)/DC
 Voltage Rating: 250V AC(rms)/DC
 Contact Resistance: 20 mΩ Max
 Insulation Resistance: 1000 MΩ MIN
 Withstanding Voltage: 500V AC r.m.s
 Temperature Range—Operating: -40°C~+105°C
 Material and Plating
 Housing: Polyester (UL94V-0)
 Contact Pin: Brass
 Plating: Gold Plated/Selective gold in contact area, tin on tail

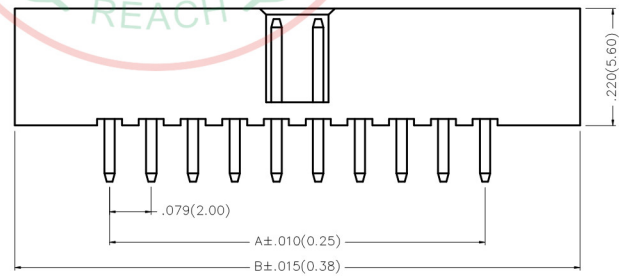
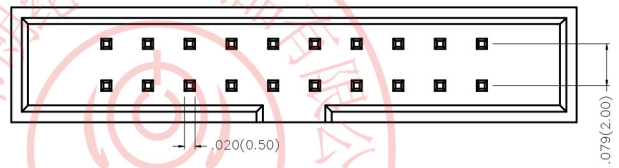

Ordering Information

FBH 200 01 — D XX S X XX X K6 K
 1 2 3 4 5 6 7 8 9 10 11

- | | | | | | | | | | | | |
|---|---|---|---|---|---|----|----------------------------|----|---------------------|---|--------------------------------|
| 1 | Category
FBH—Box Header | 2 | Series Number
200—Pitch 2.00mm | 3 | Distinction No.
01 | 4 | Row Option
D—Double Row | 5 | Circuits
XX | 6 | Entry Angle
S—180° Vertical |
| 7 | Plating
1—Gold Plated
3—Selective gold in contact area, tin on tail | 8 | Thickness of Plating
00—Gold Flash
05—5μ"
Custom plate available | 9 | Material—Resin
4—PA6T
5—PA9T
1—PBT | 10 | Color—Resin
K6—Black | 11 | Packaging
K—Tray | | |

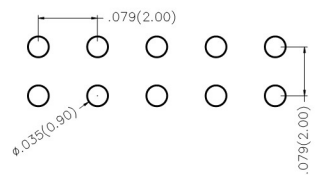

Recommended P.C.Board Layout

Circuits (n)	Part No.	Dimensions(in/mm)		Circuits (n)	Part No.	Dimensions(in/mm)	
		A	B			A	B
6	FBH20001—D06SXXXXK6K	.157(4.00)	.516(13.10)	26	FBH20001—D26SXXXXK6K	.944(24.00)	1.303(33.10)
8	FBH20001—D08SXXXXK6K	.236(6.00)	.594(15.10)	30	FBH20001—D30SXXXXK6K	1.102(28.00)	1.461(37.10)
10	FBH20001—D10SXXXXK6K	.315(8.00)	.673(17.10)	34	FBH20001—D34SXXXXK6K	1.260(32.00)	1.618(41.10)
12	FBH20001—D12SXXXXK6K	.394(10.00)	.752(19.10)	40	FBH20001—D40SXXXXK6K	1.496(38.00)	1.854(47.10)
14	FBH20001—D14SXXXXK6K	.472(12.00)	.831(21.10)	44	FBH20001—D44SXXXXK6K	1.654(42.00)	2.012(51.10)
16	FBH20001—D16SXXXXK6K	.551(14.00)	.909(23.10)	50	FBH20001—D50SXXXXK6K	1.890(48.00)	2.248(57.10)
20	FBH20001—D20SXXXXK6K	.709(18.00)	1.067(27.10)	60	FBH20001—D60SXXXXK6K	2.283(58.00)	2.642(67.10)
24	FBH20001—D24SXXXXK6K	.866(22.00)	1.146(29.10)				

THIRD ANGLE PROJECTION	GENERAL TOLERANCES (UNLESS SPECIFIED)		APPROVE BY FRANK	DATE 19/JUL/13	PART NO. FBH20001—DXXSXXXXK6K	ITEM NO. FBH20001	
	DESIGN UNITS Inch (metric)	X.±.012(0.30) X.X±.008(0.20)	X.±5' .X'±2'	CHECKED BY CHERRY	DATE 19/JUL/13	TITLE Wire to Board(Box Header) Pitch 2.00mm Vertical 180°(DIP)	
SCALE 5:1	SIZE A4	X.XX±.006(0.15) X.XXX±.004(0.10)	.XX'±1' .XXX'±0.5'	DRAWN BY JACOB	DATE 19/JUL/13	THIS DRAWING CONTAINS INFORMATION THAT IS PROPRIETARY TO DONG GUAN LANG LUN(3K-KAMING) ELECTRONIC PRODUCTS CO., LTD. AND SHOULD NOT BE USED WITHOUT WRITTEN PERMISSION	