

REV	LOCATIONS	DESCRIPTION	DATE	REVISED	APPD

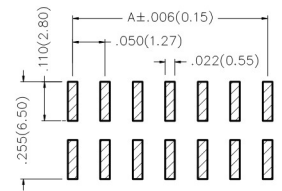

Electrical
 Current Rating: 1.0A AC(rms)/DC
 Voltage Rating: 250V AC(rms)/DC
 Contact Resistance: 20 mΩ Max
 Insulation Resistance: 500 MΩ MIN
 Withstanding Voltage: 100V AC r.m.s
 Temperature Range—Operating: -25°C~+85°C
 Material and Plating
 Housing: Polyester (UL94V-0)
 Contact Pin: Brass
 Plating: Gold Plated

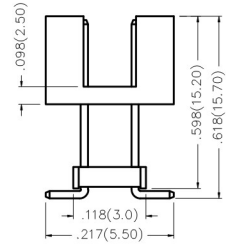
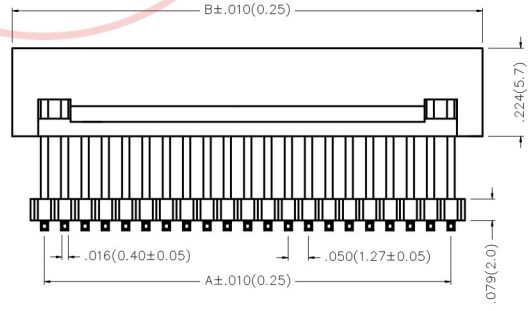
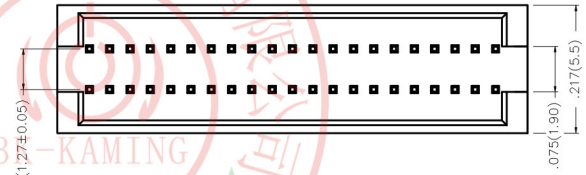

Recommended P.C.Board Layout



Ordering Information

FBH 127 08 — D XX S 1 XX X K6 K
 1 2 3 4 5 6 7 8 9 10 11

1 Category FBH—Box Header	2 Series Number 127—Pitch1.27mm	3 Distinction No. 08	4 Row Option D—Double Row	5 Circuits XX	
6 Entry Angle S—180° Vertical	7 Plating 1—Gold Plated	8 Thickness of Plating 00—Gold Flash 05—5μ"	9 Material—Resin 3—LCP 4—PA9T	10 Color—Resin K6—Black	11 Packaging K—Tray

Custom plate available

 THIRD ANGLE PROJECTION	GENERAL TOLERANCES (UNLESS SPECIFIED)		APPROVE BY FRANK	DATE 19/JUL/13	PART NO. FBH12708-DXXS1XXXK6K	ITEM NO. FBH12708	 3K-KAMING
	DESIGN UNITS Inch (metric)	X.±.012(0.30) X.X±.008(0.20)	X.±5° .X'±2'	CHECKED BY CHERRY	DATE 19/JUL/13	TITLE Wire to Board(Box Header) Pitch 1.27mm 180° Vertical(SMT)	
SCALE 5:1	SIZE A4	X.XX±.006(0.15) X.XXX±.004(0.10)	.XX'±1° .XXX'±0.5°	DRAWN BY JACOB	DATE 19/JUL/13	THIS DRAWING CONTAINS INFORMATION THAT IS PROPRIETARY TO DONG GUAN LANG LUN(3K-KAMING) ELECTRONIC PRODUCTS CO.,LTD. AND SHOULD NOT BE USED WITHOUT WRITTEN PERMISSION	